



42 Kirkhill Terrace, Broxburn

Offers Over £114,500



42 Kirkhill Terrace

Broxburn, Broxburn

Immaculate 1-bed ground floor flat with modern interior and tranquil outdoor spaces. Features spacious lounge, double bedroom with walk-in wardrobe, modern kitchen, and contemporary bathroom. South-facing front garden and private rear garden with chipping stones, paving slabs, and 2 brick sheds for storage. Ample on-street parking. Ideal for indoor-outdoor living.

Tenure: Freehold

- Spacious One Bedroom Ground Floor Flat
- South Facing Front Garden and fully enclosed private rear garden
- Well proportioned Lounge
- Double Bedroom with walk-in wardrobe storage
- Modern Kitchen with fitted appliances
- Contemporary modern Bathroom
- Ample on-street parking



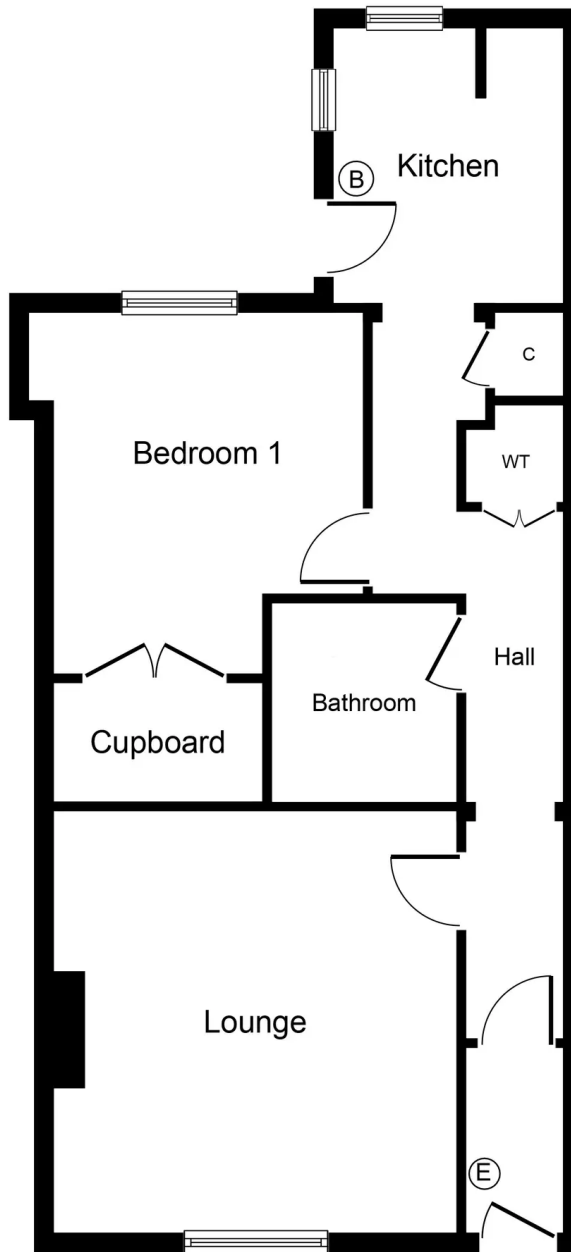

Approximate Floor Area
615 sq. ft.
(57.2 sq. m.)

Whilst every attempt has been made to ensure the accuracy of the floor plan contained here, measurements of doors, windows, rooms and any other items are approximate and no responsibility is taken for any error, omission, or mis-statement. The measurements should not be relied upon for valuation, transaction and/or funding purposes. This plan is for illustrative purposes only and should be used as such by any prospective purchaser or tenant. The services, systems and appliances shown have not been tested and no guarantee as to their operability or efficiency can be given.
Copyright V360 Ltd 2024 | www.houseviz.com



KnightBain Estate Agents

Knightbain, 4 Greendykes Road, Broxburn - EH52 5AG

01506 852000

info@knightbain.co.uk

www.knightbain.co.uk/

