



8 St Judes Road | St Judes | Plymouth | PL4 9HT

Guide £180,000-£200,000

A Victorian Town House situated within St Judes.

This spacious period property offers a great deal of flexibility and potential.

The property has over the years been used as two flats, however could easily be a large family or even an investment property, suitable of housing multiple occupants.

Outside is a rear courtyard garden as well as a large roof terrace offering far reaching views, Beaumont and Astor Parks are within close proximity.

The City Centre, University and Barbican are within walking distance.

- Victorian Town House
- Three Double Bedrooms
- Spacious Accommodation
- Upvc Double Glazing
- Walking Distance To City
- Walking Distance To University
- Close To Local Facilities



GROUND FLOOR
742 sq.ft. (68.9 sq.m.) approx.



1ST FLOOR
726 sq.ft. (67.3 sq.m.) approx.



2ND FLOOR
79 sq.ft. (7.4 sq.m.) approx.

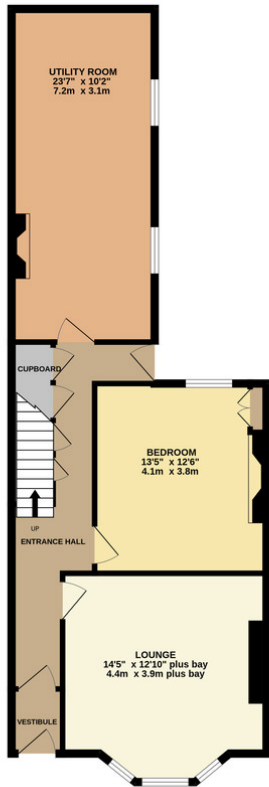

TOTAL FLOOR AREA : 1548 sq.ft. (143.8 sq.m.) approx.

Contact Details

48 Ebrington Street
Plymouth
Devon
PL4 9AD

www.athomelettings.com
info@athomeproperty.co.uk
01752 777070

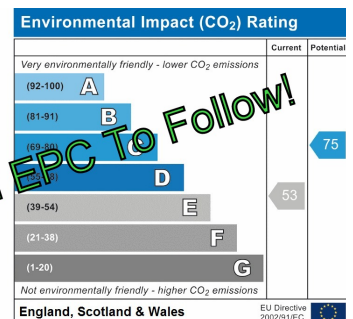
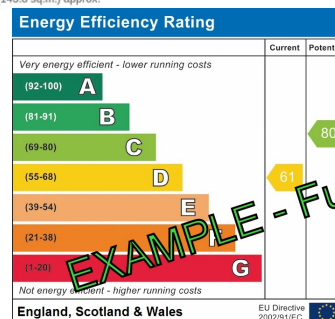

EXAMPLE - Full EPC To Follow!

Agents Note: Whilst every care has been taken to prepare these sales particulars, they are for guidance purposes only. All measurements are approximate and are for general guidance purposes only and whilst every care has been taken to ensure their accuracy, they should not be relied upon and potential buyers are advised to recheck the measurements