

These spacious and unique three-bedroom homes are split over three stories, with the ground floor in the middle. The main entrances are both on this level, with the integral single garage and front door both opening into the entrance hallway with its convenient WC and storage space.

Downstairs on the lower ground floor, we find another hallway leading off into a utility room and extra WC in one direction and the open plan kitchen-dining room in the other. Passing through the kitchen-diner, we find a comfortable conjoined living space that runs the length of the house and boasts double patio doors leading out to the rear garden.

Upstairs on the top floor, one double bedroom is adjacent to the well-appointed main house bathroom. Meanwhile, the master bedroom has both an ensuite and a wonderful balcony area. The additional double bedroom on the ground floor could also become a perfect space for working from home.

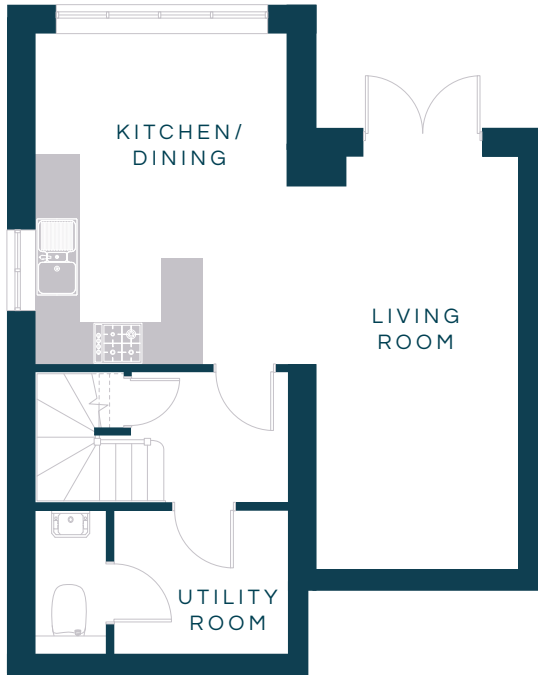



LOWER GROUND FLOOR

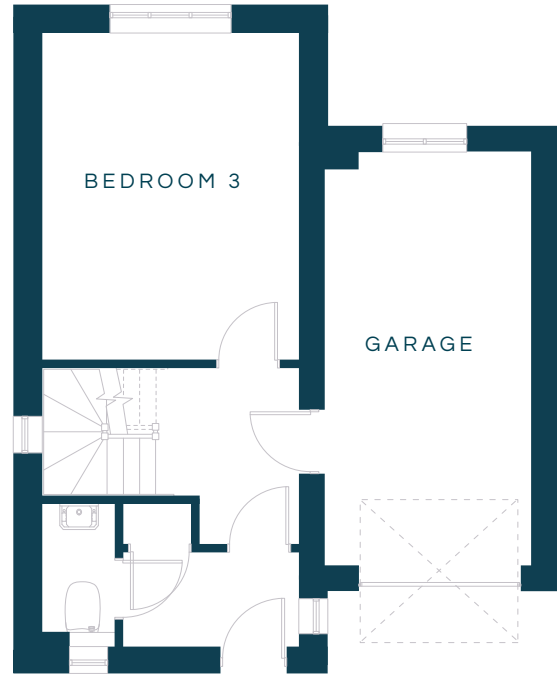

FIRST FLOOR

DIMENSIONS

Kitchen/Dining	3.67m x 4.80m / 12'0" x 15'7"
Living	2.96m x 6.03m / 9'7" x 19'7"
WC	1.04m x 1.83m / 3'4" x 6'0"
Utility	2.18m x 2.60m / 7'1" x 8'5"
Bedroom 3	3.73m x 4.86m / 12'2" x 15'9"
Garage	3.01m x 6.14m / 9'8" x 20'1"
WC	1.06m x 1.40m / 3'4" x 4'5"
Family Bathroom	3.73m x 2.14m / 12'2" x 7'0"
Bedroom 1	4.21m x 3.05m / 13'8" x 10'0"
Ensuite	2.72m x 1.59m / 8'9" x 5'2"
Bedroom 2	3.21m x 4.15m / 10'5" x 13'6"



SECOND FLOOR