

SITE SPECIFIC HAZARDS

IN ACCORDANCE WITH THE REQUIREMENTS OF THE COM REGULATIONS 2015 THE FOLLOWING SIGNIFICANT RESIDUAL HAZARDS HAVE NOT BEEN DESIGNED OUT OF THIS PROJECT AND MUST BE TAKEN INTO CONSIDERATION BY CONTRACTORS PLANNING TO UNDERTAKE THE WORKS SHOWN ON THIS DRAWING:

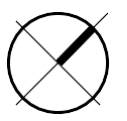

NOTE

DRAWING PRODUCED BASED ON AS BUILT RECORD INFORMATION POSITION OF EXISTING MECHANICAL SYSTEMS SUBJECT TO FURTHER ON SITE REVIEW AND INVESTIGATIVE SURVEY WORK

KITCHENETTE LAYOUT SHOWN INDICATIVELY

--- DENOTES PROPOSED PARTITION

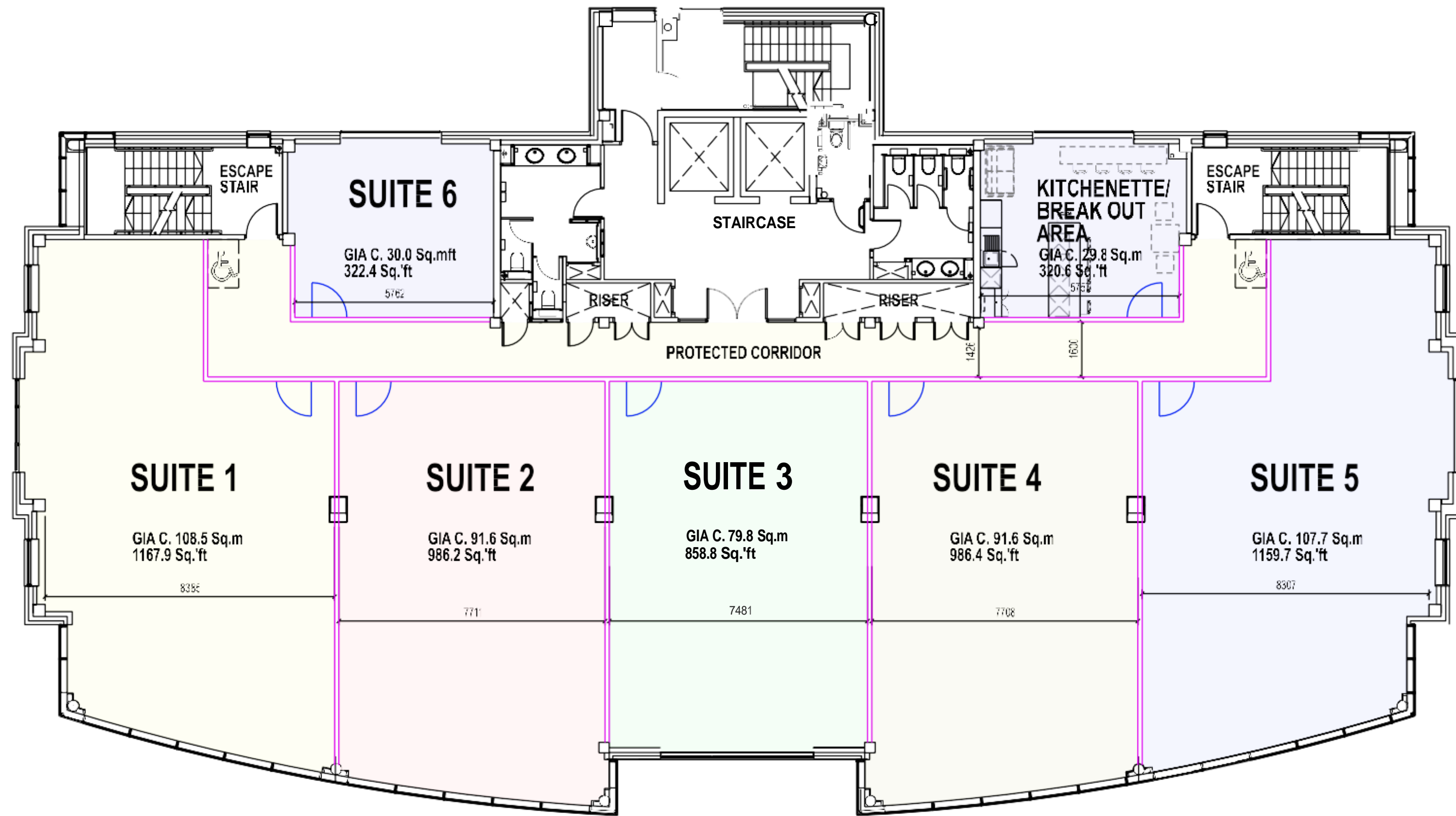

B	21/06/24	NORTH POINT & SCALE BAR ADDED ANNOTATION & TITLE UPDATED.	INIT.
A	18/06/24	UPDATED TO REFLECT CLIENT COMMENTS. DB	

CLIENT/ PROJECT
HURSTWOOD HOLDINGS
AQUEOUS 11, BIRMINGHAM

DRAWING TITLE
EXISTING THIRD FLOOR PLAN
PROPOSED SUBDIVISION
OPTION A

STATUS
FOR INFORMATION

DATE	DRAWN	SCALE @ A2
JUNE '24	DB	1:100

PROJECT NUMBER	UNIT/BLOCK	CH/FB CODE	TYPE & NUMBER	REVISION LETTER
11665			03	B

Site Location Plans	L	GA Plans	P	Elevations	E
Sections	S	Details	D	Prefix Colour	C

THE RATCLIFFE GROVES PARTNERSHIP

MANCHESTER
 105 MANCHESTER ROAD
 FURFAN CASHIFIELD BLVD
 www.rgp.uk.com

LONDON
 19 BEDFORD ROW
 LONDON WC1R 4EB
 T 020 7600 6666 E london@rgp.uk.com

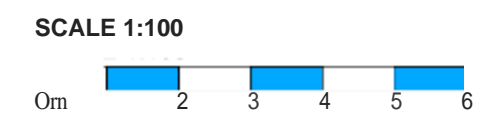

R:\001\11665\11665_11665_03_Proposed Third Floor Plan Option A.dwg
 AQUEOUS 11, BIRMINGHAM