



Oozells Building.

TailoredWorkspaces
BRINDLEYPLACE

Workspace shaped for you.

Tailored Workspaces at Brindleyplace provides three options for your workspace to ensure the perfect solution to your business needs.

The Oozells Building offers outstanding workspaces overlooking the impressive Oozells Square, which provides the perfect space to unwind and relax.

The modern working environment features a high-quality specification including large, open plan floorplates designed to cater for multiple layouts, provision for cycle storage and shower facilities and a fourth-floor roof terrace.

The Oozells building can be let in part or in its entirety, providing enough space to feature over 250 workstations in a range of configurations.

Oozells Building

Floor	Net sq ft	Workstations*
2nd - Part 1	9,275	Up to 105
2nd - Part 2	1,723	Up to 24
3rd - Whole	13,673	Up to 158
4th - Whole	11,387	Up to 132

*Approximate only, can be amended to suit client requirements.

Option

1

Conventional.

A traditional lease agreement which allows you to take the fit-out of your office into your own hands, while still benefiting from all of the advantages of being based at Brindleyplace.

Option

2

Fitted.

Our team will collaborate with you to provide a bespoke office fit-out including IT services, with the cost then spread over the duration of your lease agreement.

Option

3

Fully Fitted & Managed.

Our expert team can handle every part of your workspace operations for you, from creating and delivering your bespoke fit-out and IT services, to providing fully serviced space for the duration of your stay.

2ND FLOOR - PART 2 - 160 sq m / 1,723 sq ft

> 24 x total headcount

> 24 x workstations

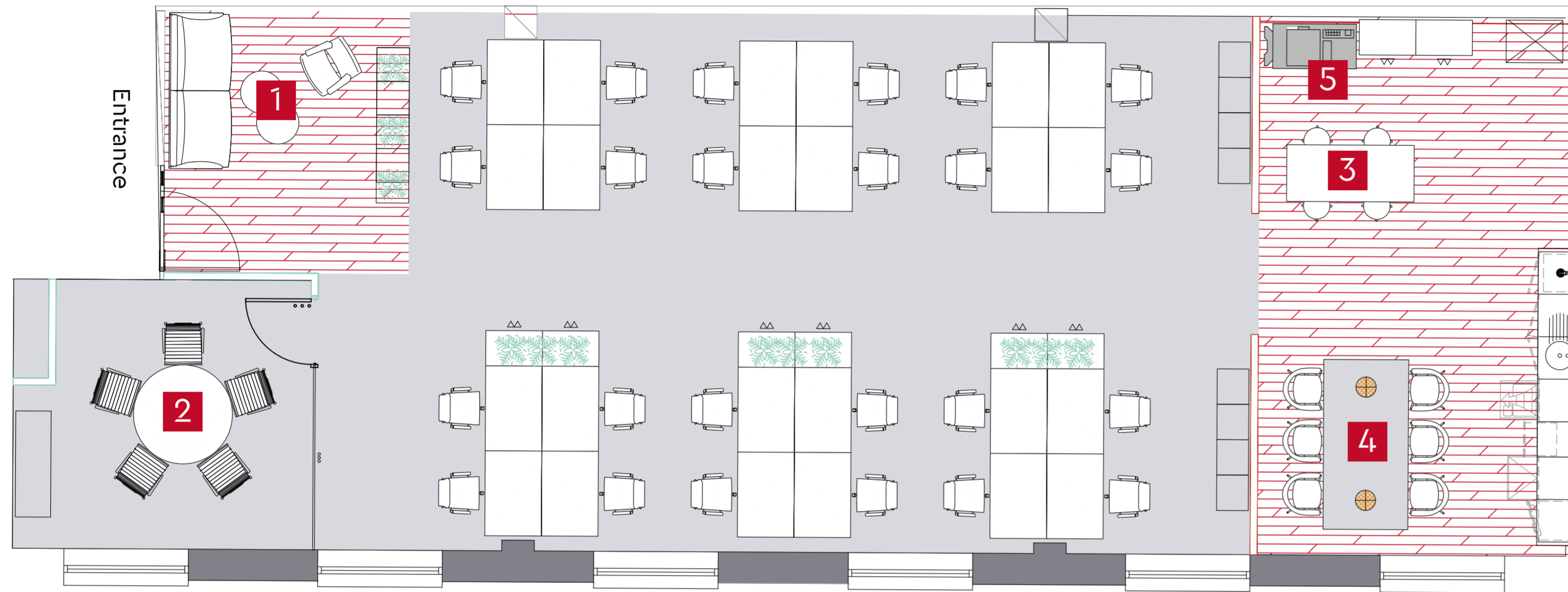

- 1 1 x 3 person waiting area
- 2 1 x 5 person meeting room
- 3 1 x 4 person hot bench
- 4 1 x 6 person teapoint/breakout
- 5 1 x print point





Tailored Workspaces



**George
Jennings**

07900 678 125



**Jonathan
Ottewell**

07972 000 150



**David
Rigby**

07730 735 889

Designed and produced by core-marketing.co.uk

Email us:

info@tailoredworkspaces.co.uk

tailoredworkspaces.co.uk

Hines