

*Newly refurbished
Grade A office space
EPC rating A*

632.80 sq m (6,811 sq ft)

Victoria House

Hampshire Court,
Newcastle Business Park
NE4 7YJ



Available now

Victoria House



*Stunning landscaped environment
with superb views of the River Tyne.*

Description

Victoria House comprises a two storey brick built office building beneath a tiled pitched roof, its design compliments the surrounding buildings in Hampshire Court. The office building offers modern flexible open plan accommodation, with the ability to occupy on a cellular basis if required. The business park benefits from a range of amenities including high level of CCTV and security patrols.

Check Out Our Interior



Our Location

Victoria House forms part of Hampshire Court which is located on Newcastle Business Park.

The Park is well established with over 700,00 sq ft of low density office buildings, set within a stunning landscaped environment with superb views of the River Tyne.

OCCUPIERS WITHIN THE PARK INCLUDE:

- Ministry of Justice
- Environment Agency
- Rural Payments Agency
- Story Homes
- Lookers
- BA
- Sergo
- Faithful & Gould
- Your Move

A riverside path links the park to the city centre which is within walking and cycling distance.



Victoria House

A riverside path links the park to the city centre which is within walking and cycling distance.



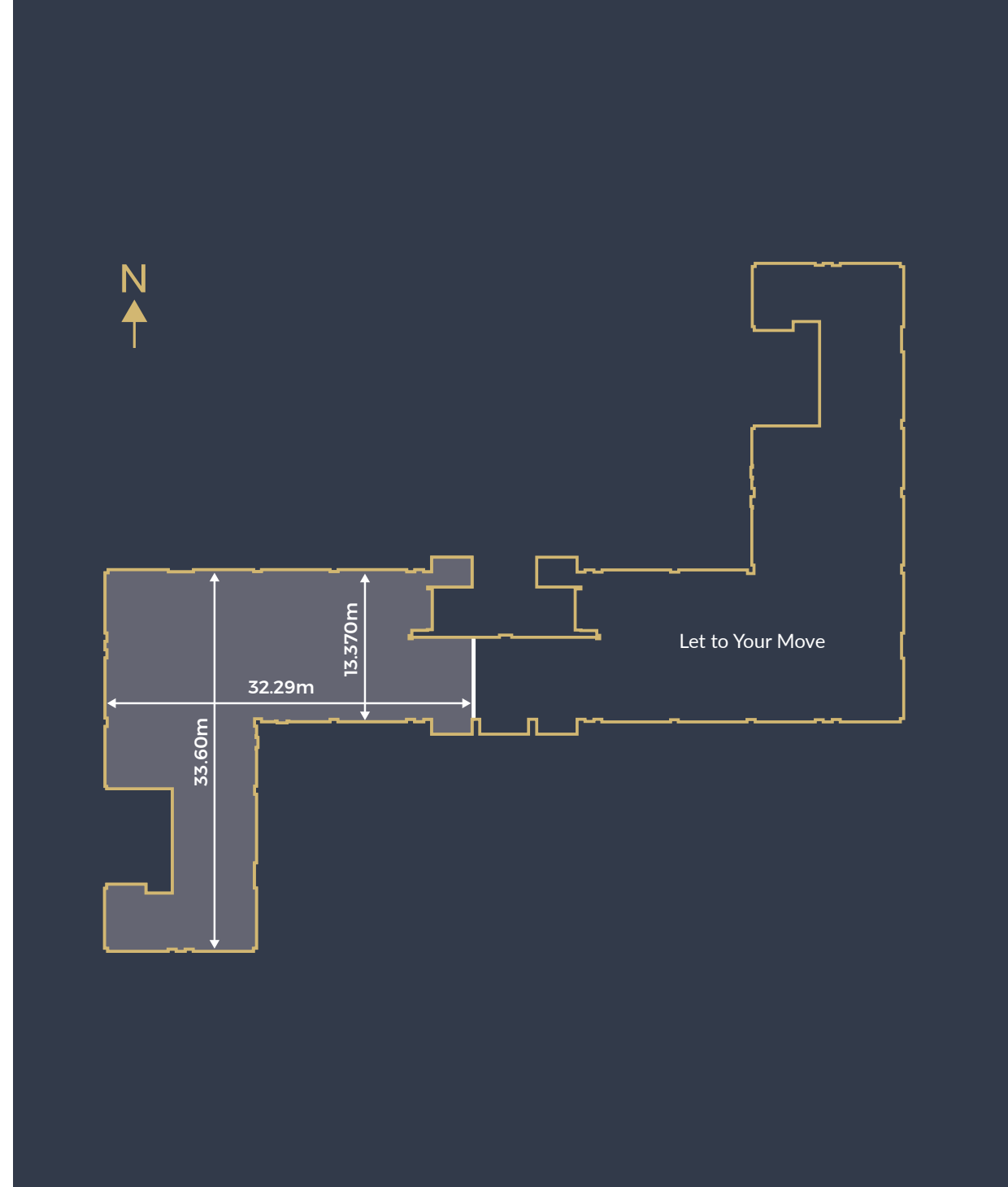

First floor plan

Accommodation



The accommodation comprises of the following approximate areas:

FLOOR	SQ M	SQ FT
GROUND FLOOR WEST		Let to Ministry of Justice
GROUND FLOOR EAST		Let to Ministry of Justice
FIRST FLOOR WEST	632.80	6,811
FIRST FLOOR EAST		Let to Your Move
TOTAL	632.80	6,811

Victoria House



Door access control installed to main building entrance doors.

Specification

Newly refurbished Grade A office space



-  - Energy efficient VRF comfort air conditioning - 1 person per 10sqm
-  - LED lighting
-  - Raised access floor 150mm clear floor void
-  - Floor to ceiling height 2.7m
-  - New mineral fibre suspended ceiling
-  - Carpeted floor covering
-  - 24 car parking spaces
-  - Tea point facilities installed
-  - Newly installed male, female and accessible WC facilities per suite
-  - Newly installed shower facilities
-  - Newly installed automated sliding access doors
-  - Door access control installed to main building entrance doors
-  - Fully refurbished passenger lift 8 person capacity
-  - CAT 6 cabling installed

EPC

The building has an EPC rating of A.

TENURE

New full repairing and insuring lease available.

RENT

On application.

RATEABLE VALUE

To be assessed.

More Information

VIEWING

For further information or an appointment to view please contact the letting agents.



TONY WORDSWORTH

DD: 0191 269 0508

tony.wordsworth@avisonyoung.com

ADAM LAWSON

DD: 0191 269 0064

adam.lawson@avisonyoung.com



JEFF PEAREY

DD: 0113 261 6236

jeff.pearey@eu.jll.com

CHRISTABELLE DAY

DD: 0113 235 5288

christabelle.day@jll.com

(1) Avison Young hereby gives notice that the information provided (either for itself, for any joint agents or for the vendors lessors of this property whose agent Avison Young s)in this brochure is provided on the following conditions: (2) The particulars are set out as a general outline only, for the guidance of intending purchasers and/or lessees and do not constitute an offer or contract, or part of an offer or contract. (3) All descriptions, dimensions and references to this property's condition and any necessary permission for use and occupation, and any other relevant details, are given in good faith and are believed to be correct. However, any intending purchasers or tenants should not rely on them as statements or representations of fact but satisfy themselves of their correctness by inspection or otherwise. (4) No person in the employment of Avison Young, or any joint agents, has any authority to make or give any representation or warranty whatsoever in relation to the property or properties in this brochure. (5) All prices quoted are exclusive of VAT. (6) Avison Young shall have no liability whatsoever in relation to any documents contained within the brochure or any elements of the brochure which were prepared solely by third parties, and not by Avison Young. March 2025.