



TO LET – 100 Temple Street, Bristol, BS1 6AG

1,854 to 19,385 sq ft (172.24 to 1,800.86 sq m)

Paul Williams

Director
+44 (0)117 988 5301
paul.williams@avisonyoung.com

Erin Davies

Graduate
+44 (0)117 988 5232
erin.davies@avisonyoung.com

**AVISON
YOUNG**

Modern City Centre Offices in a Prime Location

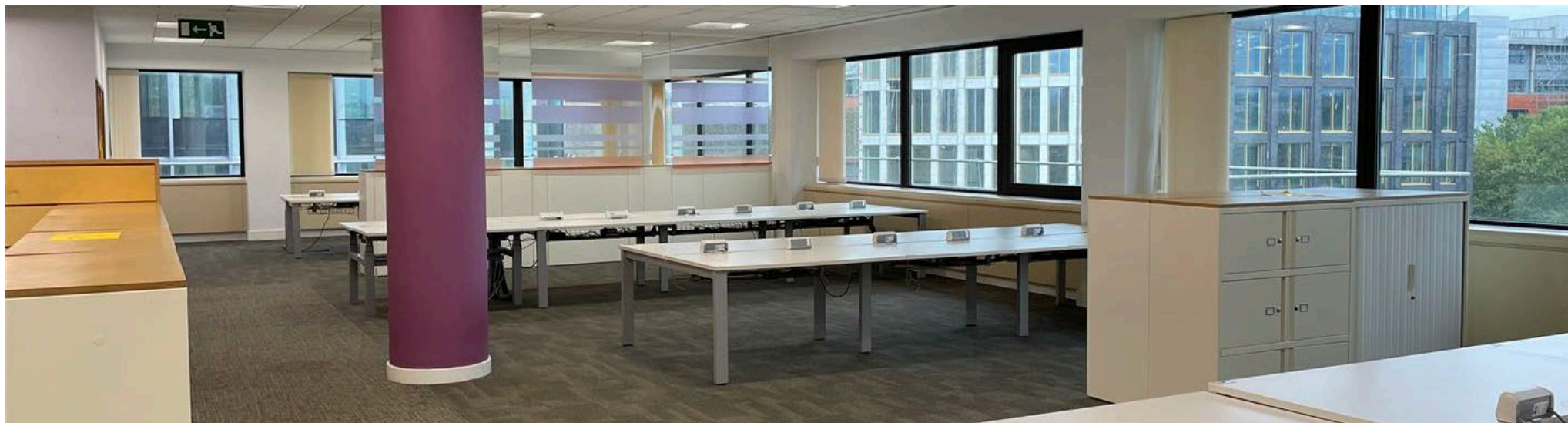

Location

100 Temple Street occupies a prominent location at the junction of Victoria Street and Temple Way overlooking Temple Quay and Temple Meads Station. As such it affords immediate access to rail and bus connections and is a short walk from the amenities of Finzel's Reach and beyond that Broadmead and Cabot Circus shopping centres.

The M32 motorway is within a short drive giving access to the national motorway network. Metered on-street parking is available close at hand, with a range of longer term parking options available within easy reach.

Description

100 Temple Street comprises modern open-plan office space which will be accessed via a new purpose built entrance and shared reception area at ground floor level providing a significant upgrade to the arrival experience. Amenities will include a manned reception desk, secure building access, air-conditioning, suspended ceiling with inset LED lighting, raised access floor.

Having been conceived as a next generation workplace for the city council the building already offers extensive end of journey facilities including secure bike storage, shower and amenity area and access to shared on-site catering facilities.

100 Temple Street – To Let

Accommodation

Floor	Description	Sq Ft	Sq M
Gnd	GF North	1,854	172.24
3 rd	3 rd South	17,531	1,628.62
4 th	4 th North	Under Offer	
Total (NIA)		19,385	1,800.86

Tenure

The suites are available individually or together on the basis of a new effectively FRI lease or leases for a term to be agreed.

The accommodation is offered on a plug & play basis with existing furniture and partitions in place.

Newly refurbished reception

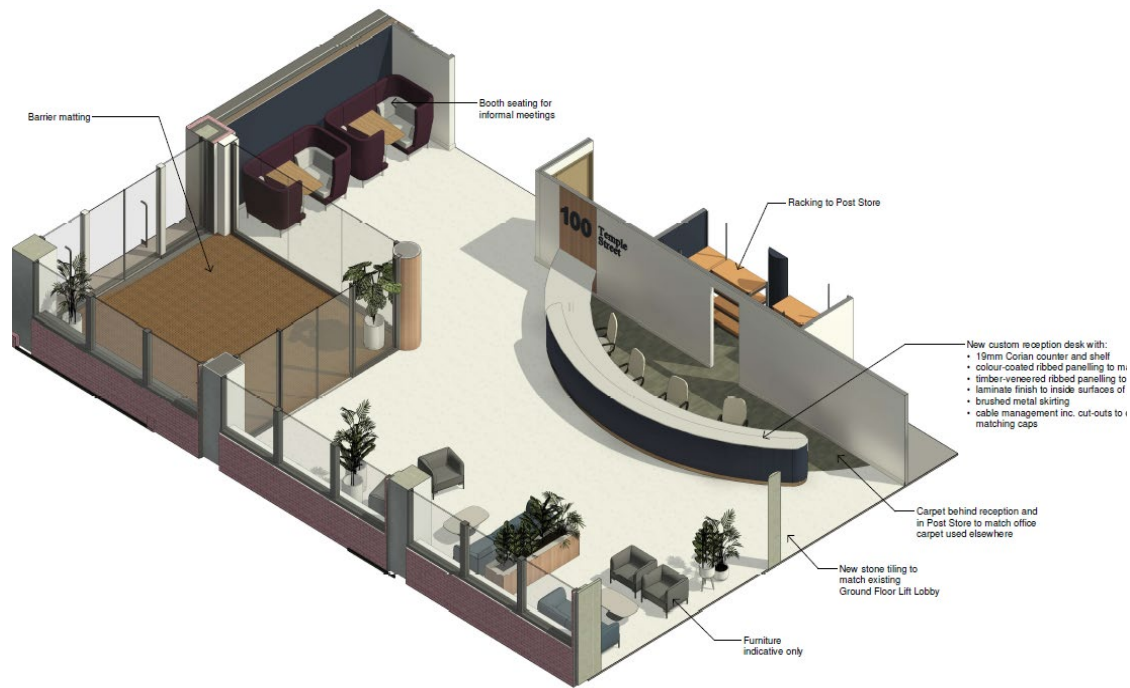



Rental

Commencing rental £25.00 per sq ft.

Business Rates

To be reassessed.

EPC

Subject to reassessment.

VAT

VAT will be charged at the standard rate on the rent and other outgoings.

Legal costs

Each party is to be responsible for their own legal costs incurred in the transaction.

Viewings/Further Information

Please contact the joint sole agents for any further information, or to arrange a viewing.



100 Temple Street – To Let

To find out more, scan the QR code



Paul Williams

+44 (0)117 988 5301

+44 (0)7775 805 164

paul.williams@avisonyoung.com

Chris Grazier (Hartnell Taylor Cook)

+44 (0)117 923 9234

+44 (0)7788 105 578

chris.grazier@htc.uk.com

Avison Young hereby gives notice that the information provided either for itself, for any joint agents or for the vendors lessors of this property whose agent Avison Young is in this brochure is provided on the following conditions:

1. The particulars are set out as a general outline only, for the guidance of intending purchasers and/or lessees and do not constitute an offer or contract, or part of an offer or contract.
2. All descriptions, dimensions and references to this property's condition and any necessary permission for use and occupation, and any other relevant details, are given in good faith and are believed to be correct. However, any intending purchasers or tenants should not rely on them as statements or representations of fact but satisfy themselves of their correctness by inspection or otherwise.
3. No person in the employment of Avison Young, or any joint agents, has any authority to make or give any representation or warranty whatsoever in relation to the property or properties in this brochure.
4. All prices quoted are exclusive of VAT.
5. Avison Young shall have no liability whatsoever in relation to any documents contained within the brochure or any elements of the brochure which were prepared solely by third parties, and not by Avison Young.

Anti-Money Laundering: To comply with our legal responsibilities for Anti-Money Laundering, it will be necessary for the successful bidder to provide information necessary to complete these checks before the deal is completed. Information required will include:

1. Corporate structure and ownership details
2. Identification and verification of ultimate beneficial owners
3. Satisfactory proof of the source of funds for the Buyers / funders / lessee.

**AVISON
YOUNG**

avisonyoung.com