



10 Sturdee Avenue, Great Yarmouth

£240,000 Freehold

Guide Price £240,000 - £250,000 This delightful 3-bedroom semi-detached house sits in the heart of Great Yarmouth, a coastal town with shops, restaurants, schools and beaches. The location offers excellent transport links for easy commuting. Inside, the bright and airy property features a comfortable living room with a feature wall, a modern kitchen/diner perfect for entertaining, and a versatile second reception room. Three good-sized bedrooms and a modern shower room provide comfortable accommodation. Outside, a courtyard garden with a pergola and storage offers a private space to relax, while off-road parking adds convenience.

Tenure: Freehold

Guide Price £240,000 - £250,000 This delightful 3-bedroom semi-detached house sits in the heart of Great Yarmouth, a coastal town with shops, restaurants, schools and beaches. The location offers excellent transport links for easy commuting. Inside, the bright and airy property features a comfortable living room with a feature wall, a modern kitchen/diner perfect for entertaining, and a versatile second reception room. Three good-sized bedrooms and a modern shower room provide comfortable accommodation. Outside, a courtyard garden with a pergola and storage offers a private space to relax, while off-road parking adds convenience.

THE LOCATION

This property is located in the vibrant coastal town of Great Yarmouth, offers a convenient and well-connected setting for residents. Situated in the heart of this bustling seaside town, Sturdee Avenue provides easy access to an array of amenities, including local shops, restaurants, schools, and recreational facilities. Great Yarmouth is celebrated for its picturesque coastline, offering pristine sandy beaches and stunning seafront promenades, perfect for leisurely strolls and enjoying the sea



Guide Price £240,000 - £250,000 This delightful 3-bedroom semi-detached house sits in the heart of Great Yarmouth, a coastal town with shops, restaurants, schools and beaches. The location offers excellent transport links for easy commuting. Inside, the bright and airy property features a comfortable living room with a feature wall, a modern kitchen/diner perfect for entertaining, and a versatile second reception room. Three good-sized bedrooms and a modern shower room provide comfortable accommodation. Outside, a courtyard garden with a pergola and storage offers a private space to relax, while off-road parking



Guide Price £240,000 - £250,000 This delightful 3-bedroom semi-detached house sits in the heart of Great Yarmouth, a coastal town with shops, restaurants, schools and beaches. The location offers excellent transport links for easy commuting. Inside, the bright and airy property features a comfortable living room with a feature wall, a modern kitchen/diner perfect for entertaining, and a versatile second reception room. Three good-sized bedrooms and a modern shower room provide comfortable accommodation. Outside, a courtyard garden with a pergola and storage offers a private space to relax, while off-road parking adds convenience.

THE LOCATION

This property is located in the vibrant coastal town of Great Yarmouth, offers a convenient and well-connected setting for residents. Situated in the heart of this bustling seaside town, Sturdee Avenue provides easy access to an array of amenities, including local shops, restaurants, schools, and recreational facilities. Great Yarmouth is celebrated for its picturesque coastline, offering pristine sandy beaches and stunning seafront promenades, perfect for leisurely strolls and enjoying the sea breeze. The town is rich in history and culture, with numerous historical landmarks and attractions, including the iconic Britannia Pier and the Sea Life Centre. This location benefits from excellent transportation links, ensuring swift commutes to nearby towns and cities, making Sturdee Avenue an ideal spot for those looking to embrace coastal living with urban convenience.

STURDEE AVENUE

Nestled in the serene town of Great Yarmouth, this charming three-bedroom semi-detached house offers a perfect blend of comfort, style and functionality. As you step into the bright and airy porch, you'll appreciate the convenience it provides for storing coats and shoes, keeping the interiors clutter-free. The main sitting room beckons with its dual aspect windows, allowing natural light to flood the space, accentuating the brick-style feature wall. The seamless transition into the modern-gloss kitchen/diner makes hosting family and friends a breeze. The kitchen boasts a mix of built-in appliances and provisions for additional ones, ensuring an overall pleasant cooking experience. For those seeking versatility in living spaces, the property presents a second reception room, which can easily double up as a dining room for intimate gatherings or daily meals.

The sleeping quarters comprise three adequately sized bedrooms, including two doubles and a third bedroom currently utilised as a dressing area. Each bedroom exudes a warm and inviting ambience, ideal for rest and relaxation after a long day. The lovely shower room features a large shower unit, storage solutions and contemporary sanitary ware, adding a touch to the overall space.



GROUND FLOOR



1ST FLOOR

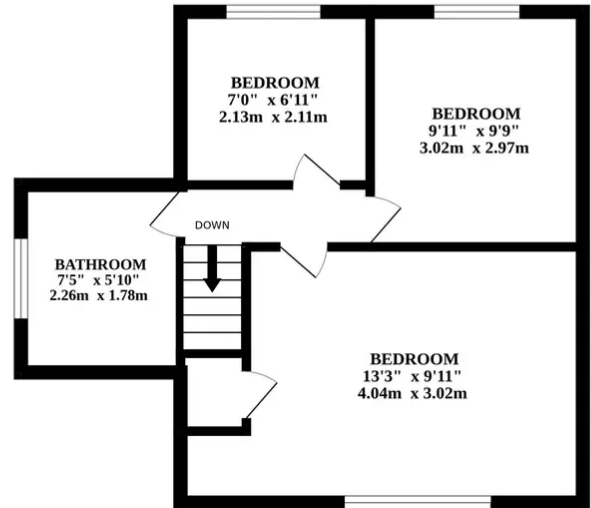

Whilst every attempt has been made to ensure the accuracy of the floorplan contained here, measurements of doors, windows, rooms and any other items are approximate and no responsibility is taken for any error, omission or mis-statement. This plan is for illustrative purposes only and should be used as such by any prospective purchaser. The services, systems and appliances shown have not been tested and no guarantee as to their operability or efficiency can be given.
Made with Metropix ©2024

You can include any text here. The text can be modified upon generating your brochure.

You can include any text here. The text can be modified upon generating your brochure.

