

HOME  TRUTHS

Poplar Drive, Coppull

PR7 4LS

 £335,000



Spacious and extended four bedroom detached property in a popular residential location close to village amenities, countryside walks and sought after schools. With over 1400 square feet on offer this is a first class family home.

The tarmac driveway can accommodate up to four vehicles and leads to the garage, with power and light, and the main entrance. Step into the wide and welcoming entrance hallway with cloakroom off comprising wash hand basin and wc.

Double doors open to the bay fronted living room, and, to the rear the good sized dining room leads to the delightful orangery overlooking the garden. Completing the ground floor the kitchen comprises a range of wall and base units with electric hob, grill and oven and separate utility/boot room with space, power and plumbing for appliances.

Externally, the west facing garden is designed for relaxation and entertainment having lawn bordered by mature planting, two Indian stone sun terraces, one of which comes complete with hot tub, and bespoke bar with power and light.



Back inside, stairs lead to the first floor landing with ladder access to the part boarded loft with light, and the airing cupboard. Bedroom one has two banks of built in wardrobes and en suite comprising rainfall mixer shower in cubicle, wc, ladder heated towel rail and wash hand basin on vanity.

Bedroom two is also a double with bedrooms three and four being comfortable singles. The family bathroom comprises bath with shower attachment, wc and wash hand basin.

Do give us a call to arrange a viewing and make it yours. Council tax D, EPC C, Leasehold.



HOME TRUTHS

Eccleston Branch
265 The Green, Eccleston, PR7 5TF
01257 451673

Coppull Branch
244 Spendmore Lane, Coppull, PR7 5DE
01257 794588

www.hometruthslancs.co.uk
office@hometruthslancs.co.uk





Floor 1

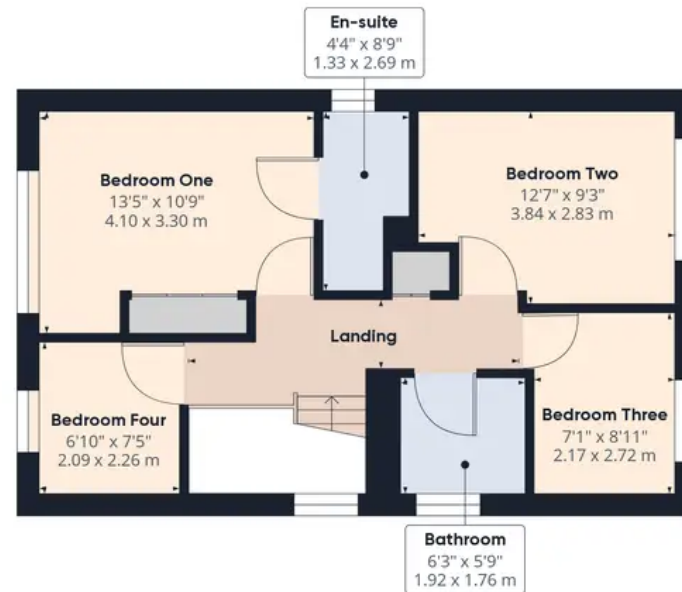

Floor 2

Approximate total area⁽¹⁾
1458.63 ft²
135.51 m²

(1) Excluding balconies and terraces

While every attempt has been made to ensure accuracy, all measurements are approximate, not to scale. This floor plan is for illustrative purposes only.