

FOR SALE

2 Bed Mid Terraced House in Lorraine Road, Aylestone, LE2 8ES
Offers Over £170,000

*** No Chain *** Flush fronted mid terrace for sale in the heat of Aylestone. The property is close to the city centre, Fosse Shopping Park and all major road networks. The accommodation comprises two reception rooms, kitchen, two bedrooms, bathroom and rear garden.



GROUND FLOOR
315 sq ft. (29.2 sq.m.) approx.

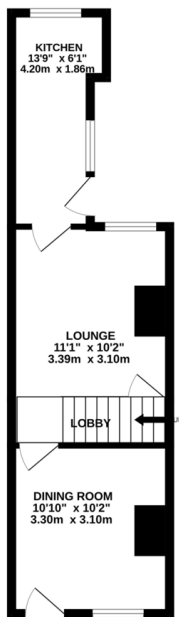

1ST FLOOR
289 sq ft. (26.9 sq.m.) approx.

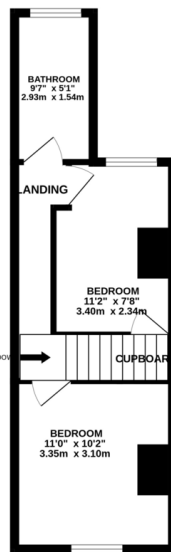

TOTAL FLOOR AREA: 604 sq ft. (56.1 sq.m.) approx.

Whilst every attempt has been made to ensure the accuracy of the floorplans contained herein, measurements of doors, windows, internal and floor coverings are approximate and no responsibility is taken for any error or omission of floor area. This plan is for information purposes only and should not be relied upon for any prospective purchase. The fixtures, systems and appliances shown have not been tested and no guarantee as to their operability or efficiency can be given.
Made with Metreplan 02/24

Energy Efficiency Rating		Current	Potential
Very energy efficient - lower running costs			
(92-100)	A		
(81-91)	B		86
(69-80)	C		
(55-68)	D	87	
(39-54)	E		
(21-38)	F		
(1-20)	G		
Not energy efficient - higher running costs			
England, Scotland & Wales			EU Directive 2002/91/EC

- No Chain
- Mid Terrace
- Flush Fronted
- Rear Garden
- Two Bedrooms
- Ideal First Time Buy
- Convenient Location
- Ideal Investment

Agents Note: Whilst every care has been taken to prepare these sales particulars, they are for guidance purposes only. All measurements are approximate are for general guidance purposes only and whilst every care has been taken to ensure their accuracy, they should not be relied upon and potential buyers are advised to recheck the measurements.

