



**3 Bedroom Semi-Detached House** Asking Price Of **£310,000**

50 Birchwood Road, Stratton St Margaret, Swindon, SN3 4JR

**mcfarlane**  
property.com

## 3 Bedroom Semi-Detached House

Swindon, North Swindon

- 
- SCOPE FOR EXTENDING
  - SEMI DETACHED
  - 3 BEDROOMS
- 

Situated in a popular road in STRATTON ST MARGARET, we are delighted to market this THREE BEDROOM semi detached family home that comes to the market for the first time since it was built in 1960 and is being with NO ONWARD CHAIN.. The property is clean and tidy and would suit someone who is looking to put their own stamp onto this home. The property does benefit from a NEW ROOF ( fitted in 2022 ) and NEW GAS CENTRAL HEATING. A real benefit of this home is the good sized rear garden, coupled with GARAGE and workshop. CALL EARLY TO AVOID MISSING OUT









**Outbuilding**  
Approx. 23.1 sq. metres (248.4 sq. feet)

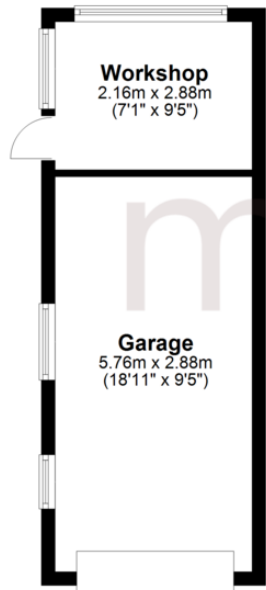

**Ground Floor**  
Approx. 43.3 sq. metres (466.4 sq. feet)

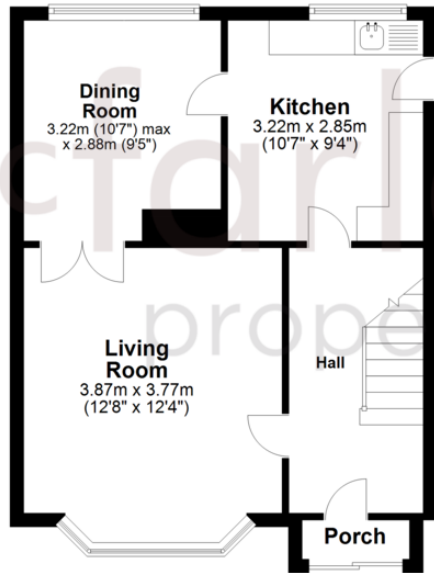

**First Floor**  
Approx. 41.4 sq. metres (445.5 sq. feet)

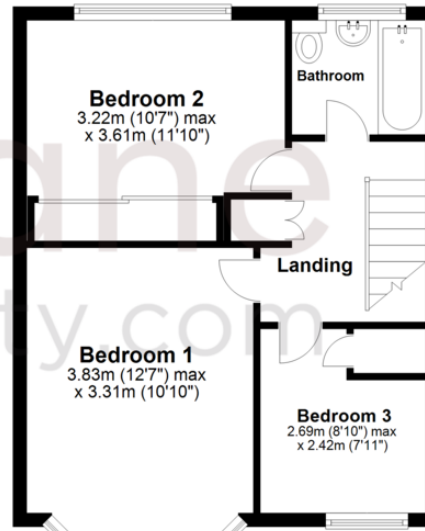

Total area: approx. 107.8 sq. metres (1160.3 sq. feet)

**We**   
**where you**  
**LIVE**

Our team are friendly, experienced and are all local. They know it better than they do their own living rooms and can help you find what you're looking for because **we love where we live.**

We would be delighted to show you around this property.

**Because every home needs a personal touch.**

**If you would like to view this property then please get in touch.**

 01793 296600

 [swindon@mcfarlaneproperty.com](mailto:swindon@mcfarlaneproperty.com)

[mcfarlaneproperty.com](http://mcfarlaneproperty.com)

**mcfarlane**  
property.com

**Cricklade.**  
102 High Street  
Cricklade SN6 6AA  
 01793 751044

**Marlborough.**  
106 High Street  
Marlborough SN8 1LT  
 01672 514380

**Old Town.**  
28-30 Wood Street  
Swindon SN1 4AB  
 01793 296880

**Swindon.**  
The Village Centre,  
Redhouse SN25 2FW  
 01793 296600

Agents Note: Whilst every care has been taken to prepare these sales particulars, they are for guidance purposes only. All measurements are approximate and are for general guidance purposes only and whilst every care has been taken to ensure their accuracy, they should not be relied upon and potential buyers are advised to recheck the measurements