



De Warren Place, Harthill

Sheffield

£165,000



De Warren Place

Harthill, Sheffield

Charming 3-bed semi-detached house in sought-after village with no chain. Spacious lounge, well-appointed bedrooms for family comfort. Mortgage advice available for seamless purchase. Ideal blend of comfort, convenience & style in serene setting.

Please note that any services, heating system or appliances have not been tested, and no warranty can be given or implied as to their working order.

Council Tax band: A

Tenure: Freehold

- NO CHAIN
- THREE BEDROOM SEMI DETACHED HOUSE
- VILLAGE LOCATION
- GENEROUS LOUNGE
- MORTGAGE ADVICE AVAILABLE





Ground Floor

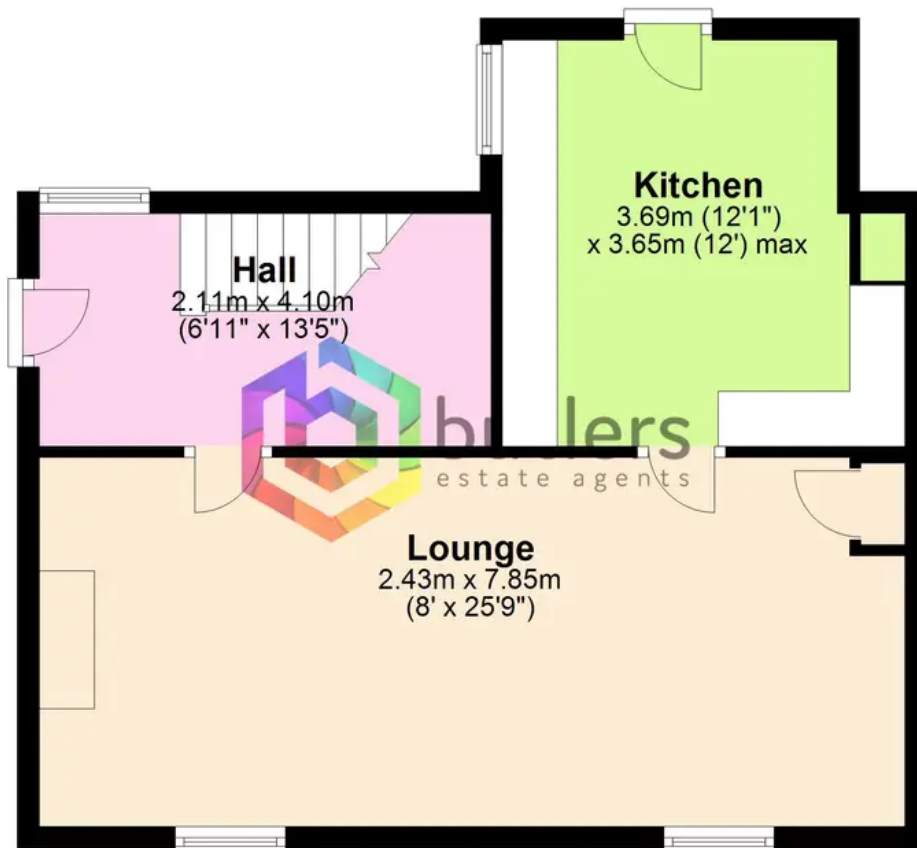

First Floor

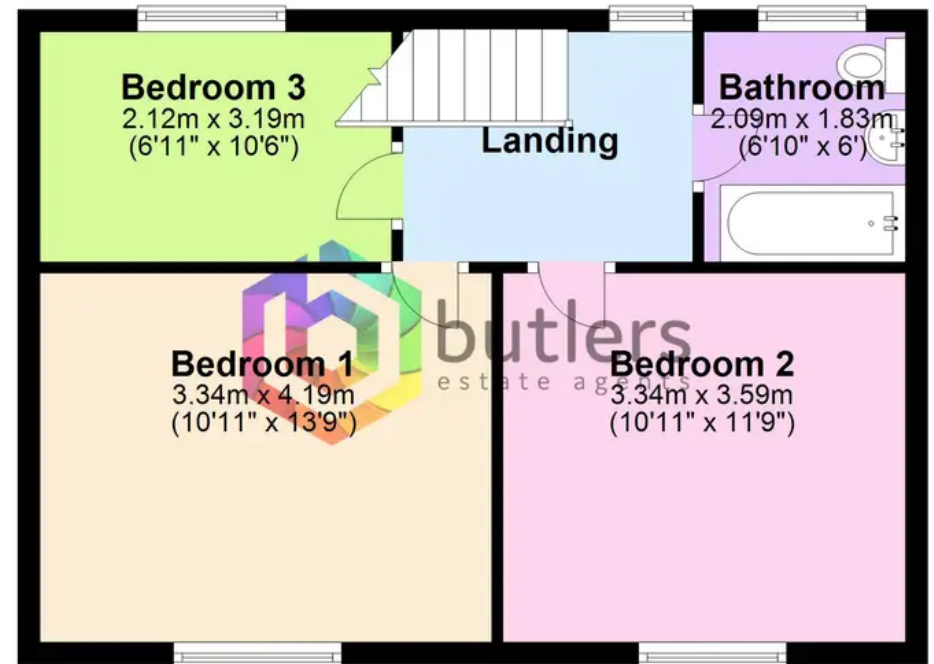

Total area: approx. 88.4 sq. metres (951.9 sq. feet)

Whilst every attempt has been made to ensure the accuracy of this floorplan, all measurements and items on the plan should not be relied upon and no responsibility will be taken for any errors or omissions. The floorplan is owned by Butlers Estate Agents Ltd and should not be copied or reproduced without relevant authority
Plan produced using PlanUp.

Butlers Estate Agents Ltd, 60 High Street, Mosborough, Sheffield S20 5AE