



**Coppendale Boyke Lane, Rhodes Minnis - CT4 6XN**

Guide Price **£750,000**



Approximate Gross Internal Area (Including Low Ceiling) = 167 sq m / 1796 sq ft  
Garage = 40 sq m / 426 sq ft  
Outbuildings = 95 sq m / 1023 sq ft

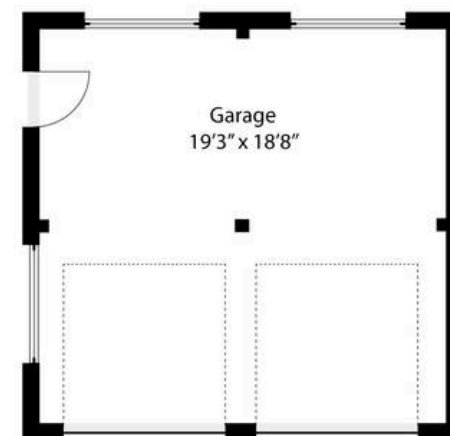
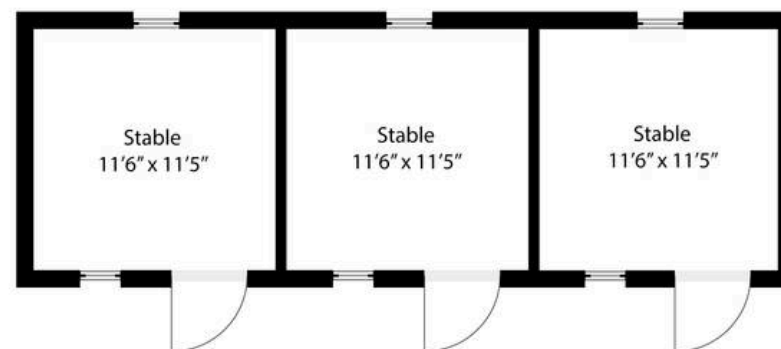
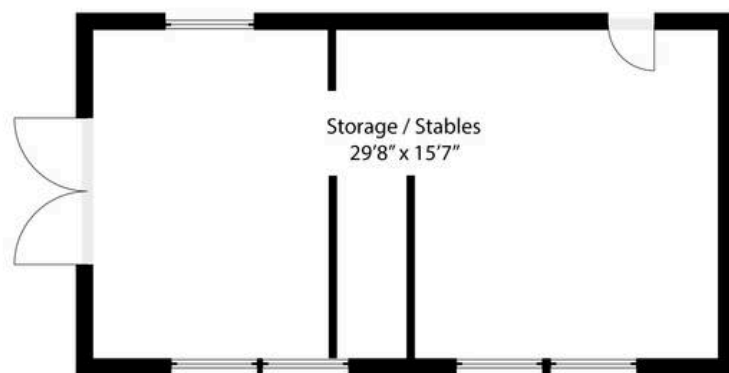

Illustration for identification purposes only. Measurements are approximate. Dimensions given are between the widest points.  
Not to scale. Outbuildings are not shown in actual location.



## Coppendale Boyke Lane

Rhodes Minnis, Canterbury

A fantastic opportunity to purchase a unique spacious home nestled in an idyllic rural location in the sought after village of Rhodes Minnis. The property has recently been redecorated and benefits from a new kitchen, family bathroom. The property further benefits from plenty of scope for extending subject to any necessary planning permissions. The property is set in Approximately 2. 3/4 acres and benefits from stables and storage that are now in need of some attention. ACCOMMODATION: Entrance porch, hallway, spacious double aspect living room with fireplace, dining room with fireplace, kitchen, conservatory, three bedrooms, bathroom, WC, OUTSIDE: Five bar gate to driveway leading to detached double garage, well stocked front and rear garden, three paddocks, stable block with three stables and further stable/storage.

Council Tax band: F

Tenure: Freehold

EPC Energy Efficiency Rating: E

EPC Environmental Impact Rating: F





















## Laing Bennett

Laing Bennett Ltd, The Estate Office, 8 Station Road – CT18 8HP

01303 863393 • [info@laingbennett.co.uk](mailto:info@laingbennett.co.uk) • [www.laingbennett.co.uk/](http://www.laingbennett.co.uk/)

DISCLAIMER – These details are for guidance only and do not form part of an offer or contract. Measurements are approximate. Laing Bennett Ltd and the Vendor/Landlord accept no liability. Services and appliances are untested. Applicants must make their own checks. Items shown may not be included. No staff have authority to give warranties.