



61 King Edward VII, Kings Drive, Midhurst, GU29 0EX



A beautifully presented one bedroom second floor apartment finished off with a high specification finish throughout



- ▶ No Onward Chain
- ▶ On-Site Facilities
- ▶ Communal Rooms
- ▶ Service Charge: £2,594 pa
- ▶ Ideal Investment or First Home
- ▶ Bright and Airy Apartment
- ▶ Private Estate
- ▶ Superfast Broadband
- ▶ Ground Rent: £150 pa
- ▶ 165 Acres of Woodland Walks

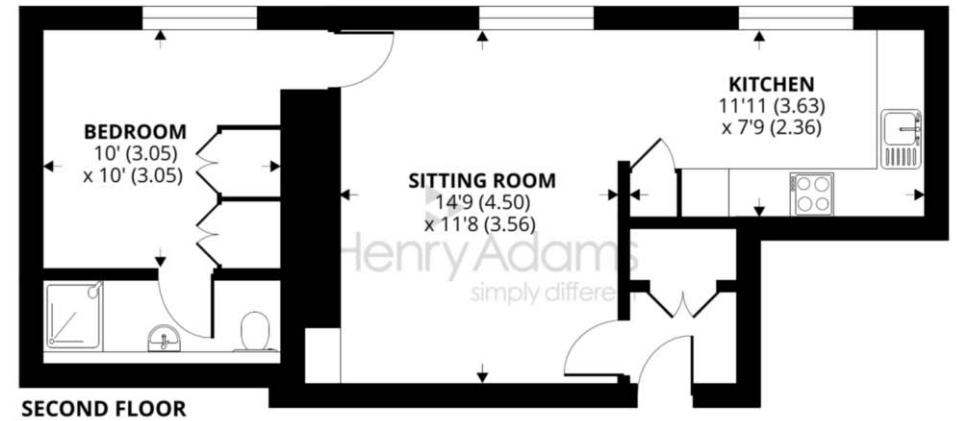

Approximate Area = 485 sq ft / 45.1 sq m
For identification only - Not to scale

Located in the heart of the spectacular South Downs National Park, the King Edward VII estate offers contemporary luxury living within the timeless landscape of an Area of Outstanding Natural Beauty. This charming Grade II listed building was originally founded at the beginning of the 20th Century and has been superbly restored to provide elegant spaces to relax and socialise in. Onsite facilities include a gym, swimming pool, 165 acres of private woodland walks and the availability of a guest suite should you need it. The Estate's friendly concierge is also on hand to ensure you feel perfectly at home.

Tucked away in the north wing No 61 occupies an enviable position and is a second floor, one bedroom apartment covering 485 sq ft. As you enter, style and elegance is the first thing that comes to mind with a high specification finish complimented by spacious open plan living. The main living space is thoughtfully laid out with panoramic windows overlooking the historic building and North green. There is ample space for a table with a comprehensive kitchen layout including plenty of storage and an integrated dishwasher, oven and microwave. There is also a cleverly designed utility cupboard which has plumbing for a washer/dryer. A double bedroom with built in wardrobes and a luxury ensuite shower room finish off the accommodation.

