



**WOOD &
PILCHER**

Sales, Lettings, Land & New Homes



- Victorian Semi-Detached
- Three Bedrooms
- Living Room With Open Fire
- Suntrap Rear Garden
- On road Parking
- Energy Efficiency Rating: D

Powder Mill Lane, Tunbridge Wells

GUIDE £365,000 - £385,000

woodandpilcher.co.uk

86 Powder Mill Lane, Tunbridge Wells, TN4 9EA

Location, location, location! This charming red-brick Victorian semi-detached home with three bedrooms is situated in an enviable location, conveniently proximate to several esteemed primary and secondary educational institutions in Tunbridge Wells. It also offers easy access to High Brooms Mainline station and the charming Southborough High Street. Moreover, a brief bus journey transports you to the celebrated Pantiles and the bustling Tunbridge Wells High Street.

The property boasts a charming front room with an original, fully functioning open fire, creating a cozy ambiance. It also features a spacious dining room, a separate kitchen, and a downstairs bathroom complemented by a separate W/C. The upper floor, you'll discover a grand principal bedroom, a generously sized second bedroom, and a quaint third bedroom ideal for a single bedroom or office space. Furthermore, there is potential for a loft conversion, pending planning approval, as many neighbouring properties have undertaken.

Having served as a beloved family home for many years, this property is now available with no onward chain, presenting an excellent opportunity for first-time buyers, families, and professionals alike. Early viewings are highly recommended.

LIVING ROOM:

In the centre of the cozy carpeted living room sits a functional and beautifully decorated original fireplace. The room offers plenty of space for furniture and features an original-style wood single-glazed window facing the pretty front garden.

DINING ROOM:

A spacious, south-easterly facing window floods the room with natural light, seamlessly connecting the indoors with the outdoors on sunny days. The carpeted space provides plenty of room for entertaining and dining furniture, highlighted by a charming fireplace with a tiled hearth. Additionally, convenient access to ample under-stairs storage, currently housing meters and fuseboard, enhances practicality.

KITCHEN:

The rustic-style kitchen provides ample wooden countertop space along with wall-mounted and under-counter wooden storage units. It features room for a tall freestanding fridge-freezer, dishwasher, and washing machine beneath the countertops, as well as a stainless-steel sink with a drainer. Completing the kitchen are an electric hob, built-in ovens, and a sizable window measuring approximately 5.9 feet. Additionally, the kitchen accommodates a wall-mounted traditional boiler.

BATHROOM:

A ground floor windowed bathroom with bath and pedestal sink with pillar taps over. The low-level WC is separated from the main bathroom.



BEDROOM:

The street-facing principal bedroom offers ample space for bedroom furniture and features original chimney breast, cornice, and a double-glazed window. In addition, there is built-in storage.

BEDROOM:

Originally serving as the second bedroom, this space has been ingeniously partitioned to create a hallway leading to the third bedroom, all while retaining its status as a functional second bedroom.

BEDROOM:

The smaller bedroom presents an ideal setting for an office space or single bedroom. It's worth noting that many similar style homes have relocated the bathroom from downstairs into these third bedrooms, thereby creating the possibility of an upstairs ensuite.

OUTSIDE FRONT:

A well-maintained grassed front lawn sets the property back from the road, enhancing its curb appeal.

OUTSIDE REAR:

The garden, accessible via a side gate, offers a blend of concrete and lush lawn, creating a charming suntrap area towards the rear.

SITUATION:

Nestled on Powder Mill Lane, this property enjoys a prime location within a 1-mile radius of esteemed primary and secondary schools, including Boys and Girls Grammar Schools, Skinners, St. Matthew's CoE Primary School, St. John's CoE Primary School, and St. Augustine Catholic School. Conveniently within walking distance, Highbrooms Mainline Station offers regular half-hourly trains to London Bridge, Waterloo, Charing Cross, and Hastings along the South Coast. Nearby, Southborough High Street and St. John's Road host a variety of amenities, including independent shops, cafes, pubs, and a sports centre. For commuters, easy access to the A26 connects seamlessly to the A21 and the London Orbital Motorway. Furthermore, the vibrant Tunbridge Wells Pantiles and High Street are easily reached via a short 20-minute bus ride (281 Arriva), with services typically available every 15 minutes.

TENURE:

Freehold.

COUNCIL TAX BAND:

C

VIEWING:

By appointment with Wood & Pilcher 01892 511311



Score	Energy rating	Current	Potential
92+	A		
81-91	B		82 B
69-80	C		
55-68	D	56 D	
39-54	E		
21-38	F		
1-20	G		

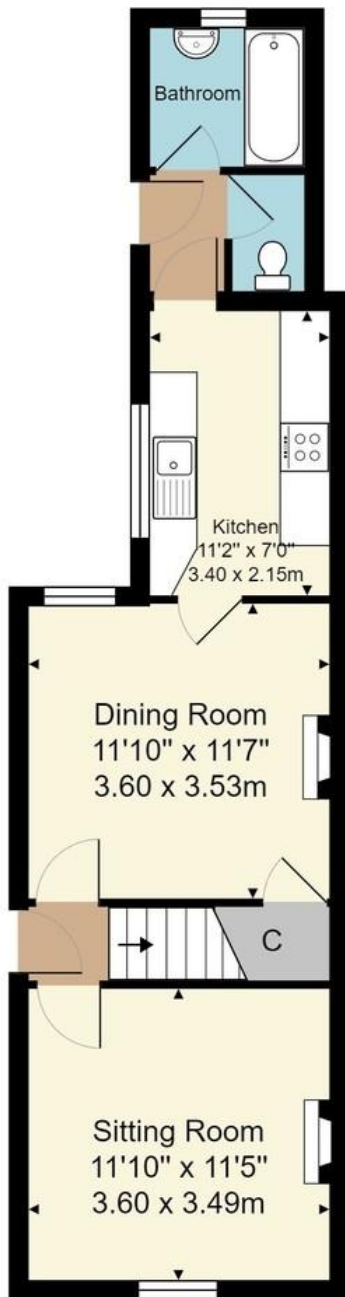

Ground Floor

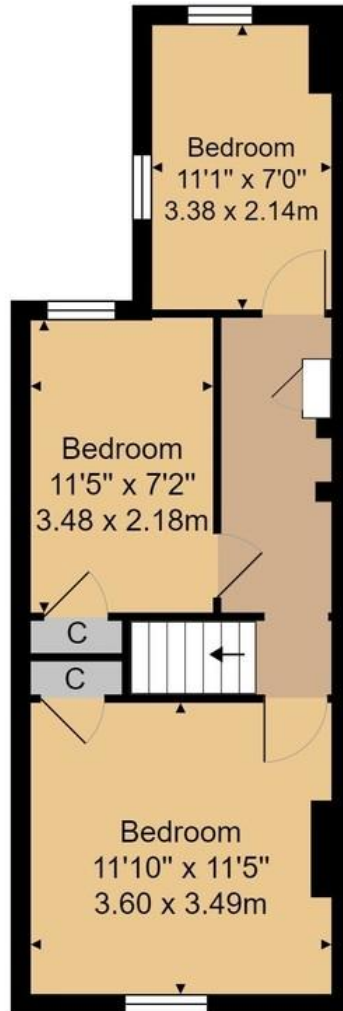

First Floor

Approx. Gross Internal Area 856 sq. ft / 79.5 sq. m

Whilst every attempt has been made to ensure the accuracy of the floor plan contained here, measurements of doors, windows, rooms and any other items are approximate and no responsibility is taken for any error, omission, or mis-statement. This plan is for illustrative purposes only and should be used as such by any prospective purchaser or tenant. The services, systems and appliances shown have not been tested and no guarantee as to their operability or efficiency can be given.

Wood & Pilcher, their clients and any joint agents give notice that: They have no authority to make or give any representations or warranties in relation to the property. Any statements on which a purchaser or Tenant wishes to rely must be checked through their Solicitors or Conveyancers. These Particulars do not form part of any offer or contract and must be independently verified. The text, photographs and floor plans are for guidance only and are not necessarily comprehensive, please also note that not everything in the photographs may be included in the sale. It should not be assumed that the property has necessary planning, Building Regulations or other consents. We have not tested any appliances, services, facilities or equipment and Purchasers or Tenants must satisfy themselves as to their adequacy and condition. We have not investigated the Title, or their existence of any Covenants or other legal matters which may affect the property.

Heathfield 01435 862211
 Crowborough 01892 665666
 Southborough 01892 511311
 Tunbridge Wells 01892 511211
 Letting & Management 01892 528888
 Associate London Office 02070 791568

