



43 Woodcock Avenue, Walters Ash

£415,000



Robertsons

# 43 Woodcock Avenue

Walters Ash, High Wycombe

A spacious semi detached home in this popular village location with the benefit of lovely views over farmland. Entrance hall, Sitting room, Kitchen/Breakfast room, Cloakroom/Utility room, Two bedrooms, Bathroom, Gas central heating, Double glazing, Two allocated parking spaces, Gardens.

Tenure: Freehold





### **Entrance hall**

Radiator, stairs to first floor

### **Sitting room**

Feature fireplace, two radiators, double doors to garden, window to front

### **Kitchen/Breakfast room**

Fitted with a range of eye and base level units incorporating stainless steel sink unit with mixer tap, built in AEG oven, fitted four ring hob with extractor over, space for American style fridge/freezer, space and plumbing for slimline dishwasher, radiator, space for table, part tiled walls, concealed wall mounted gas fired central heating boiler, window to rear, door to garden

### **Cloakroom/Utility room**

Low level W.C., wash hand basin with mixer tap, space and plumbing for washing machine, under stairs storage area

### **First floor**

#### **Landing**

Window to rear

#### **Bedroom 1**

Two radiators, built in wardrobe, windows to front and rear

#### **Bedroom 2**

Built in wardrobe, radiator, window to front

#### **Bathroom**

White suite comprising panelled bath with mixer tap, low level W.C., wash hand basin with mixer tap and cupboards under, part tiled walls, radiator, tiled flooring, down lighters, airing cupboard housing foam clad hot water cylinder and shelved storage

#### **Front garden**

Laid to lawn



# 43 Woodcock Avenue

Approximate Gross Internal Area  
Ground Floor = 37.1 sq m / 399 sq ft  
First Floor = 34.4 sq m / 370 sq ft  
Total = 71.5 sq m / 769 sq ft

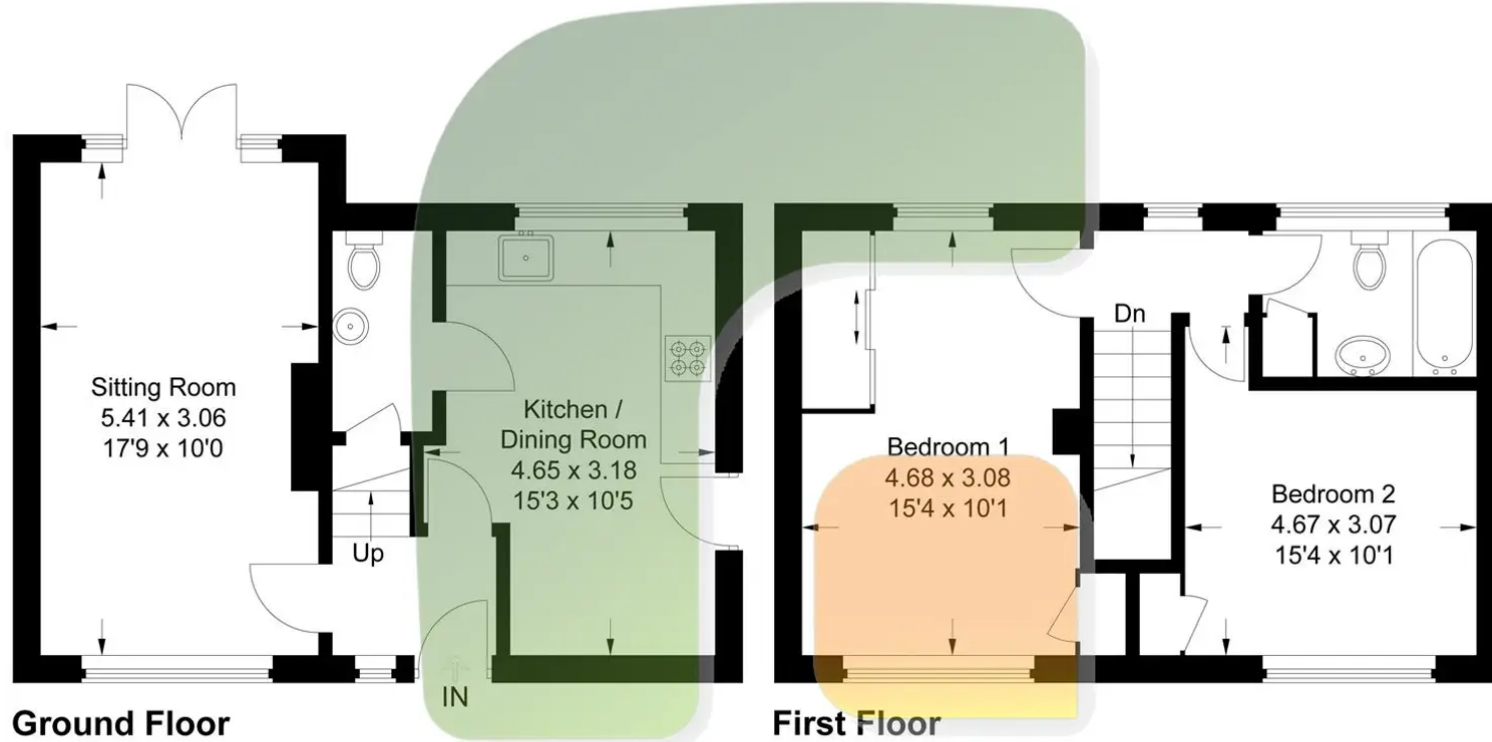

Ground Floor

First Floor

This plan is for layout guidance only. Not drawn to scale unless stated. Windows and door openings are approximate. Whilst every care is taken in the preparation of this plan, please check all dimensions, shapes and compass bearings before making any decisions reliant upon them.

© CJ Property Marketing Ltd Produced for Robertsons



Robertsons