



20 Habberley Street, Kidderminster, Worcestershire

G HERBERT  
BANKS

EST. 1898

20 Habberley Street  
Kidderminster  
Worcestershire  
DY11 6XS

An attractive double fronted mid terrace period house.

Recently upgraded with new carpets.

Well regarded no through street within walking distance of the town centre.

Entrance hall, lounge, dining room, kitchen, utility, cloakroom, cellar.

2 double bedrooms, good size bathroom.

In all about 944 sq.ft

Pleasant enclosed rear garden.

Offering No Onward Chain

### Situation

A very appealing period house within walking distance of a range of local amenities together with the town centre. Kidderminster is the major Wyre Forest town which is very accessible for commuting to Birmingham, the West Midlands conurbation and Worcester.

The town has a direct rail link to London, Birmingham and Worcester.

### Description

This attractive house has just been upgraded by the present owner. This has included internal redecoration and new fitted carpets. The accommodation is centrally heated to radiators and is double glazed.

It is approached by compact entrance hall with the 2 reception rooms either side.

The lounge has a period fireplace and sliding double door to the rear. Adjoining the dining room and to the rear of the house is the fitted kitchen, this includes recently repainted timber cupboards, tiled floor and cooker. Beyond this is a utility area and cloakroom.

Cellar with electric light.

Two first floor double bedrooms and a spacious bathroom with shower over the bath and painted floor.

### Outside

Small fore garden.



Attractive enclosed rear garden with paved patio, dwarf wall, lawn, stocked borders and rear patio area with space suitable for a garden shed.

## GENERAL INFORMATION

### Services

Mains electricity and water, gas and drainage.

### Local Authority

Wyre Forest District Council Tel: 01562 732928

### EPC Rating

A full copy of the EPC can be requested from the selling agents or by visiting: [www.gov.uk/find-energy-certificate](http://www.gov.uk/find-energy-certificate).

The EPC was carried out in February 2021 with a rating 67/D; potential 86/B.

### Viewing by Appointment Only

Via the Agent's Great Witley Office Tel: 01299 896968.

### Fixtures and Fittings

Any items of this nature not specifically mentioned within the confines of these sales particulars are to be excluded from the sale.

### What 3 Words

///cattle.large.barn

Approximate Area = 944 sq ft / 87.7 sq m

For identification only - Not to scale

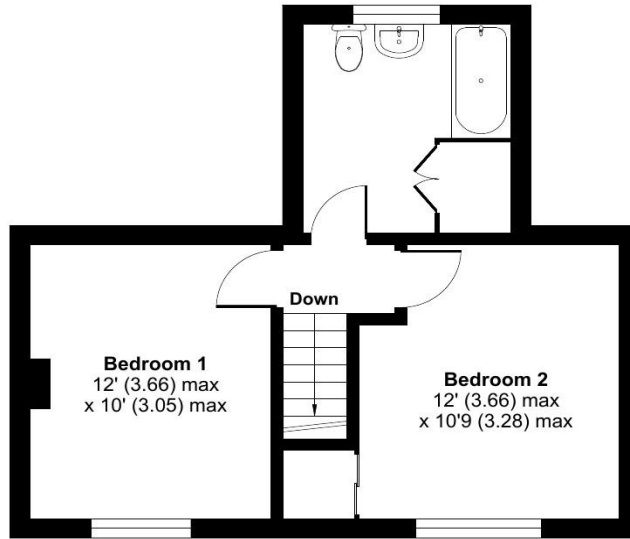

FIRST FLOOR

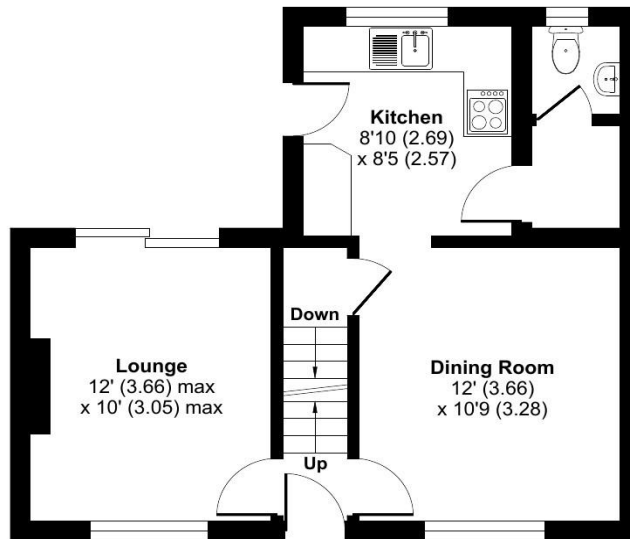

GROUND FLOOR

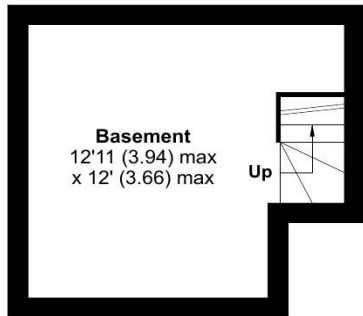

LOWER GROUND FLOOR



G HERBERT BANKS

EST. 1898

01299 896 968  
info@gherbertbanks.co.uk  
www.gherbertbanks.co.uk

The Estate Office, Hill House  
Great Witley, Worcestershire WR6 6JB



AGENTS NOTE The Agents would stress that these particulars have been written as a guide to the prospective purchaser and that measurements are approximate. If a prospective purchaser requires clarification on any point mentioned within these particulars they are asked to contact the Agents. The property is sold with all faults and defects, whether of condition or otherwise and neither the Vendor nor the Agents of the Vendor, are responsible for any such faults or defects or for any statements contained in the general remarks, summaries or particulars of sale of the property prepared by the said Agents. The purchaser shall be deemed to acknowledge that he has not entered into this contract in reliance on any of the said statements, that he has satisfied himself as to the correctness of each of the statements by inspection or otherwise and that no warranty or representation has been made by the Vendor or the said Agents in relation to, or in conjunction with, the property. The plan and quantities are based on the last Ordnance Survey sheets as revised by the Agents. Where fields or enclosures have been divided, the areas have been estimated by the Agents and the quantities are believed to be correct and shall be so accepted by the purchasers. G Herbert Banks LLP is a limited liability partnership registered in England and Wales with registered No. OC344076. G Herbert Banks LLP is a member of The Property Ombudsman.

