



4 Bedroom Town House Offers Over £400,000

Eastbury Way, Redhouse, Swindon, Wiltshire, SN25 2EW

mcfarlane
property.com

4 Bedroom Town House North Swindon

- EXTENSIVELY LARGE TOWNHOUSE
- FOUR BEDROOMS
- SPACIOUS LIVING ACCOMODATION OVER THREE RECEPTION ROOMS
- MODERN KITCHEN AND UTILITY ROOM

This EXTENSIVE PROPERTY with accommodation over THREE FLOORS certainly has IMPRESSIVE PROPORTIONS throughout providing SIZE and VERSATILIITY. With FOUR BEDROOMS, THREE RECEPTION rooms, THREE BATHROOMS and an additional two W/C's as well as a UTILITY room and single GARAGE with PARKING there is room for the whole family. On the ground floor the modern fitted kitchen leads to the utility and French doors to the garden. There is also a reception room also with doors to the garden and a study to the front of the property. On the first floor there is a large, dual aspect living room, a double bedroom with en-suite shower room, the fourth bedroom and a W/C. The second floor with its full height ceilings provides the master bedroom with built in wardrobes and en-suite shower room, a family bathroom and another double bedroom. To the rear of the property is a LOW MAINTENANCE GARDEN, garage and parking.





We 
where you
LIVE

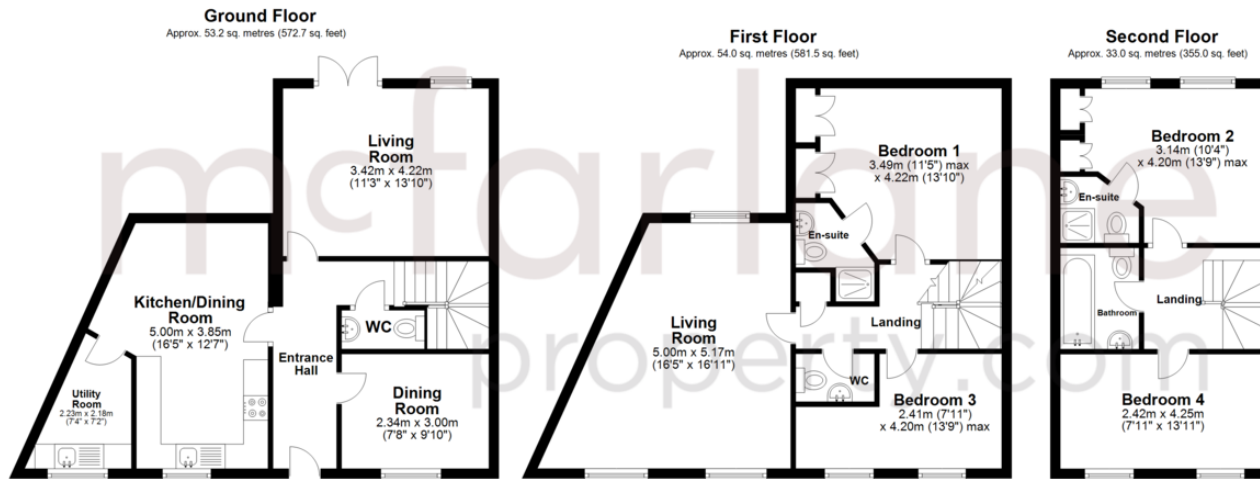

Total area: approx. 140.2 sq. metres (1509.2 sq. feet)

Our team are friendly, experienced and are all local. They know it better than they do their own living rooms and can help you find what you're looking for because **we love where we live.**

We would be delighted to show you around this property.

Because every home needs a personal touch.

If you would like to view this property then please get in touch.

 01793 296600

 swindon@mcfarlaneproperty.com

mcfarlaneproperty.com

mcfarlane
property.com

Cricklade.
102 High Street
Cricklade SN6 6AA
 01793 751044

Marlborough.
106 High Street
Marlborough SN8 1LT
 01672 514380

Old Town.
28-30 Wood Street
Swindon SN1 4AB
 01793 296880

Swindon.
The Village Centre,
Redhouse SN25 2FW
 01793 296600

Agents Note: Whilst every care has been taken to prepare these sales particulars, they are for guidance purposes only. All measurements are approximate are for general guidance purposes only and whilst every care has been taken to ensure their accuracy, they should not be relied upon and potential buyers are advised to recheck the measurements