

15 Ballifield Avenue, Handsworth, Sheffield, S13 9HN



****GUIDE PRICE £175,000-£180,000** ***NO CHAIN***** Fantastic opportunity to purchase this very well presented three bedroom **END TERRACE PROPERTY** located in a highly regarded area benefitting from lounge/diner, utility room and generously sized rear garden. There is a shared driveway leading to a hard-standing parking space (access currently fenced as part of the garden but can be put back).

£175,000 Freehold

Hallway

Lounge/diner - 3.13m x 6.09m (10' 3" x 20')

Kitchen - 3m x 3m (9' 10" x 9' 10")

Utility - 1.67m x 2.22m (5' 6" x 7' 3")

Landing

Bedroom - 3.52m x 3.77m (11' 7" x 12' 4")

Bedroom - 3.5m x 2.53m (11' 6" x 8' 4")

Bedroom - 2.3m x 3.5m (7' 7" x 11' 6")

Bathroom - 1.81m x 1.77m (5' 11" x 5' 10")

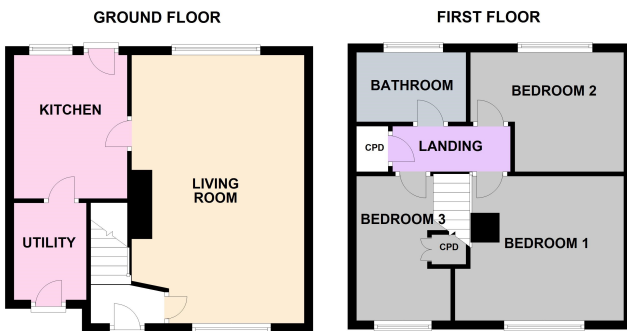

Any areas, measurements or distances referred to are given as a guide only and are not precise. Floor plans are not drawn to scale and are provided as an indicative guide to help illustrate the general layout of the property only.
Plan produced using PlanUp.

Score	Energy rating	Current	Potential
92+	A		
81-91	B		82 B
69-80	C		
55-68	D		
39-54	E	50 E	
21-38	F		
1-20	G		