



Salters Close, Rickmansworth, Hertfordshire, WD3 1HJ

IMMACULATE THREE/FOUR BEDROOM, TWO BATHROOM TOWN HOUSE

ROBSONS

IMMACULATE THREE/FOUR BEDROOM, TWO BATHROOM TOWN HOUSE

**FAMILY ROOM • KITCHEN / LOUNGE •
UTILITY ROOM • GUEST CLOAKROOM •
GARDEN ROOM/BEDROOM FOUR • MASTER
BEDROOM WITH ENSUITE • TWO FURTHER
BEDROOMS • FAMILY BATHROOM • REAR
GARDEN • OFF-STREET PARKING**

Description

Showcasing stylish and modern interiors throughout with an attractive rear garden and off-street parking is this three/four bedroom, two bathroom townhouse. This superb family home enjoys a convenient location and is within walking distance to Rickmansworth amenities, local schools and excellent transport links.

Upon entering the property, you are greeted by a welcoming hallway with a guest cloakroom and stairs to the first floor. There is a front aspect family room leading to a utility room with a fitted units, a sink, room for a washing machine and dryer and a door opening out to the garden. Completing the ground floor is a garden room with French doors opening out to the garden.





To the first floor there is a modern and spacious open-plan kitchen and lounge. The kitchen features a range of fitted units providing ample storage space, integrated appliances and space for a dining table and chairs. The second floor boasts a principal bedroom with a modern, ensuite shower room and under sink storage, two further well-appointed bedrooms and a family bathroom.

Externally, this family home offers a well maintained rear garden, laid to lawn with shrub and flower bed borders and a patio area to enjoy outside dining. To the front is a driveway providing off-street parking.

Location

Rickmansworth town centre has a wide range of shops, coffee houses, restaurants and supermarkets. The Metropolitan and Chiltern line train services connect you to London Baker Street, Marylebone Station and beyond. The M25 motorway is available at both junction 17 and 18, connecting you to the national motorway network. The area is well served for good quality private and state schools for all ages. Chorleywood and Rickmansworth offer everything for the sporting individual. Rickmansworth Aquadrome is an ideal setting for walks, sailing, fishing and water skiing.

Additional Information

Tenure: Freehold

Local Authority: Three Rivers District Council

Council Tax: F

Energy Efficiency Rating: C



Approximate Gross Internal Area
 Ground Floor = 38.0 sq m / 409 sq ft
 First Floor = 43.6 sq m / 469 sq ft
 Second Floor = 43.6 sq m / 469 sq ft
 Total = 125.2 sq m / 1,347 sq ft

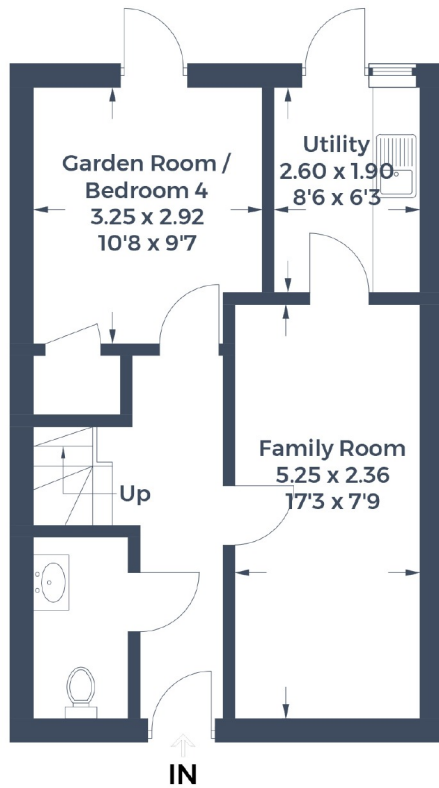

Ground Floor

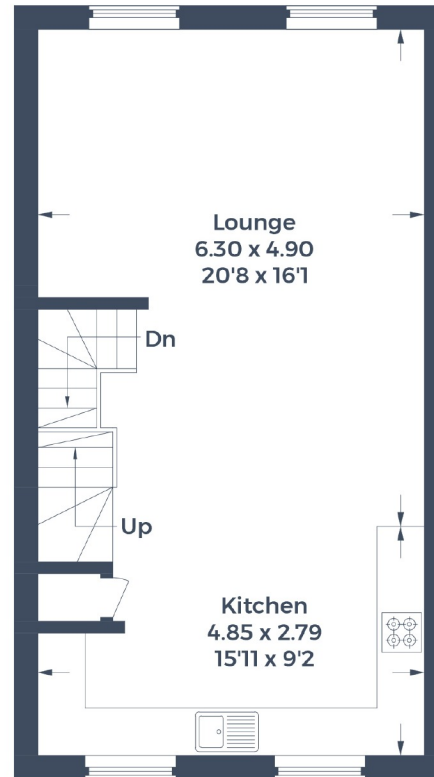

First Floor

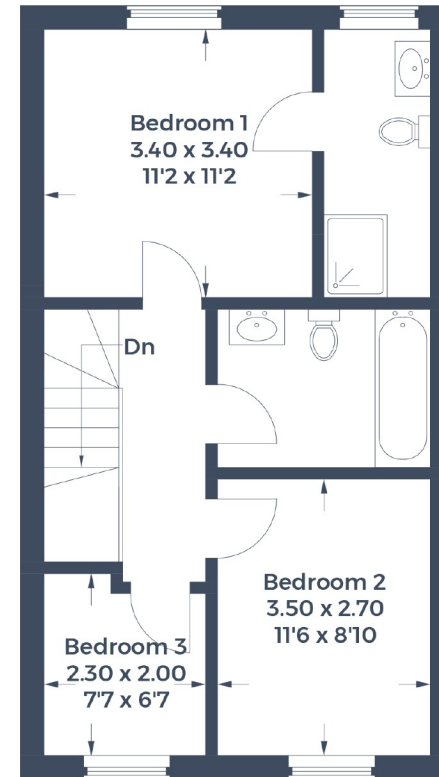

Second Floor

This plan is for layout guidance only. Not drawn to scale unless stated. Windows and door openings are approximate. Whilst every care is taken in the preparation of this plan, please check all dimensions, shapes and compass bearings before making any decisions reliant upon them.

© CJ Property Marketing Produced for Robsons

ROBSONS

130 High Street, Rickmansworth WD3 1AB
 Tel: 01923 777762 Email: rickmansworth@robsonswb.com

www.robsonswb.com