



15 Dibden Lodge Close, Hythe, SO45 6AY
£425,000

ANTHONY JAMES
PROPERTIES



15 Dibden Lodge Close

Hythe, Southampton

Nestled on a highly requested road, this charming 2 bedroom bungalow boasts an array of desirable features. The property presents a fantastic opportunity for those looking to create their dream home, with the potential to extend both up and out (subject to planning permission). Greeted by a driveway offering parking for multiple vehicles, residents will appreciate the convenience of being just a stone's throw away from local amenities. The spacious interior of the bungalow is perfect for comfortable living, while the expansive rear garden provides a tranquil retreat from the hustle and bustle of every-day life.

Dibden Lodge Close is one of the most requested roads in Hythe, favoured for being within walking distance of the historic Hythe Village and waterfront.

Council Tax band: C

Tenure: Leasehold



1 Southward House
Dibden Purlicu SO45 4PT



T: 02380 844405

info@anthonyjamesproperties.co.uk



GROUND FLOOR
754 sq.ft. (70.1 sq.m.) approx.

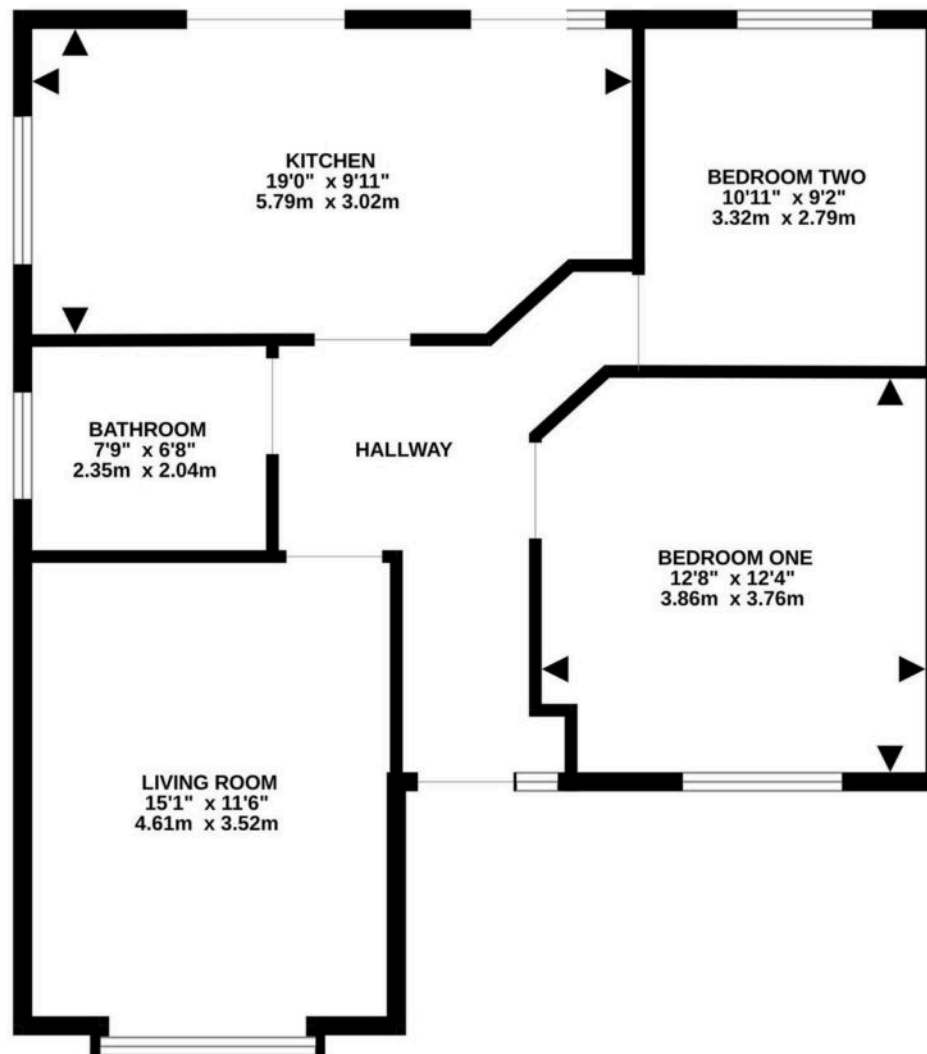

TOTAL FLOOR AREA : 754 sq.ft. (70.1 sq.m.) approx.

Whilst every attempt has been made to ensure the accuracy of the floorplan contained here, measurements of doors, windows, rooms and any other items are approximate and no responsibility is taken for any error, omission or mis-statement. This plan is for illustrative purposes only and should be used as such by any prospective purchaser. The services, systems and appliances shown have not been tested and no guarantee as to their operability or efficiency can be given.
Made with Metropix ©2024