

39-41 High Street, Maidenhead, Berkshire SL6 1JF

Tel: 01628 674234 Fax: 01628 785432

Email: [property@braxtons.co.uk](mailto:property@braxtons.co.uk)

[braxtons.co.uk](http://braxtons.co.uk)



Residential Sales | Land & New Homes | Properties to Let | Landlords, Lettings and Management Services



**PRICE: £399,950 FREEHOLD**

**18 THE WICKETS, MAIDENHEAD, BERKSHIRE, SL6 6TT**

Occupying a cul-de-sac position on this popular development which is conveniently located for the town centre and mainline railway station (Paddington/Elizabeth Line). A two bedroom semi-detached house which would make an ideal home or buy to let investment. The property features a living/dining room with direct access onto the rear garden, kitchen, two good-size bedrooms and a bathroom as well as off street parking. **NO CHAIN.**

**\*ENTRANCE HALL \*KITCHEN \*LIVING/DINING ROOM \*TWO BEDROOMS \*BATHROOM  
\*ENCLOSED REAR GARDEN WITH GATED SIDE ACCESS \*OFF STREET PARKING \*CUL-DE-SAC  
POSITION \*NO CHAIN \*EPC RATING C \*COUNCIL TAX BAND D**

## ACCOMMODATION







For clarification we wish to inform prospective purchasers that we have prepared these sales particulars as a general guide. We have not carried out a detailed survey nor tested the services, appliances and specific fittings. Room sizes should not be relied upon for carpets, furnishings and appliances. Whilst these particulars are believed to be correct their accuracy is not guaranteed and are given without responsibility. They do not form part of any contract.

GROUND FLOOR

1ST FLOOR

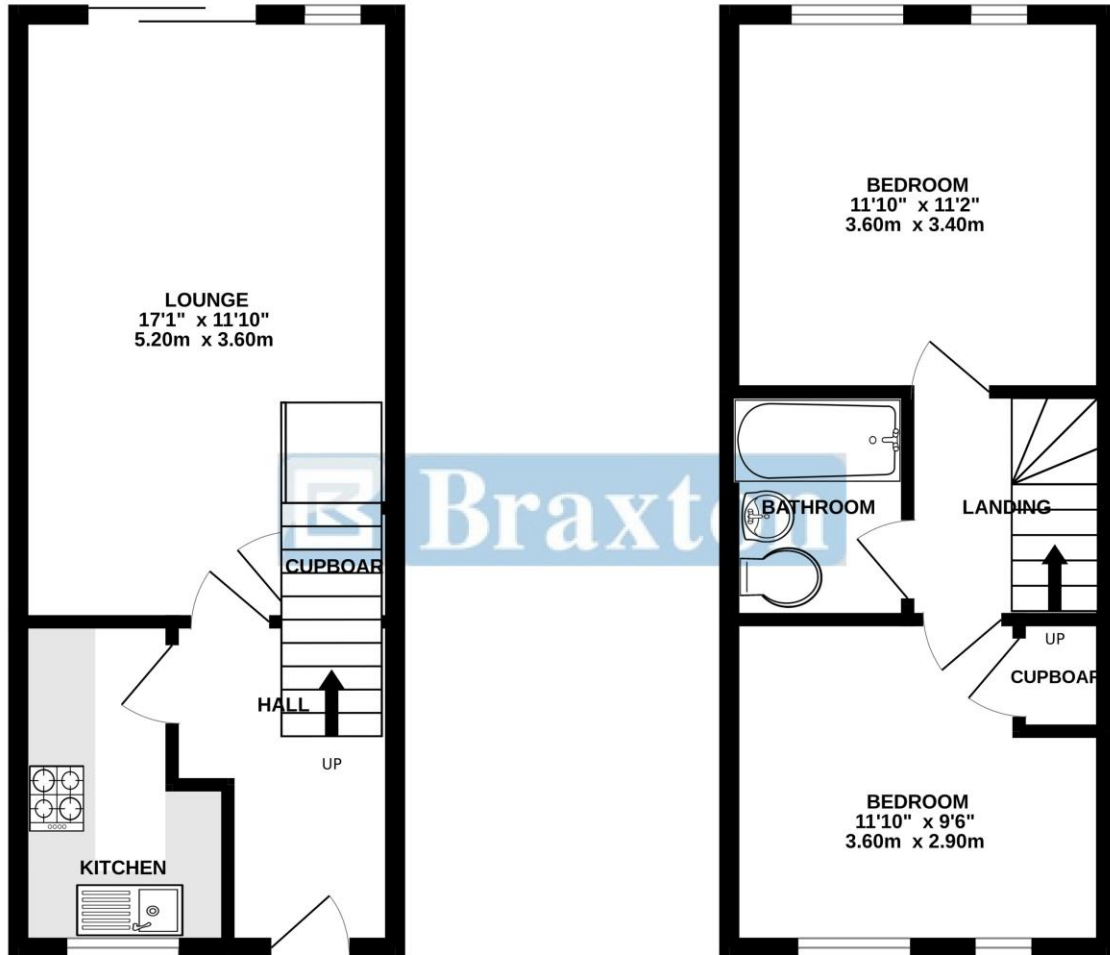

Whilst every attempt has been made to ensure the accuracy of the floorplan contained here, measurements of doors, windows, rooms and any other items are approximate and no responsibility is taken for any error, omission or mis-statement. This plan is for illustrative purposes only and should be used as such by any prospective purchaser. The services, systems and appliances shown have not been tested and no guarantee as to their operability or efficiency can be given.  
Made with Metropix 62024

