



57 California Crescent, California

£235,000 Freehold

In a prime location with easy access to amenities, this inviting home offers a bright and airy feel. Step inside to a spacious entrance porch, perfect for keeping clutter at bay. The open-concept living area features an open fireplace and a modern kitchen with breakfast bar. A sizable conservatory provides extra space, while natural light floods the home throughout. Two comfortable double bedrooms and a well-maintained bathroom ensure functionality and comfort. Outside, a sprawling garden with open views and a garage with off-road parking complete the package.

Council Tax band: A

Tenure: Freehold

In a prime location with easy access to amenities, this inviting home offers a bright and airy feel. Step inside to a spacious entrance porch, perfect for keeping clutter at bay. The open-concept living area features an open fireplace and a modern kitchen with breakfast bar. A sizable conservatory provides extra space, while natural light floods the home throughout. Two comfortable double bedrooms and a well-maintained bathroom ensure functionality and comfort. Outside, a sprawling garden with open views and a garage with off-road parking complete the package.

THE LOCATION

This bungalow, located in California, Norfolk, is a coastal gem offering residents stunning ocean views and a tranquil atmosphere. This crescent-shaped neighbourhood boasts well-maintained landscapes and diverse architecture, creating a perfect blend of coastal charm and modern living. Just a short distance from the beach, it provides easy access to local amenities, making it an ideal spot for those seeking a peaceful seaside retreat.

CALIFORNIA CRESCENT



In a prime location with easy access to amenities, this inviting home offers a bright and airy feel. Step inside to a spacious entrance porch, perfect for keeping clutter at bay. The open-concept living area features an open fireplace and a modern kitchen with breakfast bar. A sizable conservatory provides extra space, while natural light floods the home throughout. Two comfortable double bedrooms and a well-maintained bathroom ensure functionality and comfort. Outside, a sprawling garden with open views and a garage with off-road parking complete the package.



In a prime location with easy access to amenities, this inviting home offers a bright and airy feel. Step inside to a spacious entrance porch, perfect for keeping clutter at bay. The open-concept living area features an open fireplace and a modern kitchen with breakfast bar. A sizable conservatory provides extra space, while natural light floods the home throughout. Two comfortable double bedrooms and a well-maintained bathroom ensure functionality and comfort. Outside, a sprawling garden with open views and a garage with off-road parking complete the package.

THE LOCATION

This bungalow, located in California, Norfolk, is a coastal gem offering residents stunning ocean views and a tranquil atmosphere. This crescent-shaped neighbourhood boasts well-maintained landscapes and diverse architecture, creating a perfect blend of coastal charm and modern living. Just a short distance from the beach, it provides easy access to local amenities, making it an ideal spot for those seeking a peaceful seaside retreat.

CALIFORNIA CRESCENT

Boasting a prime location, this property offers convenient access to local amenities and a desirable neighbourhood setting. Upon entering, you are greeted by a spacious and welcoming large entrance porch, providing the perfect space for housing coats and shoes, ensuring a clutter-free living environment. The main living area offers an open concept design, featuring an electric fire and a charming brick feature wall, creating a cosy ambience that is ideal for or entertaining guests. The newly fitted kitchen with modern wooden accents and a convenient breakfast bar area providing a functional space for meal preparation.

The property further benefits from an excellent sized conservatory, offering additional space for furniture. Natural light floods the living spaces, creating a feeling of openness and warmth throughout the home. The two well-appointed double bedrooms offer comfortable spaces, with ample natural light and space for rest and relaxation. The property also features a well-maintained bathroom, adding to the convenience and comfort of the home.

Outside, the property boasts a sprawling garden plot with open land beyond, offering views of the sea and providing an outdoor space for gardening or enjoying the fresh air. Sufficient off-road parking and a garage provide ample storage space and convenience.

AGENTS NOTE



GROUND FLOOR

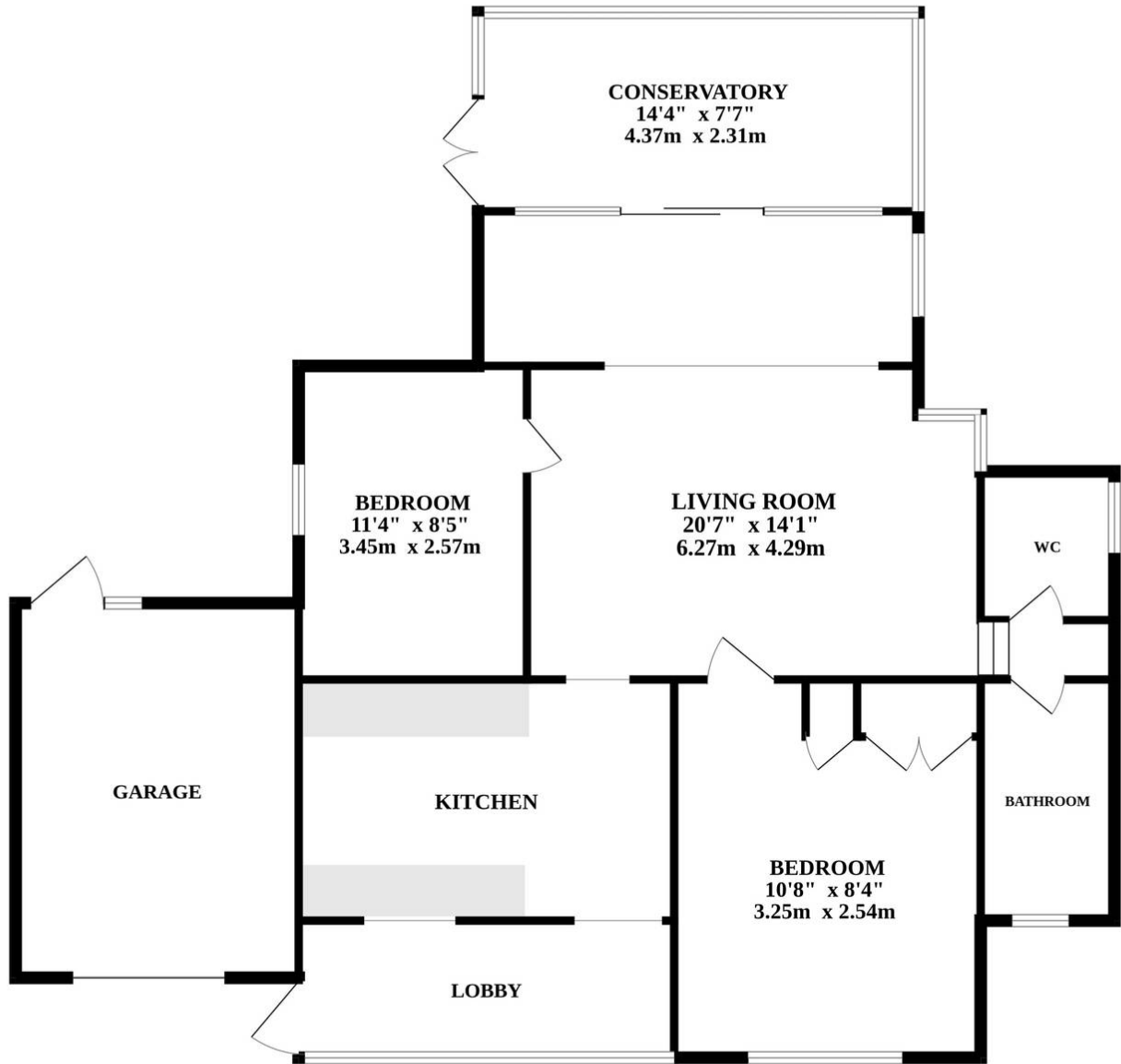

Whilst every attempt has been made to ensure the accuracy of the floorplan contained here, measurements of doors, windows, rooms and any other items are approximate and no responsibility is taken for any error, omission or mis-statement. This plan is for illustrative purposes only and should be used as such by any prospective purchaser. The services, systems and appliances shown have not been tested and no guarantee as to their operability or efficiency can be given.
Made with Metropix ©2024

You can include any text here. The text can be modified upon generating your brochure.

You can include any text here. The text can be modified upon generating your brochure.

