

Main Street

Yoxall, Burton-on-Trent, DE13 8NQ



A charming beamed cottage of great character offering bright and spacious two/three bedroom accommodation with central heating, wood burner and part double glazing set in this popular village opposite the church and offered with no onward chain and vacant possession.

Guide Price £275,000

John German

The village of Yoxall has a popular pub, primary school, excellent health centre and village hall together with countryside walks. It also falls in catchment of the highly regarded John Taylor Academy in the neighbouring village of Barton under Needwood which has a wide range of amenities. For the commuter, Lichfield and Burton on Trent are each within easy reach both of which have train stations, and the A38 provides access to major cities.

The property is accessed via the side entrance hall having exposed beams and leading into a spacious dining room again exhibiting lovely exposed period beams and having stairs off together with a half glazed door out to the rear courtyard garden.

Off the dining room is an attractive fitted kitchen having a range of base and wall units surmounted by wood effect worktops with inset 1.5 bowl composite sink with mixer tap and tiled splash backs, inset Rangemaster slot in cooker with extractor hood over, further appliance spaces with plumbing for an automatic washing machine, laminate flooring and a wall mounted cupboard housing the gas boiler.

A lovely large panelled period door opens into the bright sitting room which has a brick recessed fireplace housing the wood burner together with dual aspect windows to either side. Off this is a very useful study or bedroom three which has a wonderful vaulted ceiling with superb exposed timbers and a cloakroom leading off with a WC and wash basin.

Stairs ascend from the dining room and lead to the landing which has an exposed beam, loft access and a useful built in storage cupboard. To the front of the cottage is a lovely master bedroom enjoying dual aspect to both front and rear and having useful built in twin wardrobes. Adjacent to this is a second useful sized bedroom also with dual front and side aspect. These are served by an attractive bathroom equipped with a bath in tiled surround having mixer shower over and glazed screen, pedestal wash hand basin, low level WC, chrome heated towel rail and laminate flooring.

Outside - The property is set off the high street and there is a pedestrian access to the side. Accessed from the dining room is an enclosed rear block paved courtyard which offers a very pleasant and private outside space plus a very useful store shed.

Notes: The property is Grade II listed. There is no private parking for this property and on street parking is extremely limited.

Tenure: Freehold (purchasers are advised to satisfy themselves as to the tenure via their legal representative).

Property construction: Traditional

Parking: On street

Electricity supply: Mains

Water supply: Mains

Sewerage: Mains

Heating: Gas

(Purchasers are advised to satisfy themselves as to their suitability).

Broadband type: Services are available

See Ofcom link for speed: <https://checker.ofcom.org.uk/>

Mobile signal/coverage: See Ofcom link <https://checker.ofcom.org.uk/>

Local Authority/Tax Band: East Staffordshire Borough Council / Tax Band D

Useful Websites: www.gov.uk/government/organisations/environment-agency

Our Ref: JGA/13062024

The property information provided by John German Estate Agents Ltd is based on enquiries made of the vendor and from information available in the public domain. If there is any point on which you require further clarification, please contact the office and we will be pleased to check the information for you, particularly if contemplating travelling some distance to view the property. Please note if your enquiry is of a legal or structural nature, we advise you to seek advice from a qualified professional in their relevant field.

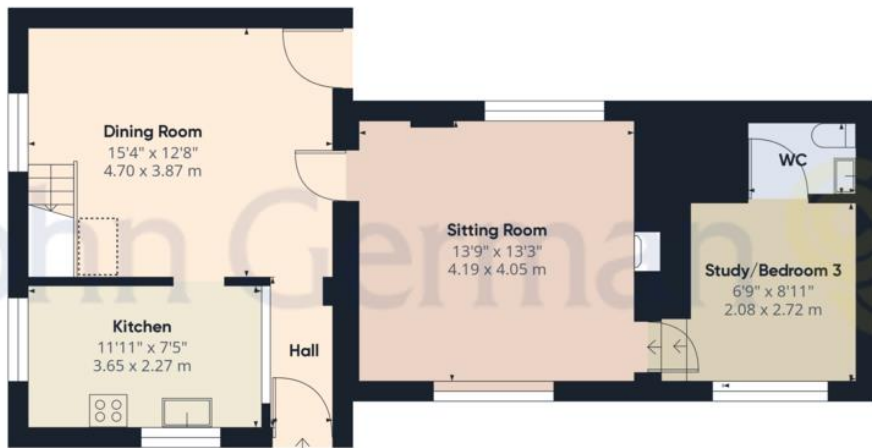

Ground Floor

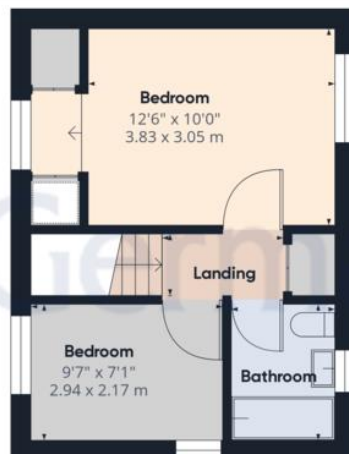

Floor 1

John German

Approximate total area⁽¹⁾

883.13 ft²
82.05 m²

Reduced headroom

5.56 ft²
0.52 m²

(1) Excluding balconies and terraces

Reduced headroom
(below 1.5m/4.92ft)

While every attempt has been made to ensure accuracy, all measurements are approximate, not to scale. This floor plan is for illustrative purposes only.

GIRAFFE 360





AWAITING EPC MEDIA



John German
 21 Main Street, Barton under Needwood, Burton-On-Trent, Staffordshire, DE13 8AA
 01283 716806
 barton@johngerman.co.uk

Agents' Notes

These particulars do not constitute an offer or a contract neither do they form part of an offer or contract. The vendor does not make or give and Messrs. John German nor any person employed has any authority to make or give any representation or warranty, written or oral, in relation to this property. Whilst we endeavour to make our sales details accurate and reliable, if there is any point which is of particular importance to you, please contact the office and we will be pleased to check the information for you, particularly if contemplating travelling some distance to view the property. None of the services or appliances to the property have been tested and any prospective purchasers should satisfy themselves as to their adequacy prior to committing themselves to purchase.

Referral Fees

Mortgage Services - We routinely refer all clients to APR Money Limited. It is your decision whether you choose to deal with APR Money Limited. In making that decision, you should know that we receive on average £60 per referral from APR Money Limited.

Conveyancing Services - If we refer clients to recommended conveyancers, it is your decision whether you choose to deal with this conveyancer. In making that decision, you should know that we receive on average £150 per referral.

Survey Services - If we refer clients to recommended surveyors, it is your decision whether you choose to deal with this surveyor. In making that decision, you should know that we receive up to £90 per referral.

Ashbourne | Ashby de la Zouch | Barton under Needwood
 Burton upon Trent | Derby | East Leake | Lichfield
 Loughborough | Stafford | Uttoxeter

JohnGerman.co.uk Sales and Lettings Agent