



113 Princes Avenue, Surbiton
Surbiton

£699,950

**newton
huxley.**

113 Princes Avenue

Surbiton, Surbiton

Spacious three-bedroom semi-detached home with ample natural light, modern amenities, and convenient proximity to Tolworth rail station and top-rated schools, featuring a generous rear garden and driveway

Council Tax band: E

Tenure: Freehold

EPC Energy Efficiency Rating: D

EPC Environmental Impact Rating: D

- Extended Semi Detached Home
- 0.3 Miles From Tolworth Train Station
- Three Well Proportioned Bedrooms
- Large Living Room & Separate Dining Room
- Circa 150Ft Rear Garden
- Driveway For 2/3 Vehicles
- EPC Rating - D





Princes Avenue

Total Area: 113.50 m² ... 1221.70 ft²

FOR ILLUSTRATIVE PURPOSE ONLY.

Whilst every attempt has been made to ensure the accuracy of the floor plan shown, all measurements, positioning, fixtures, features, fittings and any other data shown are an approximate interpretation for illustrative purposes only and are not to scale.

No responsibility is taken for any error, omission, miss-statement or use of data shown.

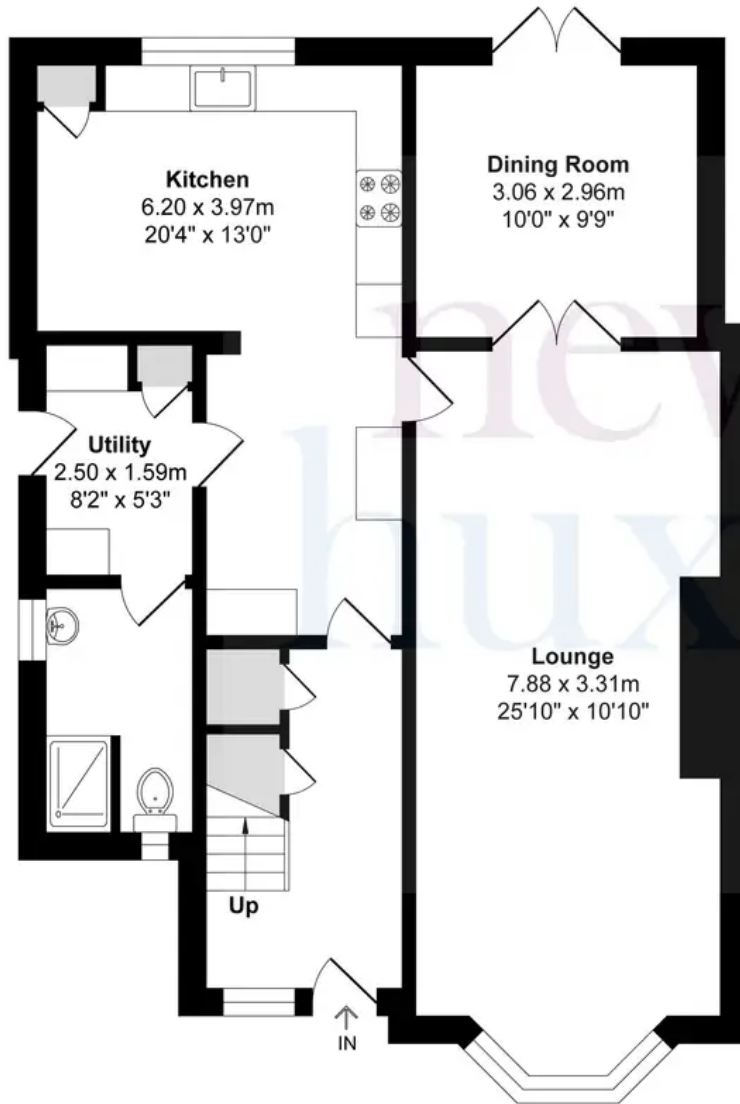

Ground Floor

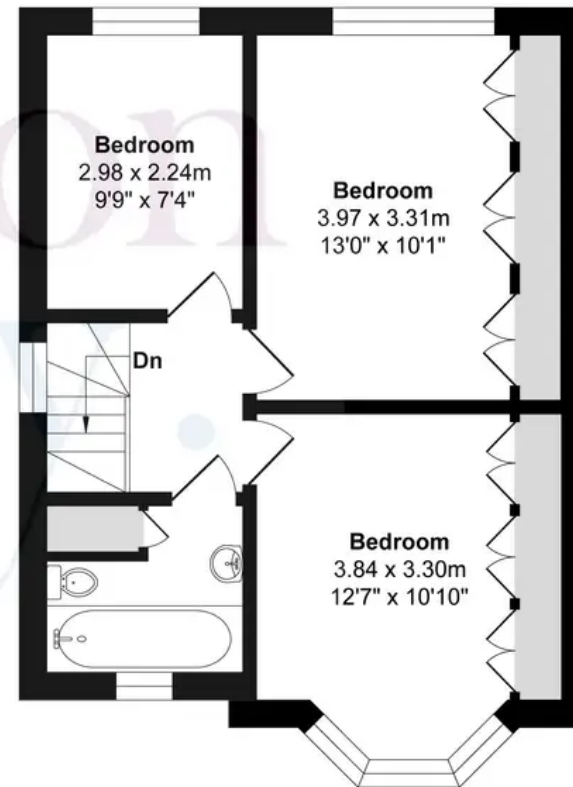

First Floor

