

Nik Nak 2, Florentia  
Clothing Village, Vale  
Road HARRINGEY | N4 1TD

# FLORENTIA CLOTHING VILLAGE

Studio space in a creative  
hub for people and  
businesses

4,000 - 7,000 ft<sup>2</sup>  
(371.61 - 650.32 m<sup>2</sup>)



STRETTONS



Nik Nak 2, Florentia  
Clothing Village, Vale  
Road HARRINGEY | N4 1TD

## Location

Located within the main square of Florentia Clothing Village, Nik Nak Cottage has been the creative hub for people and businesses. Home to a vast array of businesses, whose motivation to work within a community of like-minded creatives is a priority, Florentia is ideal for those who demand a London base with the great value that North London offers.

Located in Haringey Warehouse District, an area rapidly becoming a leading centre of creative excellence for designers, technologists, craftspeople and makers.

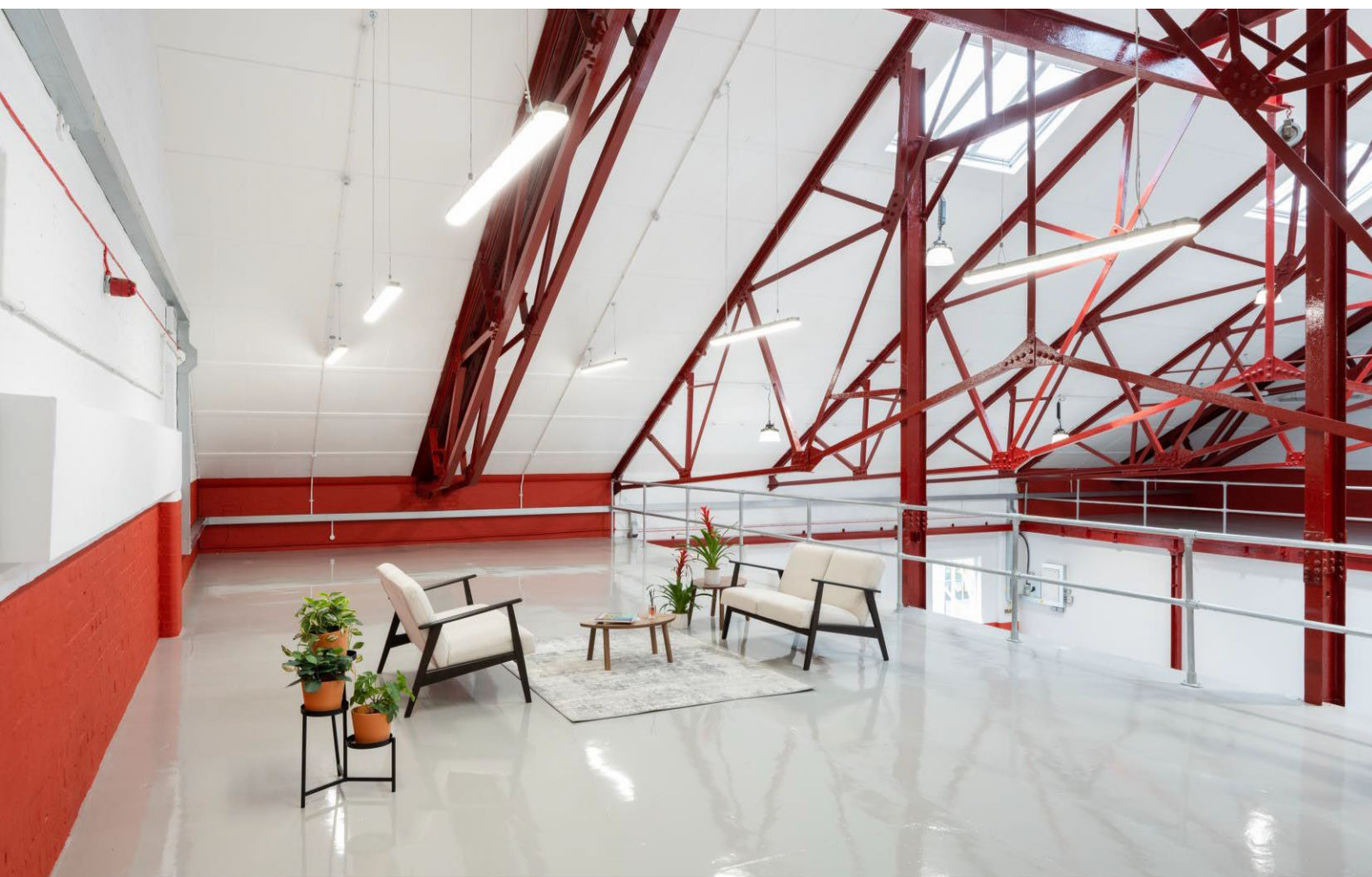



## Description

The Nik Nak building is being created as prime workspace at Florentia, a much-loved and highly-respected creative business hub in North London.

7,061 SQFT of Self contained and sustainably built-for-purpose studio space with generous and inspiring design features over two floors.

Located in Harringay Warehouse District, an area rapidly becoming a leading centre of creative excellence for designers, technologists, craftspeople and makers.

## Accommodation

ACCOMMODATION	FT <sup>2</sup>	M <sup>2</sup>
Warehouse (studio/gallery)	4,000 - 7,000	371.61 - 650.32

## Highlights

- Fully refurbished
- LED lighting
- 11M Apex height
- Parking spaces
- Loading facilities
- Electronic roller shutters
- 24/7 access to the estate
- 24/7 security on site
- Mezzanine
- Self contained toilets



LED  
LIGHTING

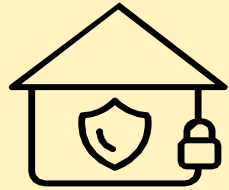

24/7 SECURITY

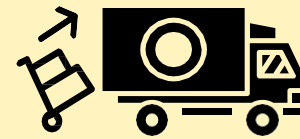

LOADING FACILITIES



PARKING  
SPACES



TRANSPORT &  
ROAD LINKS

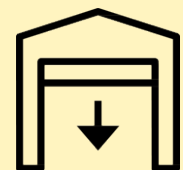

ELECTRONIC  
ROLLER  
SHUTTERS





N i k N a k 2 ,  
F l o r e n t i a C l o t h i n g  
V i l l a g e , V a l e  
R o a d H A R R I N G E Y | N 4 1 T D

**LEASE TERMS:**

New Lease

**RENT:**

£30 per sq ft

**BUSINESS RATES:**

To be confirmed.

**LEGAL COSTS:**

Each party to bear their own costs

**EPC:**

D 76 Rating

**VAT:**

All To be confirmed.

**SERVICE CHARGE:**

To be confirmed.



Strettons  
Waltham House, 11 Kirkdale Road  
London E11 1HP

For further information please contact:

Harry Robins

[harry.robins@strettons.co.uk](mailto:harry.robins@strettons.co.uk)

07866 075 899

Chris Wade

[Chris.wade@strettons.co.uk](mailto:Chris.wade@strettons.co.uk)

07816 505 718

Tom Schwier

[tom.schwier@strettons.co.uk](mailto:tom.schwier@strettons.co.uk)

07583 037 559

Strettons for themselves and for the vendors of this property give notice that: a) the particulars are set out as general outline only for the guidance of intending purchasers and do not constitute, nor constitute part of, an offer or contract; b) all descriptions, dimensions, references to condition and necessary permissions for use, lease details and occupation and other details are given in good faith and are believed to be correct, but any intending purchaser should not rely on them as statements or representations of fact but should satisfy themselves by inspection or otherwise as to the correctness of each of them; c) no person in the employment of Strettons has any authority to make or give any representation or warranty whatsoever in relation to this property. Subject to Contract. June 2023.