

FOR SALE



Keats Close, Earl Shilton
£179,000

MARTIN&CO

17 Keats Close

- TWO BEDROOM SEMI DETACHED HOUSE
- QUIET CUL DE SAC LOCATION
- CLOSE TO LOCAL AMENITIES & A47
- LOUNGE & KITCHEN DINER
- ONE DOUBLE BEDROOM AND A SINGLE

IDEAL FIRST HOME OR INVESTMENT PROPERTY

- An ideal opportunity to purchase this two bedroom semi detached home ideally situated in a cul de sac position and within easy reach of local amenities, shops, schools and the A47 for commuting. The accommodation briefly comprises of a lounge, kitchen diner, two bedrooms and a wet room. The property also benefits from double glazing, gas central heating, gardens to the front and rear and off road parking.

GROUND FLOOR

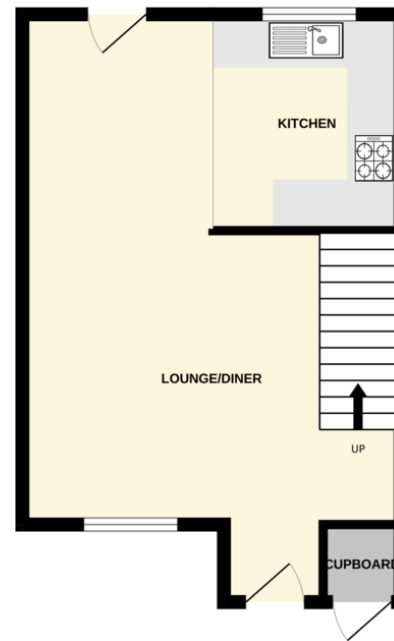

1ST FLOOR

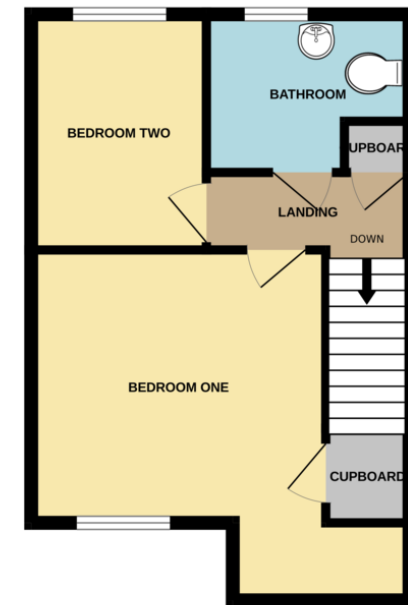

Whilst every attempt has been made to ensure the accuracy of the floorplan contained here, measurements of doors, windows, rooms and any other items are approximate and no responsibility is taken for any error, omission or mis-statement. This plan is for illustrative purposes only and should be used as such by any prospective purchaser. The services, systems and appliances shown have not been tested and no guarantee as to their operability or efficiency can be given.
Made with Metropix ©2024

Martin & Co Hinckley

99-109 Castle Street • • Hinckley • LE10 1DA
T: 01455 636349 • E: hinckley@martinco.com

01455 636349
<http://www.martinco.com>



Accuracy: References to the Tenure of a Property are based on information supplied by the Seller. The Agent has not had sight of the title documents. A Buyer is advised to obtain verification from their Solicitor. Items shown in photographs including but not limited to carpets, fixtures and fittings are not included unless specifically mentioned within the sales particulars. They may however be available by separate negotiation. Buyers must check the availability of any property and make an appointment to view before embarking on any journey to see a property. No person in the employment of the agent has any authority to make any representation about the property, and accordingly any information given is entirely without responsibility on the part of the agents, sellers(s) or lessors(s). Any property particulars are not an offer or contract, nor form part of one. **Sonic / laser Tape:** Measurements taken using a sonic / laser tape measure may be subject to a small margin of error. **All Measurements:** All Measurements are Approximate. **Services Not tested:** The Agent has not tested any apparatus, equipment, fixtures and fittings or services and so cannot verify that they are in working order or fit for the purpose. A Buyer is advised to obtain verification from their Solicitor or Surveyor.