



2 Bedroom Semi-Detached House £260,000

6 Giotto Close, Oakhurst, Swindon, Wiltshire, SN25 2HS

mcfarlane
property.com

2 Bedroom Semi-Detached House North Swindon

- SEMI DETACHED
- TWO DOUBLE BEDROOMS
- SPACIOUS LIVING ROOM
- MODERN KITCHEN DINING ROOM

This WELL PRESENTED, SEMI DETACHED home is situated in popular Oakhurst North Swindon. The property comprising, entrance hall, ground floor CLOAKROOM, modern fitted kitchen/dining room and a spacious living room, TWO DOUBLE BEDROOMS and fitted bathroom. Externally the enclosed, low maintenance rear garden with a GARDEN ROOM with light and power, a perfect home office. To the front, there are 2 parking spaces. This property would represent an ideal first time or investment purchase. Council Tax Band C - Estimated Cost £1,954 p.a.





Ground Floor

Approx. 25.5 sq. metres (274.9 sq. feet)

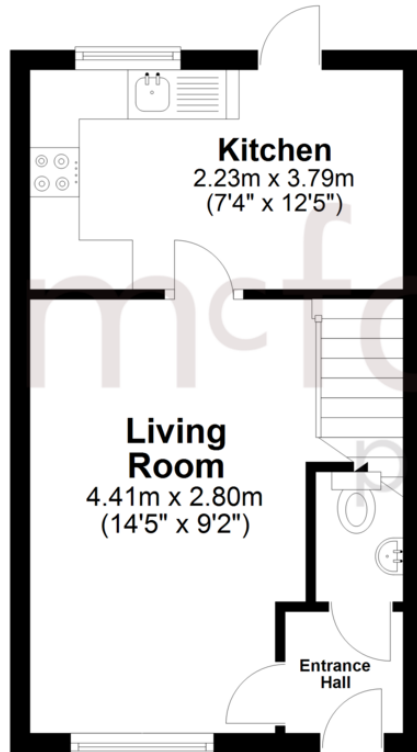

First Floor

Approx. 25.8 sq. metres (277.6 sq. feet)

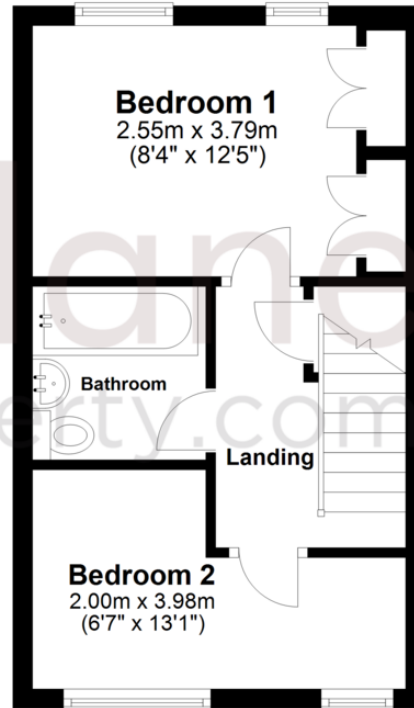

Total area: approx. 51.3 sq. metres (552.5 sq. feet)

We 
where you
LIVE

Our team are friendly, experienced and are all local. They know it better than they do their own living rooms and can help you find what you're looking for because **we love where we live.**

We would be delighted to show you around this property.

**Because every home
needs a personal touch.**

**If you would like to view this
property then please get in touch.**

📞 01793 296600

✉ swindon@mcfarlaneproperty.com

mcfarlaneproperty.com

mcfarlane
property.com

Cricklade.

102 High Street
Cricklade SN6 6AA

📞 01793 751044

Marlborough.

106 High Street
Marlborough SN8 1LT

📞 01672 514380

Old Town.

28-30 Wood Street
Swindon SN1 4AB

📞 01793 296880

Swindon.

The Village Centre,
Redhouse SN25 2FW

📞 01793 296600

Agents Note: Whilst every care has been taken to prepare these sales particulars, they are for guidance purposes only. All measurements are approximate are for general guidance purposes only and whilst every care has been taken to ensure their accuracy, they should not be relied upon and potential buyers are advised to recheck the measurements