



16 Frank Lunnon Close, Bourne End
£350,000



16 Frank Lunnon Close

Bourne End, Bourne End

A terraced house in a secluded position in this highly sought after riverside village. Entrance lobby, Sitting room, Kitchen/Breakfast room, Two bedrooms, Bathroom, Electric heating, Garden, Allocated parking. NO CHAIN.

Council Tax band: D

Tenure: Freehold

Entrance lobby

Storage heater, stairs to first floor

Sitting room

Storage heater, under stairs storage cupboard, window to front, double doors to Kitchen

Kitchen/Breakfast room

Fitted with a range of eye and base level units incorporating stainless steel sink unit with mixer tap and drainer, built in John Lewis double oven, fitted four ring hob with stainless steel splashback and extractor over, space for fridge/freezer, space and plumbing for washing machine, space for table, electric heater, part tiled walls, window to rear, door to garden





First floor

Landing

Access to loft space, storage cupboard

Bedroom 1

Electric heater, built in wardrobe, airing cupboard housing foam clad hot water cylinder and shelved storage, window to front

Bedroom 2

Electric heater, window to rear

Bathroom

White suite comprising panelled bath with mixer tap and shower attachment, low level W.C., wash hand basin, heated towel rail, part tiled walls, window to rear

Parking

There is one allocated parking space

Rear garden

A paved patio leads to the remainder of garden which is laid to lawn with flower and shrub borders. There is a timber shed and all is enclosed by panelled fencing. The garden enjoys a sunny south westerly aspect and extends to 35'.



Approximate Gross Internal Area
Ground Floor = 25.8 sq m / 278 sq ft
First Floor = 25.6 sq m / 275 sq ft
Total = 51.4 sq m / 553 sq ft

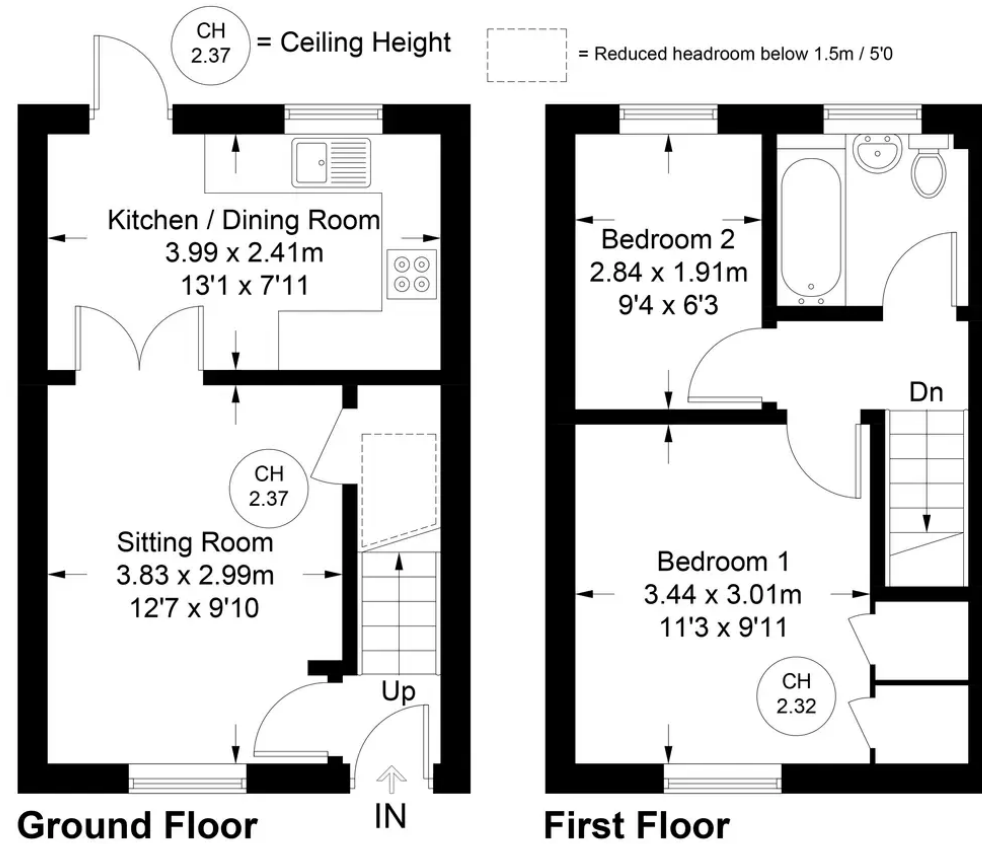

Floor Plan produced for Robertsons by Media Arcade ©.

Illustration for identification purposes only. Window and door openings are approximate. Whilst every attempt is made to assure accuracy in the preparation of this plan, please check all dimensions, shapes and compass bearings before making any decisions reliant upon them.



Robertsons