

£875 pcm

Stonea Farm Cottages, Sixteen Foot Bank,
Stonea, March, Cambridgeshire PE15 0DU



To arrange a viewing call us now on 01354 694900

Deposit £1,009

Available now, this rurally located three bedroom semi detached house is set on a lovely plot surround by field views.

The accommodation comprises kitchen, separate living and dining rooms, ground floor bathroom and three good size bedrooms.

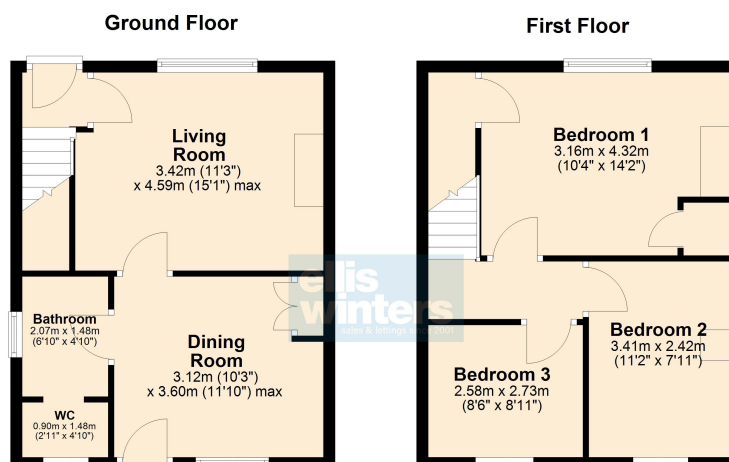

£875 pcm

Stonea Farm Cottages, Sixteen Foot Bank,
Stonea, March, Cambridgeshire PE15 0DU



GROUND FLOOR

Kitchen
3.49m (11'5") x 2.29m (7'6")

Living Room
4.59m (15'1") max. x 3.42m (11'3")

Dining Room
3.60m (11'10") max. x 3.12m (10'3")

Bathroom
2.07m (6'10") x 1.48m (4'10")

WC
1.48m (4'10") x 0.90m (2'11")



FIRST FLOOR

Bedroom 1
4.32m (14'2") x 3.16m (10'4")

Bedroom 2
3.41m (11'2") x 2.42m (7'11")

Bedroom 3
2.73m (8'11") x 2.58m (8'6")



OUTSIDE

There is a good size garden to the side and rear which is well established. There is parking to the front for two vehicles.



PLEASE NOTE

There is a monthly charge of £15 for water payable to the Landlord.

Also the cost of emptying the septic tank once a year is shared with 2 other neighbours.

INITIAL LENGTH OF TENANCY

6 months

Fenland District Council Tax band TBC
Energy rating E



Ellis Winters & Co 20 Market Hill, Chatteris, Cambridgeshire, PE16 6BA
Tel: 01354 694900 Email: info@elliswinters.co.uk www.elliswinters.co.uk