



**SALES**

**LETTINGS**

**MANAGEMENT**

[chiswick@tatepartnership.co.uk](mailto:chiswick@tatepartnership.co.uk)

**020 8996 0000**

**TATEPARTNERSHIP.CO.UK**



**Chiswick W4**

**£2,350 pcm**

"A CHARMING GROUND FLOOR APARTMENT WITH DIRECT GARDEN ACCESS". Be the first to occupy this freshly decorated, well balanced accommodation, extending to 672 sq/ft (62.4m<sup>2</sup>). Comprising; enclosed entrance porch with front door into entrance hall, guest cloakroom/WC, Shaker style kitchen with back door onto shared garden, generous living room, main double bedroom with fitted wardrobes, second smaller double bedroom (or office), family bathroom. Direct access to generous shared back garden. Chiswick Park Station and Chiswick High Road are within 10mins walking, Turnham Green tube within 15mins. Available now, part furnished.

### Evelyn Road, W4

Approximate Gross Internal Area = 62.4 sq m / 672 sq ft

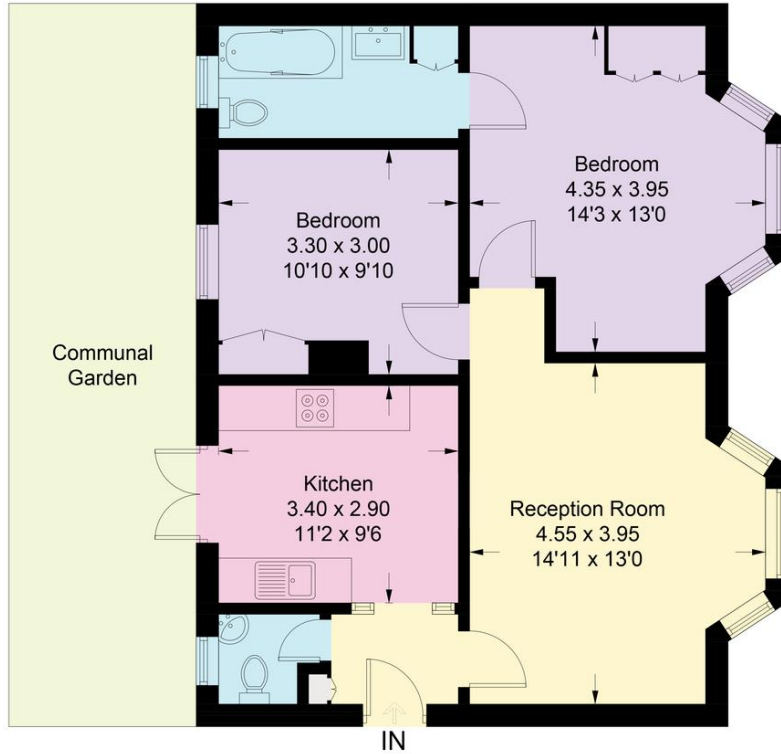

Illustration for identification purposes only, measurements are approximate, not to scale. floorplansUsketch.com © (ID1063700)

## EPC

