



MILE



Crouch Road, London NW10

£2,800 pcm

Discover this stunning mid-terraced house, an epitome of modern living and comfort. With over 1040 sq ft of spacious interiors, this newly refurbished home offers four to five versatile bedrooms, perfect for a growing family or accommodating guests.

Available now and in excellent condition, this home is ready for you to move in and make it your own. Embrace the blend of space, style, and tranquility in this exceptional property – your perfect sanctuary awaits!

- Mid-terraced house
- Four/Five bedrooms
- South facing garden
- Available now!
- Spacious
- Excellent condition
- Newly refurbished
- Quiet residential road
- Over 1040 sq ft
- Close to shops and transport



Crouch Road, NW10

CAPTURE DATE 11/10/2022 LASER SCAN POINTS 51,376,315

GROSS INTERNAL AREA

96.74 sqm / 1041.30 sqft

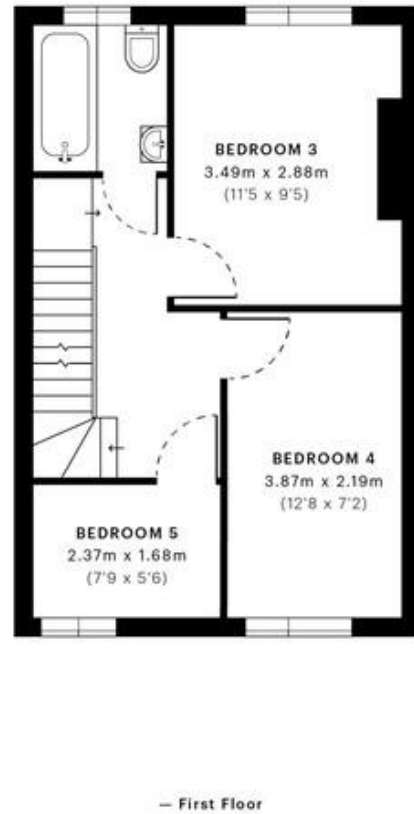
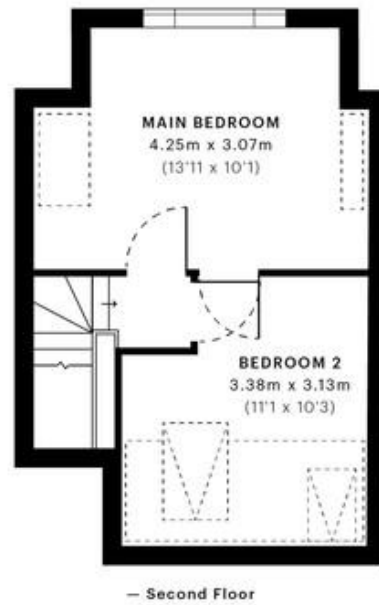
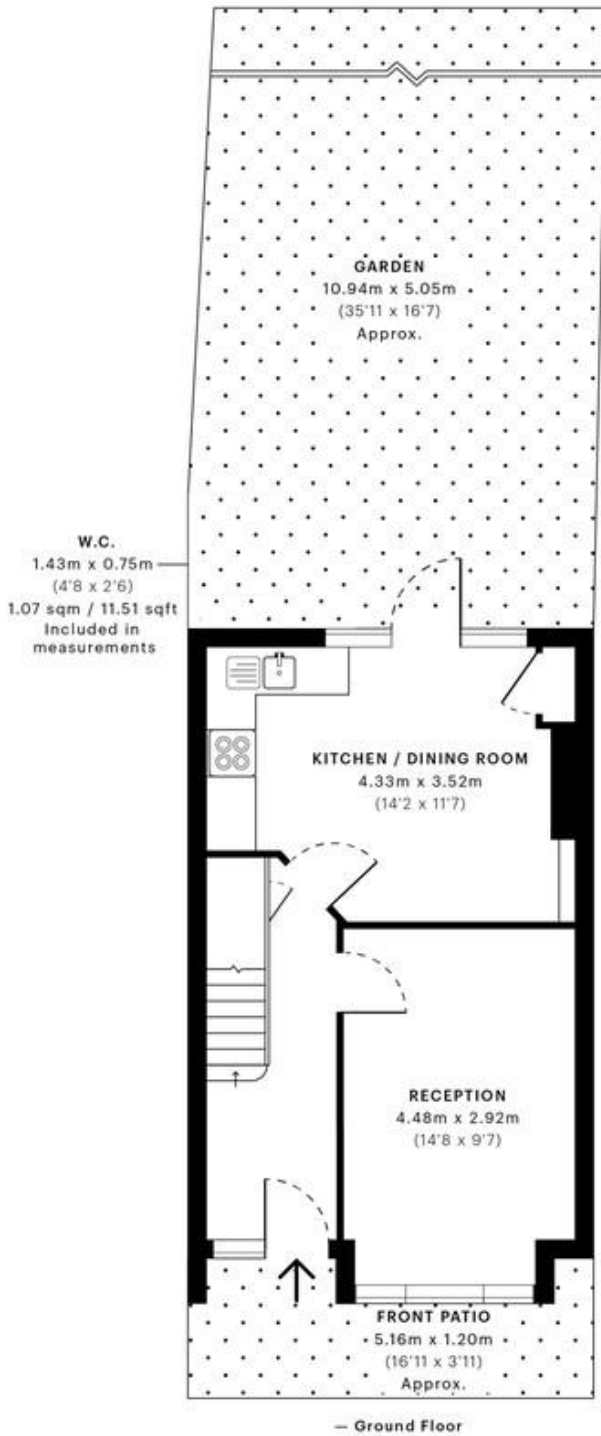

Spec Verified floor plans are produced in accordance with

RICS 36 Residential, 11/16 sqm / 120.45 sqft

MONEY LAUNDERING REGULATIONS 2003: Intending purchasers will be asked to produce identification documentation at a later stage and we would ask for your co-operation in order that there will be no delay in agreeing the sale.

General: While we endeavour to make our sales particulars fair, accurate and reliable, they are only a general guide to the property and, accordingly, if there is any point which is of particular importance to you, please contact the office and we will be pleased to check the position for you, especially if you are contemplating travelling some distance to view the property.

Measurements: These approximate room sizes are only intended as general guidance. You must verify the dimensions carefully before ordering carpets or any built-in furniture.

Services: Please note we have not tested the services or any of the equipment or appliances in this property, accordingly we strongly advise prospective buyers to commission their own survey or service reports before finalising their offer to purchase.