



dm^g
DAVID MARTIN
GROUP

Thyme Road
Tiptree, CO5 0TE

£170,000
EPC Rating 'TBC'

- Ground Floor Flat
- Bedroom & Study
- Private Garden
- NO ONWARD CHAIN





Property Description

David Martin Estate Agents are delighted to offer for sale this one bedroom ground floor flat with STUDY and private GARDEN centrally situated in the popular village of Tiptree with its excellent range of shops and local amenities. The property consists of an entrance hall, spacious lounge, kitchen, double bedroom, study, bathroom and a private garden to the rear of the property. The property is being sold CHAIN free, call now to arrange a viewing.



ENTRANCE HALL

Laminate flooring, radiator, built in cupboard.

LOUNGE

13' 03" x 10' 03" (4.04m x 3.12m) Windows to front and side, radiator, laminate flooring, built in cupboard.

KITCHEN

9' 10" x 8' 10" (3m x 2.69m) Fitted with a range of wall and base units incorporating a sink with drainer and mixer tap, space for free standing cooker, washing machine and fridge/freezer, tiled splash back, laminate flooring, radiator, window to rear.



BEDROOM

10' 03" x 10' 02" (3.12m x 3.1m) Window to front, radiator, built in wardrobe.

BATHROOM

Window to rear, panel enclosed bath with shower attachment, low level W.C, hand wash basin, fully tiled, radiator, window to rear.

STUDY

6' 03" x 4' 03" (1.91m x 1.3m) Window to rear, radiator.

GARDEN

Enclosed garden to the rear of the property.



GROUND FLOOR
493 sq.ft. (45.8 sq.m.) approx.

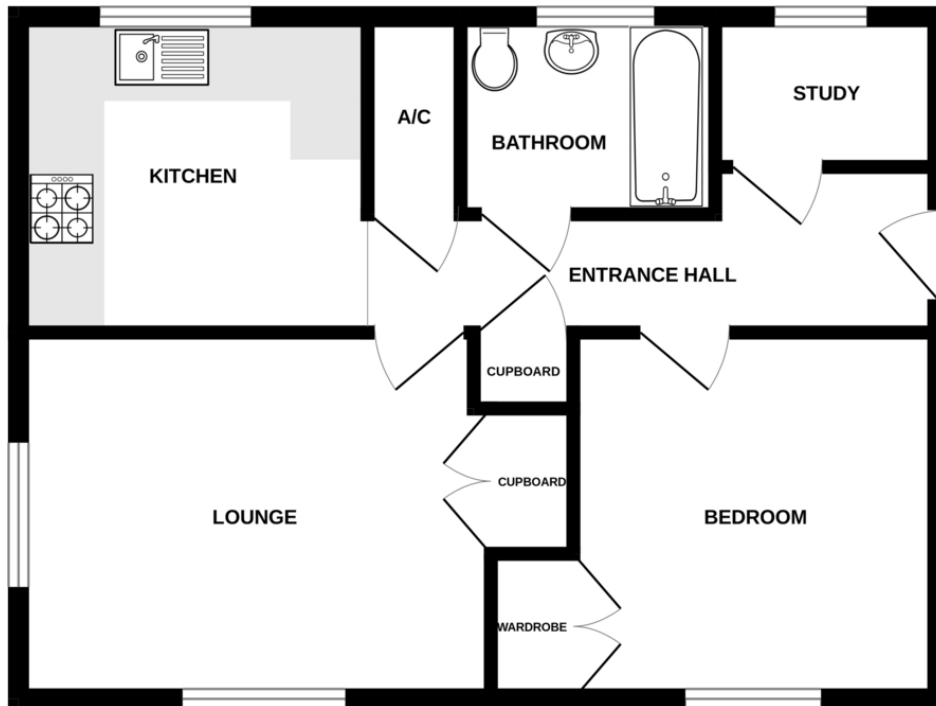

TOTAL FLOOR AREA: 493 sq.ft. (45.8 sq.m.) approx.

Whilst every attempt has been made to ensure the accuracy of the floorplan contained here, measurements of doors, windows, rooms and any other items are approximate and no responsibility is taken for any error, omission or mis-statement. This plan is for illustrative purposes only and should be used as such by any prospective purchaser. The services, systems and appliances shown have not been tested and no guarantee as to their operability or efficiency can be given.
Made with Metropix ©2024



David Martin
35a Church Road
Tiptree
Colchester
Essex

www.dmgtiptree.co.uk
%office_emailAddress%
01621 815815

Agents Note: Whilst every care has been taken to prepare these sales particulars, they are for guidance purposes only. All measurements are approximate are for general guidance purposes only and whilst every care has been taken to ensure their accuracy, they should not be relied upon and potential buyers are advised to recheck the measurements