

**Flat 3 Kingswells Avenue
Kingswells**

Ground Floor

Approx. 50.8 sq. metres (546.7 sq. feet)

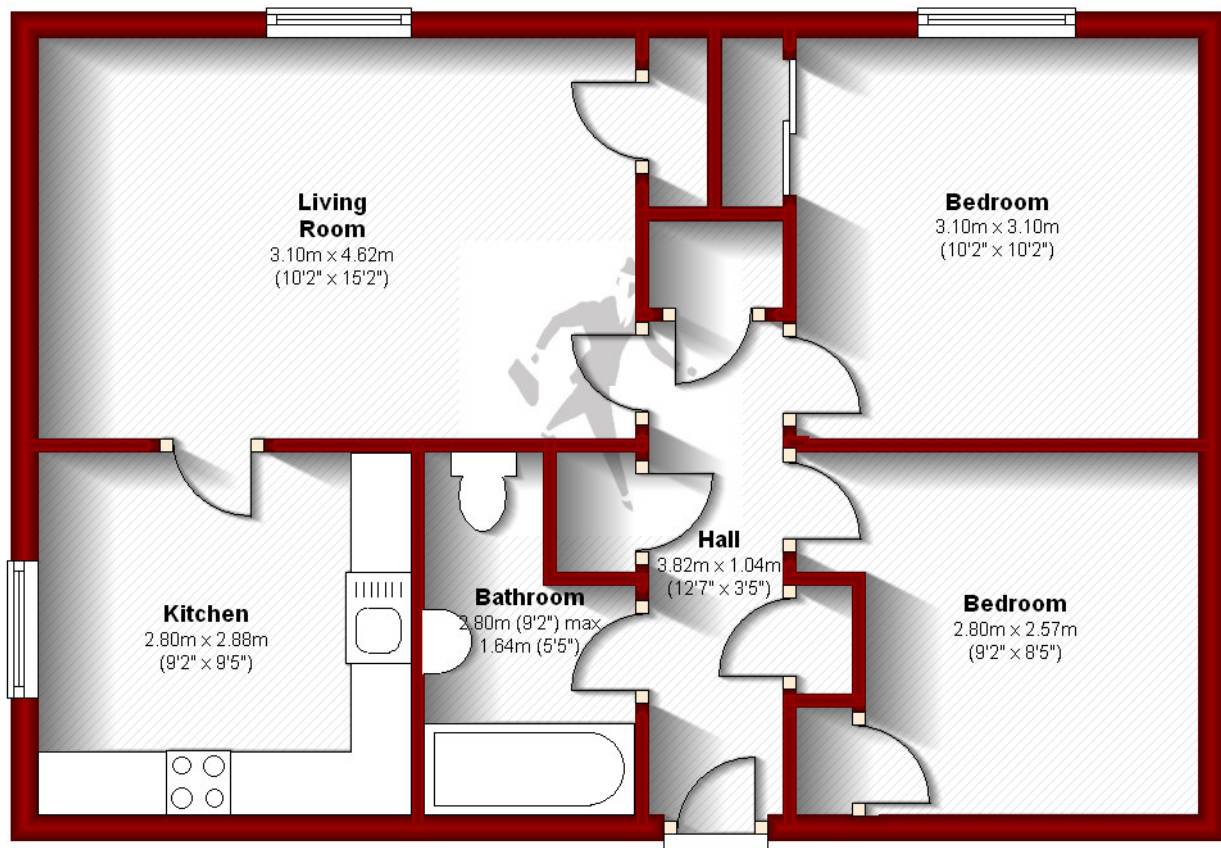

Total area: approx. 50.8 sq. metres (546.7 sq. feet)

The above particulars are for guidance only, no liability for any errors or omissions will be accepted by Aberdeen Property Leasing Ltd.