



43 Pennyholme Close | Kiveton Park | S26 6PT

Guide Price £230,000 - £240,000

Bell & Co Estates are delighted to present this THREE Bedroom, DETACHED Home on the sort-after street of Pennyholme Close in KIVETON PARK. Tucked away in the corner of this quiet street, with STUNNING VIEWS, this property makes the perfect family home. The property comprises of; Entrance Hallway which gives access to the Lounge overlooking the front of the property, this gives access into the Dining Room with patio doors into the CONSERVATORY which overlooks the garden, through the dining room is the Kitchen with store cupboard and door giving access to the side of the property. Upstairs is the MODERN shower room and Three GOOD-SIZE Bedrooms, bedroom two boasting fitted wardrobes. To the outside the front has a paved driveway providing OFF ROAD PARKING for multiple vehicles, leading to the DETACHED GARAGE, a side gate gives access to the ENCLOSED REAR GARDEN with decking area. This property would make the perfect family home, close to local amenities, transport links and schools means this home really does have it all.

- Three Bedroom Detached
- Three Reception Rooms
- Conservatory
- Detached Garage
- Off Road Parking
- Enclosed Rear Garden
- Stunning Views
- Family Home
- Great Location

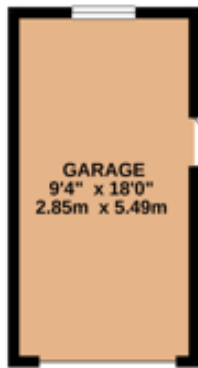

1ST FLOOR
387 sq.ft. (35.9 sq.m.) approx.

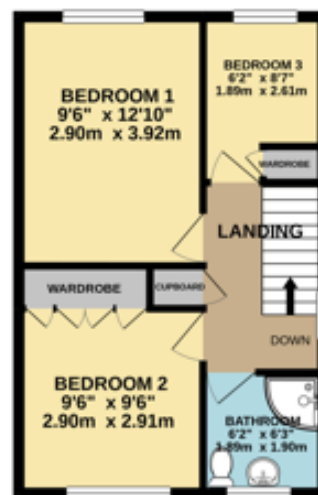

Contact Details

79 Wales Road
Kiveton Park
Sheffield
South Yorkshire
S26 6RA

www.bellcoestates.com

03333 580590

43, Pennyholme Close
Kiveton Park
SHEFFIELD
S26 6PT

Energy rating

D

Valid until
3 March 2025

Certificate number
0148-3054-7297-3535-7990

Property type Detached house

Total floor area 73 square metres

Agents Note: Whilst every care has been taken to prepare these sales particulars, they are for guidance purposes only. All measurements are approximate and are for general guidance purposes only and whilst every care has been taken to ensure their accuracy, they should not be relied upon and potential buyers are advised to recheck the measurements