

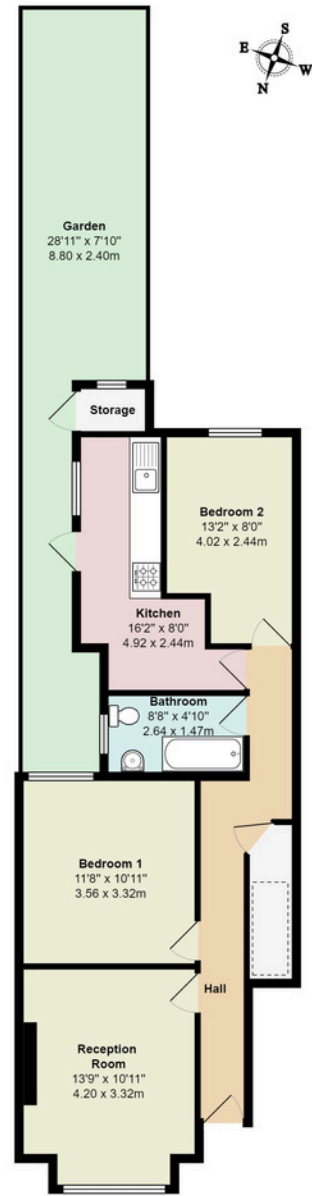

Montagu Road NW4
Total Area: 665 ft² ... 61.8 m²



Tenure Leasehold



665 sq. ft. (61.8 m²).



2 Bedrooms



1 Bathrooms



Permit

Score	Energy rating	Current	Potential
92+	A		
81-91	B		
69-80	C	71 C	78 C
55-68	D		
39-54	E		
21-38	F		
1-20	G		

Montagu Road, Hendon, NW4

£425,000

Exclusive listing: Charming two-bedroom ground floor garden maisonette in a Victorian terrace house, extending to 665 sq. ft. (61.8 m²).

Features a private entrance, reception room with bay window, kitchen with integrated units and exterior door, two spacious bedrooms, and a bathroom with a window.

Includes a fully enclosed private rear garden with a storage shed.

Conveniently located half a mile from Hendon tube station, minutes from Hendon Overground, and close to schools, Brent Cross shopping centre, and Malcolm Park.

TENURE: Leasehold

LEASE LENGTH: 147 years remaining



903-905 Finchley Road Golders Green London NW11 7PE

Telephone 020 8381 4970 Email info@moreland.uk.com

Registered Office Unit 8, Alpha Business Park, Travellers Close, Welham Green AL9 7NT Registered in England No. 3663497 Vat No. 701775936

Residential Sales Lettings Full Management Financial Services New Homes



