



Lomond Close

Coton Green, Tamworth, Staffordshire, B79 8ET

£236,500

Property Features

- Attractive Semi-Detached Home
- Entrance Hall
- Open Living Room
- Dining Area
- Re-Fitted Kitchen
- Conservatory
- Three Bedrooms
- Family Bathroom
- Rear Garden
- Driveway & Garage

Full Description

Taylor Cole Estate Agents are please to bring you this attractive and well presented three bedroom semi-detached residence which occupies a private position within this cul-de-sac setting. The property, which is available with no onward chain, comprises of an entrance hall, open living area, dining area, re-fitted kitchen, conservatory, three bedrooms and family bathroom. The rear garden allows for out door seating and entertainment space, along with swift access to the garage located to the side of the property. The garage can also be accessed from the driveway which continues from the front and along the side aspect.

ANTI MONEY LAUNDERING

In accordance with the most recent Anti Money Laundering Legislation, buyers will be required to provide proof of identity and address to the Taylor Cole Estate Agents once an offer has been submitted and accepted (subject to contract) prior to Solicitors being instructed.

TENURE

We have been advised that this property is freehold, however, prospective buyers are advised to verify the position with their solicitor / legal representative.

VIEWING

By prior appointment with Taylor Cole Estate Agents on the number provided.





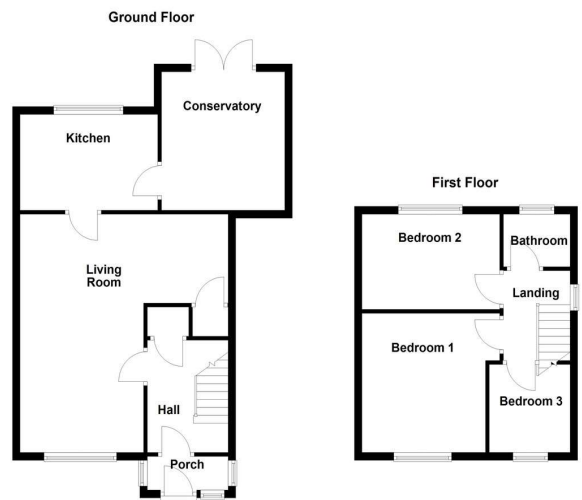

Score	Energy rating	Current	Potential
92+	A		
81-91	B		86 B
69-80	C		
55-68	D		
39-54	E	51 E	
21-38	F		
1-20	G		

8 Victoria Road
 Tamworth
 Staffordshire
 B79 7HL

www.taylorcole.co.uk
 sales@taylorcole.co.uk
 01827 311412

Agents Note: Whilst every care has been taken to prepare these sales particulars, they are for guidance purposes only. All measurements are approximate and for general guidance purposes only and whilst every care has been taken to ensure their accuracy, they should not be relied upon and potential buyers are advised to recheck the measurements