



Flat 104, Wordsworth Court Middlefield, Hatfield

£1,400 pcm

Duplex Maisonette • Two Bedrooms • Modern Kitchen • Family Bathroom • Allocated Parking Bay • Communal Garden • Close To Town Centre • Unfurnished • Available September • EPC Rating - E

KINGS
SALES LETTINGS MANAGEMENT

Ground Floor

Approx. 27.9 sq. metres (300.5 sq. feet)

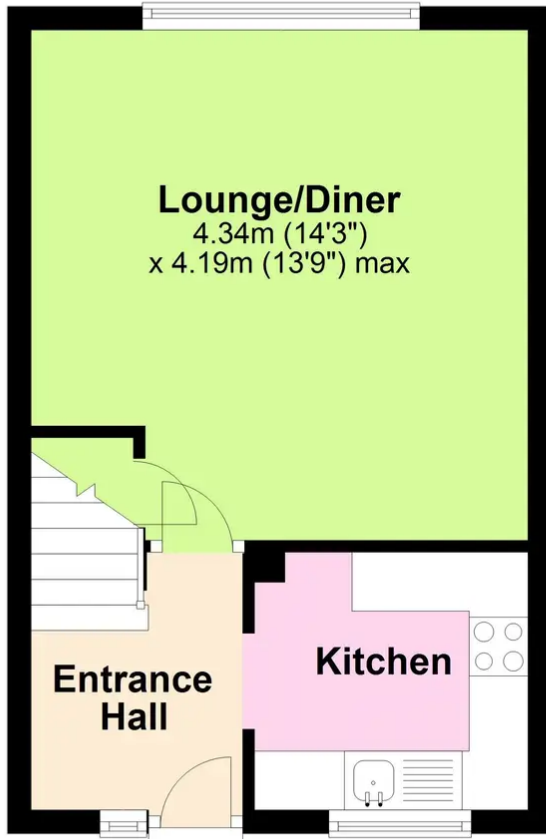

First Floor

Approx. 28.3 sq. metres (304.1 sq. feet)

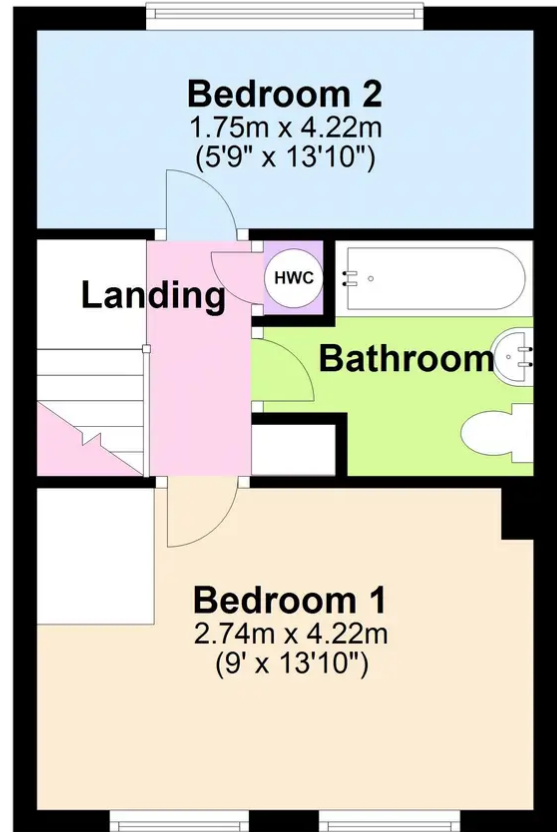

Total area: approx. 56.2 sq. metres (604.6 sq. feet)

You can include any text here. The text can be modified upon generating your brochure.

