

FOR SALE



High Street, Skelton

3 Bedrooms, 1 Bathroom, End Terraced House

£60,000

MARTIN&CO



GROUND FLOOR

High Street, Skelton
3 Bedrooms, 1 Bathroom
£60,000

LOUNGE/DINER 10' 8" x 17' 10" (3.26m x 5.44m) To front aspect. marble fire surround incorporating gas fire, two uPVC windows.

DINING ROOM 12' 8" x 11' 6" (3.88m x 3.52m) To rear aspect.

ENTRANCE 10' 8" x 17' 10" (3.26m x 5.44m) uPVC entrance door leading straight into lounge/dining room.

- Ideal investment opportunity
- Close to high street
- Great potential
- Lounge/dining
- Three good size bedrooms

KITCHEN 18' 9" x 6' 2" (5.74m x 1.88m) To rear aspect. Range of wall, base and drawer units, 1.5 bowl stainless steel inset sink unit, tiled splash backs, laminate work surfaces and door leading to rear yard.

FIRST FLOOR

LANDING With loft access.

BATHROOM With uPVC window.

BEDROOM ONE 12' 7" x 10' 3" (3.85m x 3.13m) To front aspect.

BEDROOM TWO 12' 6" x 7' 1" (3.83m x 2.16m) To front aspect.

BEDROOM THREE 11' 1" x 11' 6" (3.39m x 3.53m) To rear aspect. With loft access.

EXTERNALLY

REAR YARD To rear access. With off road parking.



FULL DICRIPTION Martin & Co welcome to the market this ideal investment opportunity on the edge of a village location. This property has a loads of potential to



an investor or a first time buyer who would like a project. Consists of; Large lounge/dining room, kitchen, bathroom and three large bedrooms. Outside space to the rear has the potential to become off road parking and/or seating area.

To arrange a viewing please call Martin & Co on 01287 631254

%epcGraph_c_1_210%

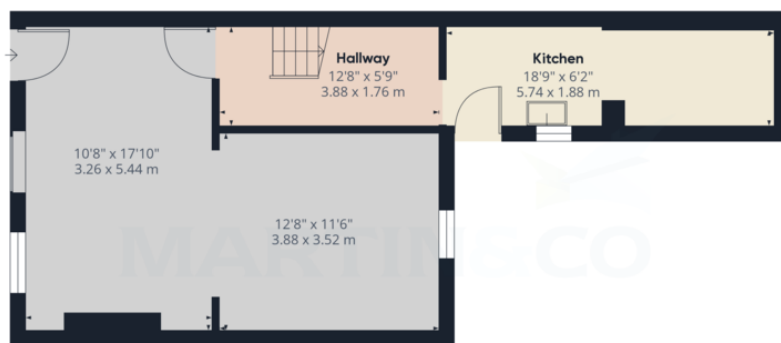

Ground Floor

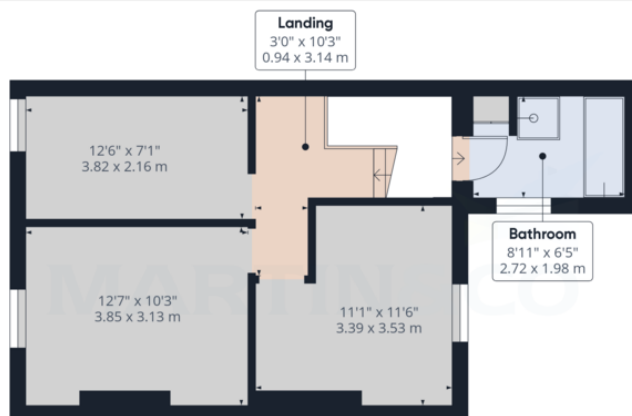

Floor 1

Approximate total area[#]

969.41 ft²

90.06 m²

(1) Excluding balconies and terraces

While every attempt has been made to ensure accuracy, all measurements are approximate, not to scale. This floor plan is for illustrative purposes only.

GIRAFFE360

Martin & Co Guisborough

83 Westgate • • Guisborough • TS14 6AF
T: 01287 631254 • E: Guisborough@martinco.com

01287 631254

<http://www.martinco.com>

Accuracy: References to the Tenure of a Property are based on information supplied by the Seller. The Agent has not had sight of the title documents. A Buyer is advised to obtain verification from their Solicitor. Items shown in photographs including but not limited to carpets, fixtures and fittings are not included unless specifically mentioned within the sales particulars. They may however be available by separate negotiation. Buyers must check the availability of any property and make an appointment to view before embarking on any journey to see a property. No person in the employment of the agent has any authority to make any representation about the property, and accordingly any information given is entirely without responsibility on the part of the agents, sellers(s) or lessors(s). Any property particulars are not an offer or contract, nor for part of one. **Sonic / laser Tape:** Measurements taken using a sonic / laser tape measure may be subject to a small margin of error. **All Measurements:** All Measurements are Approximate. **Services Not tested:** The Agent has not tested any apparatus, equipment, fixtures and fittings or services and so cannot verify that they are in working order or fit for the purpose. A Buyer is advised to obtain verification from their Solicitor or Surveyor.