



## ROBINSON WAY, CHESTER

OFFERS IN EXCESS OF £190,000

- CITY CENTRE LOCATION
- DEDICATED PARKING SPACE
- BALCONY OVER LOOKING THE CANAL AND SHOT TOWER
- LUXURY LIVING
- TAX BAND B
- MUST BE VIEWED

# ROBINSON WAY, CHESTER, CH1 3FA



IMPRESSIVE CITY CENTRE APARTMENT FOR THOSE WHO ENJOY LUXURY LIVING. Discover modern, urban living at its finest with this luxurious 1 bedroom apartment located in the heart of Chester City Centre.

As you step inside, you're greeted by a well proportioned entrance hallway which provides access to all the principle rooms including; an open plan kitchen dining area which seamlessly blends contemporary design with functionality, a coat cupboard with further storage, stylish bathroom with floor to ceiling tiles and a good sized bedroom with ample storage. Natural light floods throughout this home, enhancing the warm and inviting atmosphere it has to offer. Sliding glass doors lead you to a balcony overlooking the canal and views of the Shot Tower, which is the only surviving leadworks of its kind dating back to the 18th century - the perfect place for you to unwind.

Another standout features of this apartment is the convenience of City Centre parking. With everything you need on your doorstep, including a variety of shops, bars & restaurants, fantastic green spaces including Grosvenor park & Chester meadows what more could you want? And as if it couldn't get any better, there are excellent transport links and Chester train station within walking distance.

Must be viewed to be truly appreciated, book your viewing today before it's too late

Service Charge (PA) £1,140

Ground Rent (PA) £156

There is 122 years left on the lease





# ROBINSON WAY, CHESTER, CH1 3FA



## **Council Tax:**

Band B

## **Local Authority:**

Cheshire West and Chester Council

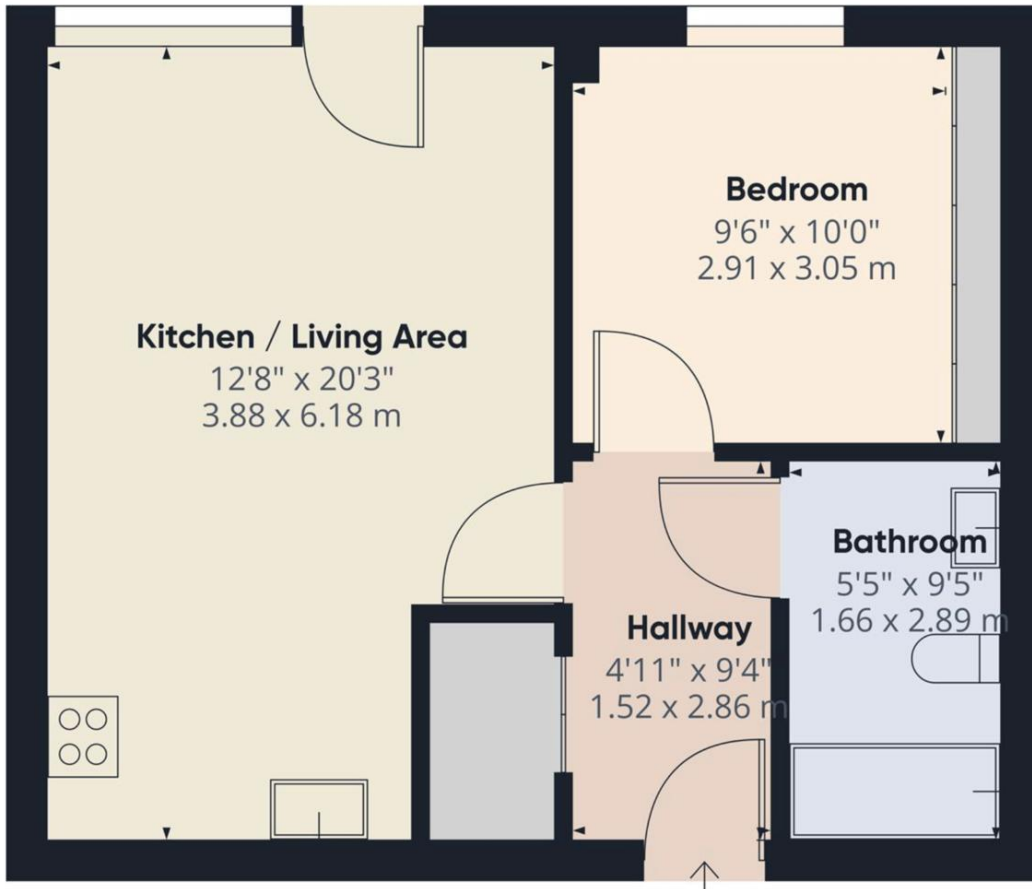

Score	Energy rating	Current	Potential
92+	A		
81-91	B	86 B	86 B
69-80	C		
55-68	D		
39-54	E		
21-38	F		
1-20	G		

**OFFICE CONTACT INFO**

Urban Sale and Let  
 19 Charles Street  
 Hoole  
 Chester  
 Cheshire  
 CH2 3AY

01244350300  
 info@urbansaleandlet.co.uk  
 www.urbansaleandlet.co.uk

Agents Note: Whilst every care has been taken to prepare these particulars, they are for guidance purposes only. All measurements are approximate, and are for general guidance purposes only and whilst every care has been taken to ensure their accuracy, they should not be relied upon and potential buyers/tenants are advised to recheck the measurements