



7 Miller Street

Harthill, Shotts, ML7 5SH





Property Summary

Situated in the rural village of Harthill, this two-bedroom semi-detached bungalow is a charming residence, which offers proximity to the countryside and a near-equal commute to Edinburgh and Glasgow. The home provides buyers with an appealing blank canvas too, as well as bright and spacious rooms. It also has private parking for at least two cars and it boasts a mature rear garden, with a suntrap, south-facing aspect.

Extras: all fitted floor and window coverings, light fittings, electric cooker, fridge/freezer, and washing machine to be included in the sale.



Property Features

- Well-presented semi-detached bungalow
- Convenient location in Harthill village
- Near amenities, transport links and schools
- Crisp white interiors throughout
- Entrance vestibule and hall with storage
- Living room with a log burner
- Monochrome-inspired dining kitchen
- Two bright and airy double bedrooms
- Tiled bathroom with handheld shower
- Well-maintained front and rear gardens
- Private driveway and detached garage
- Gas central heating and double glazing
- EPC Rating - D



Floorplan

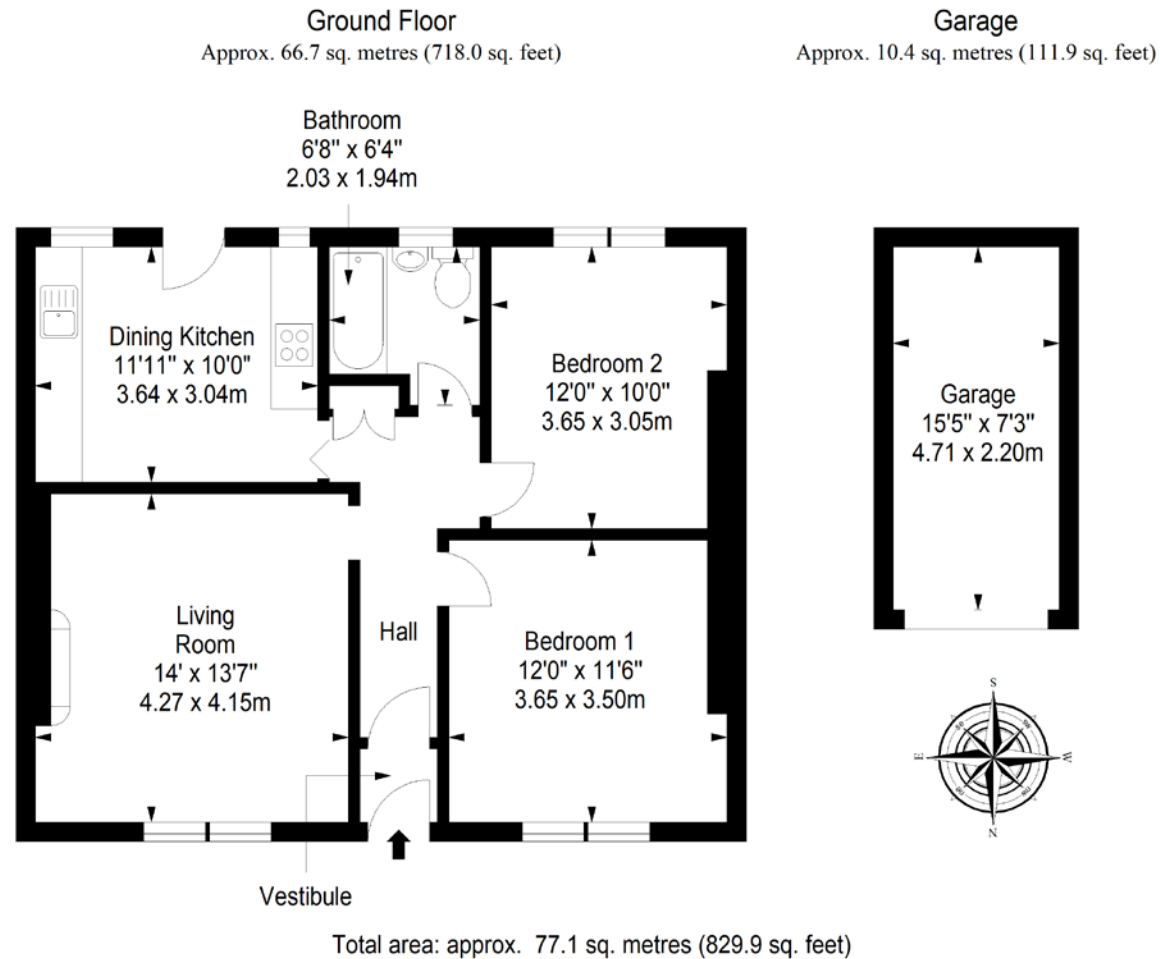

All Enquiries to our Property Department:

Afton Henderson | ah@sneddons-ssc.co.uk | 01506 815832 | www.sneddonmorrison.co.uk
14 East Main Street, Whitburn, West Lothian EH47 0RB

IMPORTANT: The selling agents for themselves and for the sellers of the above property give notice that these particulars are for guidance only and their accuracy is not guaranteed. These particulars will not form part of any contract and interested parties should satisfy themselves in all aspects prior to submitting offers. The sellers do not bind themselves to accept the highest offer. S1106