



2 Regent Place, Southsea
Southsea

Offers in Region of £340,000

 chinneckshaw



2 Regent Place

Southsea, Southsea

Welcome to this delightful Coach House Mews Cottage, nestled in the highly sought-after Regent Place, just off Castle Road in Southsea. This characterful property seamlessly blends period charm with modern living, offering a warm and inviting atmosphere throughout.

Upon entering, you are greeted by an entrance lobby featuring elegant wood-block flooring and a built-in storage cupboard. Inner doors lead you into the spacious living/dining area, where the wood-block flooring continues to flow seamlessly. The central brick-lined fireplace, flanked by storage on either side of the chimney breast, adds a cozy focal point to this lovely living space.

A bright inner hallway provides access to the first floor, kitchen, and courtyard. The kitchen is a modern culinary delight with a sleek gloss white finish, complemented by metro tiles, ample base and wall cabinets, worktops, and space for your appliances. The contemporary feel is enhanced by four spotlights in the ceiling.

Ascending to the first floor, a bright hallway illuminated by a large Velux window above the staircase leads you to the rest of the home. The rear bathroom is a serene retreat, featuring a white suite, bath with shower over, spotlights, and sandstone-colored tiles, all bathed in natural light from another Velux window.

The two bedrooms, situated at the front of the cottage, boast original wood flooring and made-to-measure shutters, perfectly blending the old with the new. These rooms offer a peaceful sanctuary for rest and relaxation..



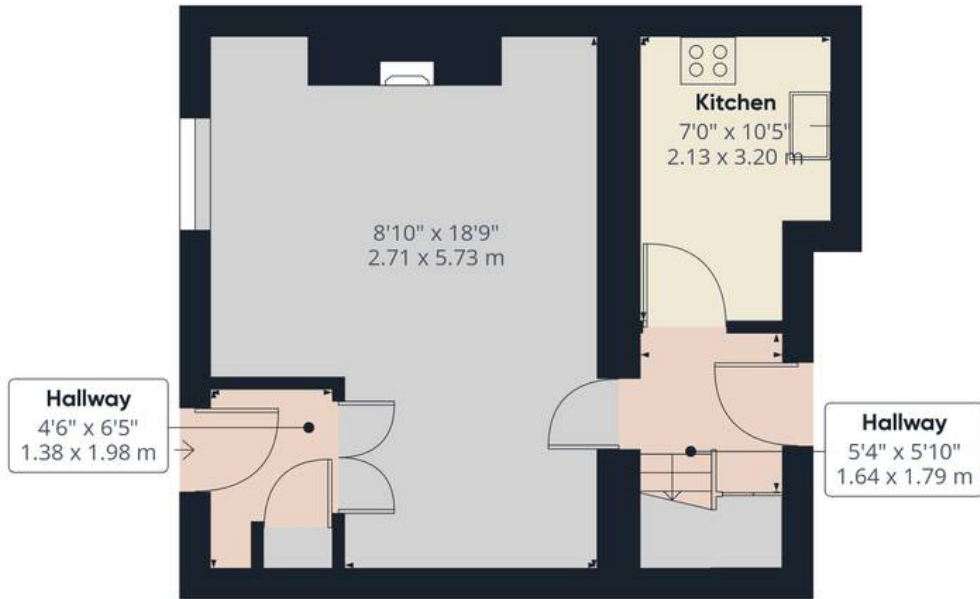

Ground Floor

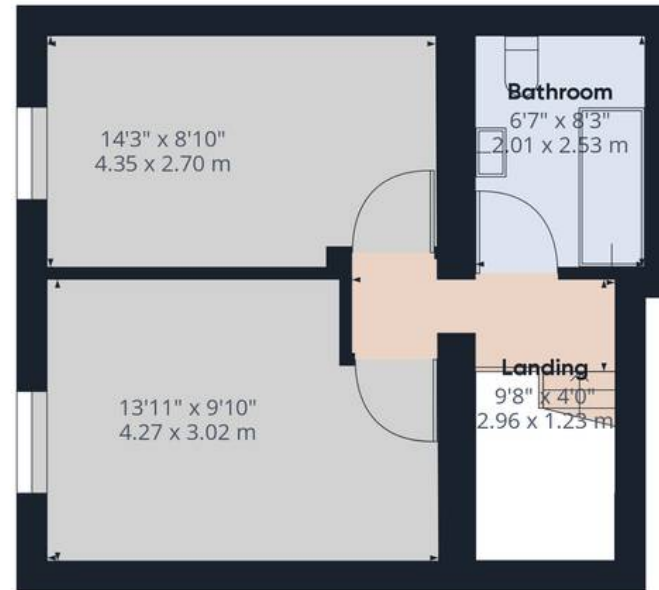

Floor 1

Approximate total area⁽¹⁾

721.99 ft²

67.08 m²

(1) Excluding balconies and terraces

While every attempt has been made to ensure accuracy, all measurements are approximate, not to scale. This floor plan is for illustrative purposes only.

GIRAFFE360



Chinneck Shaw

Bridge House, Milton Road, Portsmouth – PO3 6AN

023 9282 6731

hello@chinneckshaw.co.uk

www.chinneckshaw.co.uk/

Chinneck Shaw, Bridge House, Milton Road, PO3 6AN Consumer Protection from Unfair Trading Regulations 2008: These details are for guidance only and complete accuracy cannot be guaranteed. If there is any point which is of particular importance, verification should be obtained. The do not constitute a contract or part of a contract. All measurements are approximate. No guarantee can be given with regard to planning permissions or fitness for purpose. No apparatus, equipment, fixture or fitting has been tested. Items shown in the photographs are NOT necessarily included. Interested Parties are advised to check availability and make an appointment to view before travelling to see a property.