

Ashburton Road

Hugglescote, Coalville, LE67 2HE

John 
German





Mileo

Ashburton Road

Hugglescote, Coalville, LE67 2HE

£325,000

This home exudes charm and comfort and would be a dream first time home. Peppered with original features and stylish touches throughout and offering spacious sitting room, living room and snug, coupled with extensive drive, garage and large private landscaped garden.

Step into the property and you will find yourself in a gorgeous detached Edwardian residence, more than just a home, it's a piece of history, lovingly updated to offer all the comforts of modern living, while retaining its enchanting character. Here every detail has been carefully considered, every space thoughtfully designed creating a harmonious blend of past and present that makes this property truly unique.

As you enter the front door, you are greeted by a feature reception hallway with original restored Minton tiled floor. On your left is the first of three reception rooms, a cosy dining room with original bay window and cornice to the ceiling.

Next is the living room, a wonderful living space with dual aspect windows, wood parquet flooring underfoot and an amazing focal point provided by a feature period style fireplace with tiled cheeks, raised slate hearth and inset log burning stove.

Onwards then to the snug, another lovely reception room with bay window to the side, door to the side, rustic slate floor and a warming log burning stove completing the picture.

Next there is a useful utility/WC, and on through the corridor to the fitted kitchen where base and wall mounted cabinets wrap around the room providing plenty of storage, with integral hob, oven and dishwasher. French double doors take you out onto the pretty pergola covered terrace perfect for morning coffee.

The bedrooms in this home are both spacious doubles and both feature lovely period style fireplaces. The principal bedroom also benefits from having fitted wardrobes along one wall.

The family bathroom is just fabulous, spacious and well appointed with separate shower, WC, pedestal wash band basin and corner bath. It has coving to the ceiling and a cast iron feature fireplace.

Outside is an extensive driveway with oversized garage that has light, power and personal door to the rear garden. The garden is a real highlight having large composite decked patio area with timber pergola above, lawn with mature borders enjoying great privacy and a lower kitchen garden area behind trellis screening with greenhouse.

Tenure: Freehold (purchasers are advised to satisfy themselves as to the tenure via their legal representative).

Property construction: Standard

Parking: Drive & garage

Electricity supply: Mains

Water supply: Mains

Sewerage: Mains

Heating: Gas

(Purchasers are advised to satisfy themselves as to their suitability).

Broadband and type: See Ofcom link for speed: <https://checker.ofcom.org.uk/>

Mobile signal/coverage: See Ofcom link <https://checker.ofcom.org.uk/>

Local Authority/Tax Band: North West Leicestershire District Council / Tax Band C

Useful Websites: www.gov.uk/government/organisations/environment-agency

<https://www.gov.uk/check-if-property-is-affected-by-coal-mining>

Our Ref: JGA/02072024





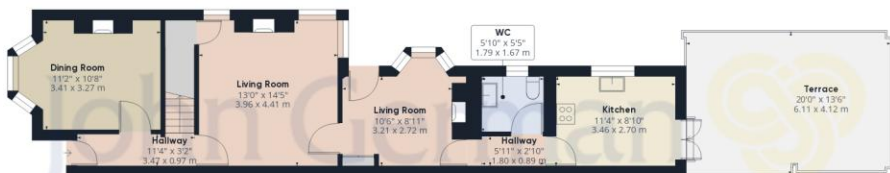

Ground Floor Building 1



Floor 1 Building 1



Ground Floor Building 2

Approximate total area⁽¹⁾

1374.65 ft²

127.71 m²

(1) Excluding balconies and terraces

While every attempt has been made to ensure accuracy, all measurements are approximate, not to scale. This floor plan is for illustrative purposes only.

GIRAFFE360



Agents' Notes

These particulars do not constitute an offer or a contract neither do they form part of an offer or contract. The vendor does not make or give and Messrs. John German nor any person employed has any authority to make or give any representation or warranty, written or oral, in relation to this property. Whilst we endeavour to make our sales details accurate and reliable, if there is any point which is of particular importance to you, please contact the office and we will be pleased to check the information for you, particularly if contemplating travelling some distance to view the property. None of the services or appliances to the property have been tested and any prospective purchasers should satisfy themselves as to their adequacy prior to committing themselves to purchase.

Referral Fees

Mortgage Services - We routinely refer all clients to APR Money Limited. It is your decision whether you choose to deal with APR Money Limited. In making that decision, you should know that we receive on average £60 per referral from APR Money Limited.

Conveyancing Services - If we refer clients to recommended conveyancers, it is your decision whether you choose to deal with this conveyancer. In making that decision, you should know that we receive on average £150 per referral.

Survey Services - If we refer clients to recommended surveyors, it is your decision whether you choose to deal with this surveyor. In making that decision, you should know that we receive up to £90 per referral.

The property information provided by John German Estate Agents Ltd is based on enquiries made of the vendor and from information available in the public domain. If there is any point on which you require further clarification, please contact the office and we will be pleased to check the information for you, particularly if contemplating travelling some distance to view the property. Please note if your enquiry is of a legal or structural nature, we advise you to seek advice from a qualified professional in their relevant field.

AWAITING EPC MEDIA



John German

63a Market Street, Ashby-De-La-Zouch, Leicestershire, LE65 1AH

01530 412824

ashbysales@johngerman.co.uk

Ashbourne | Ashby de la Zouch | Barton under Needwood
Burton upon Trent | Derby | East Leake | Lichfield
Loughborough | Stafford | Uttoxeter

JohnGerman.co.uk Sales and Lettings Agent



