

72a St. Leonards Road, Hove BN3 4QS

Offers in Excess of £400,000

- TWO BEDROOMS
- WEST FACING GARDEN
- MODERN KITCHEN
- LIVING ROOM
- SECOND RECEPTION ROOM
- CONTEMPORARY BATHROOM
- PRIVATE STREET ENTRANCE
- SHARE OF FREEHOLD

Whitlock and Heaps are delighted to bring to market this excellent ground floor apartment that is brought to market in excellent condition throughout with a contemporary kitchen and bathroom. The versatile accommodation also includes two separate reception rooms and two bedrooms. Being sold with a share in the freehold and featuring a delightful west facing rear garden.

Situated on this desirable tree lined road within a short walk of Portslade mainline station and the seafront.

PRIVATE STREET ENTRANCE

ENTRANCE HALL Radiator, engineered wood floor

KITCHEN Incorporating sink unit with drainer and mixer tap, adjacent wooden worksurface with drawers and cupboards under, matching eye-level wall cupboards, inset four-ring induction hob with concealed extractor over, oven, appliance space, cupboard housing 'Worcester' gas-fired boiler, UPVC double glazed window, tiled splashback.

LIVING ROOM Log burner with tiled hearth, fitted cupboards and shelving in alcoves, UPVC double glazed bay windows, radiator, engineered wood flooring, coving and ceiling rose.

BEDROOM 1 UPVC double glazed window, radiator, coving and ceiling rose.

BEDROOM 2 UPVC double glazed window, radiator.

BATHROOM White suite comprising tiled panelled bath with mixer tap and separate shower over, folding glazed shower screen, wash-hand basin, low level w.c., fitted cupboards, UPVC double glazed window, radiator, tiled walls.

LOWER GROUND LEVEL

RECEPTION ROOM 2 Two UPVC double glazed windows, fitted wardrobes, radiator, fitted cupboard.

OUTSIDE

WEST FACING GARDEN Mainly laid to lawn with paved patio, shed.

OUTGOINGS Share of freehold
Maintenance: Adhoc basis.
Lease: 104 years remaining.

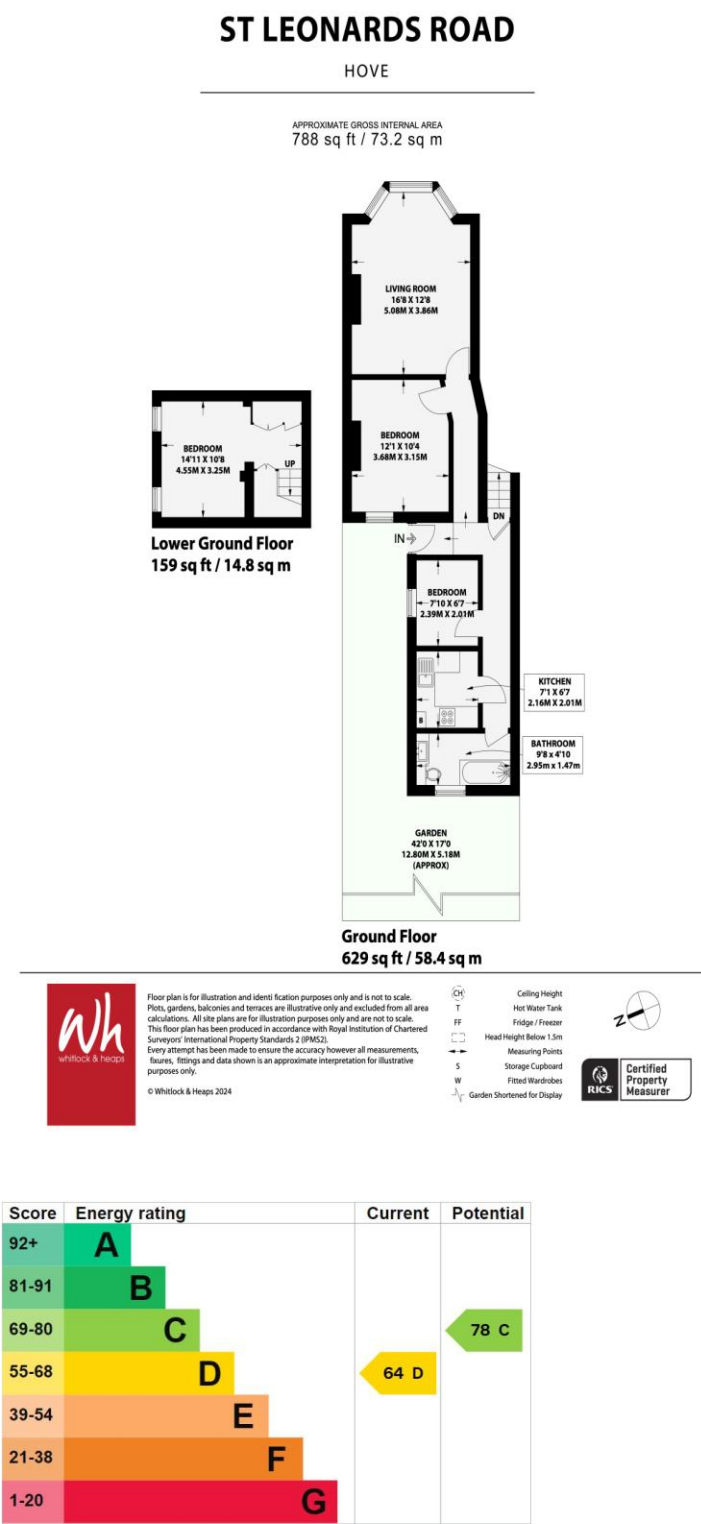

Portslade Branch
48 Boundary Road, Portslade BN3 4EF
portslade@whitlockandheaps.co.uk
01273 422706

Hove Branch
65 Sackville Road, Hove BN3 3WE
hove@whitlockandheaps.co.uk
01273 778577



Disclaimer: Whitlock & Heaps have produced these particulars in good faith and they are set out as a general guide. Accuracy is not guaranteed, nor do they form part of any contract. If there is any particular aspect of these details which you require any confirmation, please do contact us, especially if contemplating a long journey. All measurements are approximate. Fixtures and fittings, other than those mentioned above, to be agreed with the seller. Any services, systems or appliances at the property have not been tested.