



Flat 28, The Maltings Henty Gardens, Chichester

Guide Price £120,000



Henry Adams
estate agents

Flat 28

The Maltings Henty Gardens, Chichester

Presenting this 1 bedroom apartment, conveniently nestled in close proximity to the city centre and a host of local amenities. Boasting a prime location, this property offers unparalleled ease of access to all essential conveniences and is ideal for those seeking a vibrant urban lifestyle.

This apartment features a sitting/dining room which flows into the kitchen. The bedroom provides a peaceful retreat, and the property benefits from access to a communal garden.

Additional perks of this residence include access to a communal lift for added convenience and ease of mobility. With vacant possession on offer, this property provides a rare opportunity for a discerning buyer to make their mark and create a personal haven in the heart of the city.

Council Tax band: C

Tenure: Leasehold

EPC Energy Efficiency Rating: B

EPC Environmental Impact Rating: C

- CLOSE TO CITY CENTRE
- CLOSE TO LOCAL AMENITIES
- COMMUNAL GARDEN
- COMMUNAL LIFT
- VACANT POSSESSION



The Maltings, PO19 3DW

Approximate Gross Internal Area = 43.5 sq m / 468 sq ft

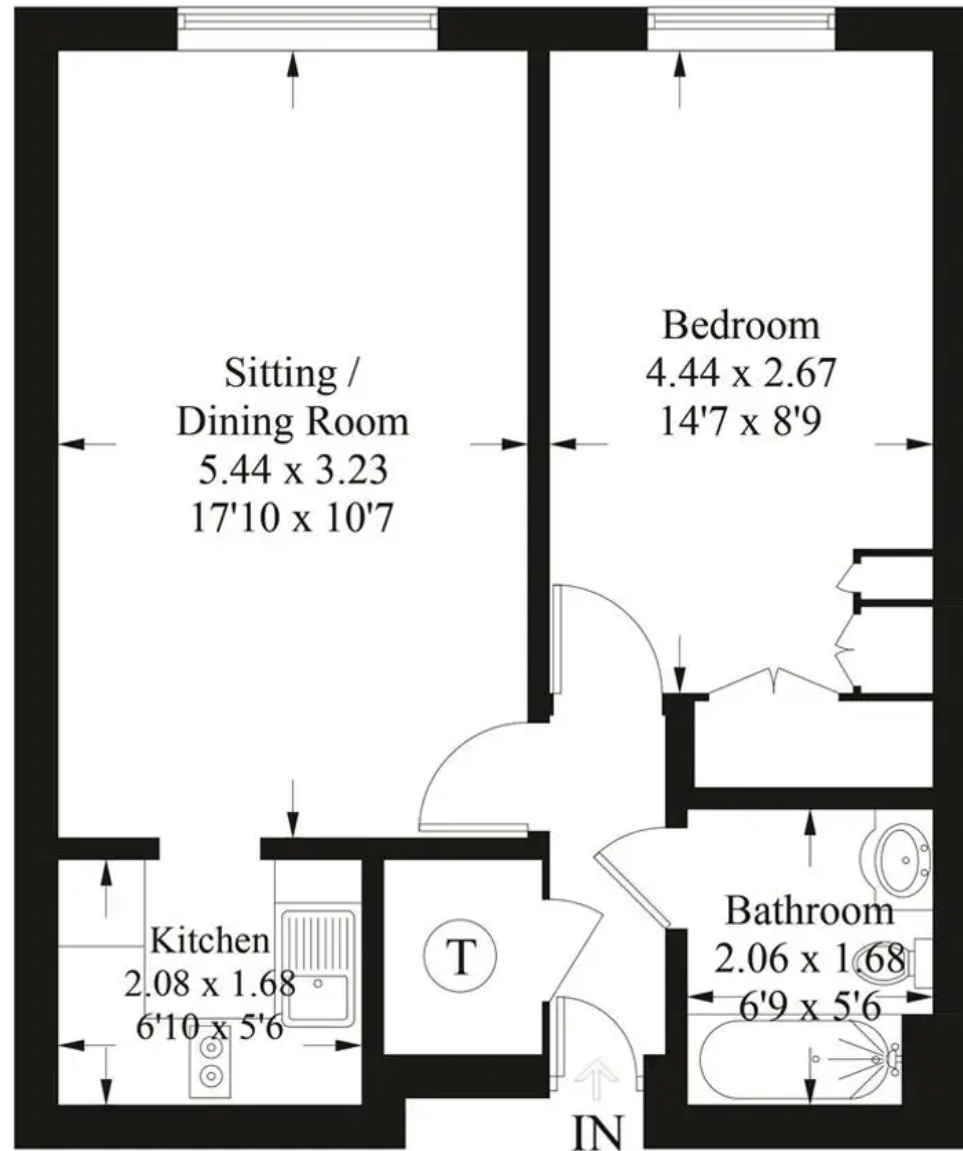

These plans are for illustration purposes only as defined by RICS - Code of Measuring Practice.
Not to scale. Created by Emzo Marketing



Henry Adams – East Wittering

Henry Adams LLP, 14 Shore Road, East Wittering – PO20 8DZ

01243 672721

eastwittering@henryadams.co.uk

www.henryadams.co.uk/

Agents Note – Our particulars are for guidance only and are intended to give a fair overall summary of the property. They do not form part of any contract or offer, and should not be relied upon as a statement or representation of fact. Measurements, areas and distances are approximate only. Photographs may include lifestyle shots and pictures of local views. No undertaking is given as to the structural condition of the property, or any necessary consents or the operating ability or efficiency of any service, system or appliance. Please ask if you would like further information, especially before you travel to the property.