



Cotswold Way, Worcester Park

Worcester Park

In Excess of £270,000

Cotswold Way, Worcester Park

- Double Glazing Throughout
- Great for Investors
- One Bedroom
- First Floor Apartment
- Ideal for First Time Buyers

Kaybridge Residential are pleased to bring to market this well presented, first floor, purpose built flat which has been well looked after by its current owner. As you make your way in to the flat you enter the welcoming entrance hall which leads to all rooms in the property. First you will find the double bedroom which has built in wardrobes. As you make your way further in to the property you will find the bathroom with shower over that has recently been modernised. Then towards the rear of the property you are led in to the living / dining room which is a great space with plenty of natural light from the dual aspect windows. This then leads you on to the kitchen which offers plenty of cupboard space and all you need to cook for friends and family. In addition to this the property benefits from having double glazing throughout and an allocated parking space. This is a great property for first time buyers and investors alike.





Cotswold Way, Worcester Park

Kaybridge Residential are pleased to bring to market this well presented, first floor, purpose built flat which has been well looked after.

To book a viewing please call 0208 0040 474

Cotswold Way, Worcester Park, KT4

Approximate Area = 447 sq ft / 41.5 sq m

For identification only - Not to scale

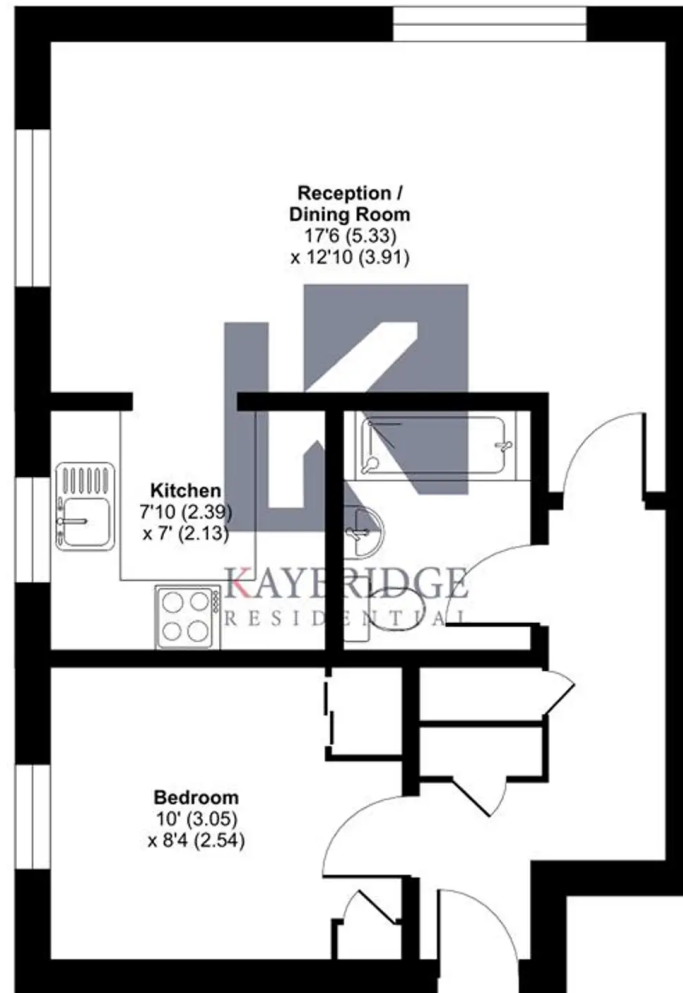

FIRST FLOOR



Floor plan produced in accordance with RICS Property Measurement Standards incorporating International Property Measurement Standards (IPMS2 Residential). © nichecom 2022. Produced for Kaybridge Residential Ltd. REF: 888253



Kaybridge Residential Epsom

Kaybridge Residential Estate Agents, 23 Stoneleigh Broadway - KT17 2JE

02080040474 • info@kbridge.co.uk • www.kaybridgeresidential.co.uk/