



## Flat 7, Marine Court Jones Lane, Hythe – SO45 6GL

£225,000 Leasehold

Nestled in a prime location on the outskirts of Hythe Village, this well-presented first-floor apartment boasts a convenient setting just a short walk from the waterfront and local amenities. The property comprises two bedrooms, a bathroom, a kitchen, and a dual-aspect lounge/dining room. Further features internally include gas central heating, double glazing, and neutral decoration. Outside, the apartment has an allocated parking space within a courtyard, as well as access to communal gardens. We strongly advise an internal viewing.

## GROUND FLOOR

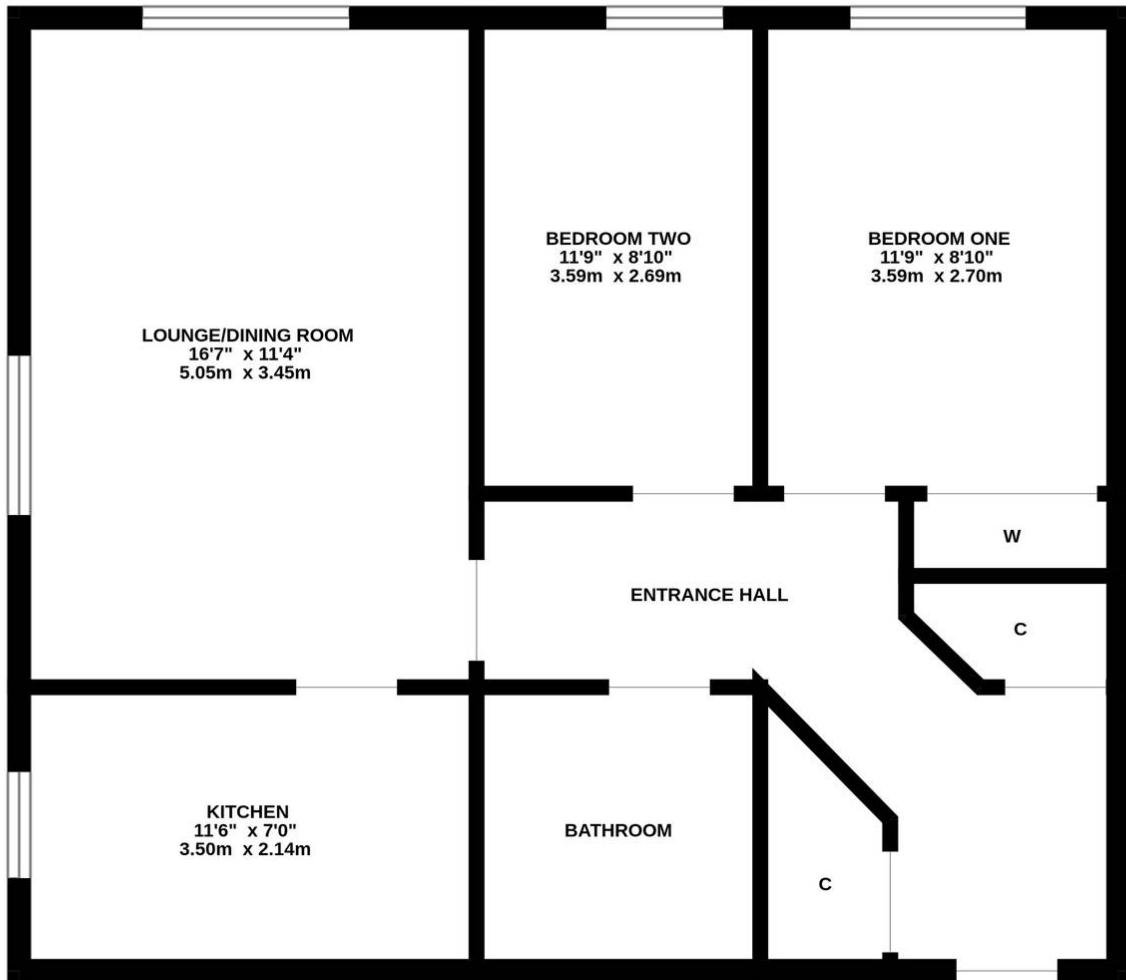

Whilst every attempt has been made to ensure the accuracy of the floorplan contained here, measurements of doors, windows, rooms and any other items are approximate and no responsibility is taken for any error, omission or mis-statement. This plan is for illustrative purposes only and should be used as such by any prospective purchaser. The services, systems and appliances shown have not been tested and no guarantee as to their operability or efficiency can be given.

Made with Metropix ©2024

You can include any text here. The text can be modified upon generating your brochure.



**1 Southward House**  
Dibden Purlieu SO45 4PT



**T: 02380 844405**  
info@anthonyjamesproperties.co.uk