



LOVETT
Sales & Lettings

£279,000



23 Linton Close, Eaton Socon, St. Neots, PE19 8GY

- End of terraced Town House
- Four bedrooms
- Ensuite to main bedroom
- Refitted kitchen
- Pre/Primary Schools nearby
- South facing rear garden

Full Description

A spacious four bedroom end of terrace town house in a popular area of Eaton Socon, with easy reach of the A1/A428 and local shops and amenities. The accommodation over three floors comprises WC, kitchen and lounge/diner on the ground floor. On the first floor there are bedrooms two, four and a family bathroom. The second floor has a 17ft master bedroom with en-suite and bedroom three. The property benefits from gas radiator heating and UPVC windows and doors throughout. Externally there is a South-facing rear garden and an allocated parking space.

ENTRANCE HALL

Composite entrance door leading to entrance hall. Stairs to first floor with cupboard under. Radiator. Doors to WC, kitchen and lounge/diner. Wood laminate flooring. Smoke alarm.

KITCHEN

16' 1" x 6' 1" (4.9m x 1.85m)

Refitted kitchen comprising work surfaces with drawers and cupboards under. Wall mounted cupboards. Single bowl sink with mixer tap and tiled splash backs. Built in electric oven and four ring gas hob with extractor fan over. Plumbing for washing machine and dishwasher. Cupboard housing gas boiler. Radiator. UPVC window to front.

LOUNGE/DINER

14' 5" x 13' 0" (4.39m x 3.96m)

UPVC French doors and windows to rear garden. TV and telephone point. Two radiators. Wood laminate flooring.

FIRST FLOOR LANDING

UPVC window to front. Radiator. Stairs to first floor. Doors to bedrooms two, four and family bathroom.

BEDROOM TWO

13' 0" x 11' 2" (3.96m x 3.4m)

Two UPVC windows to rear. Radiator. Fitted wardrobes.

BEDROOM FOUR

11' 0" x 6' 3" (3.35m x 1.91m)

UPVC window to front. Radiator.

BATHROOM

Three piece suite comprising low level WC, pedestal wash hand basin and panelled bath with shower attachment over. Tiled splash backs. Radiator. Extractor fan.



SECOND FLOOR LANDING

Airing cupboard. Smoke alarm. Doors to bedroom one and three.

BEDROOM ONE

17' 6" x 13' 0" (5.33m x 3.96m)

UPVC French doors with Juliet balcony to rear. Radiator. Fitted wardrobes and drawers. Radiator. Door to ensuite.

ENSUITE

Three piece white suite comprising low level WC, pedestal wash hand basin and fitted shower with glass door and tiled splash backs. Radiator. Shaver socket. Extractor fan.

BEDROOM THREE

9' 5" x 8' 5" (2.87m x 2.57m)

UPVC French doors with Juliet balcony to front. Built in cupboard. Radiator.

REAR GARDEN

South facing rear garden. Gated access to rear.

PARKING

Allocated parking space.



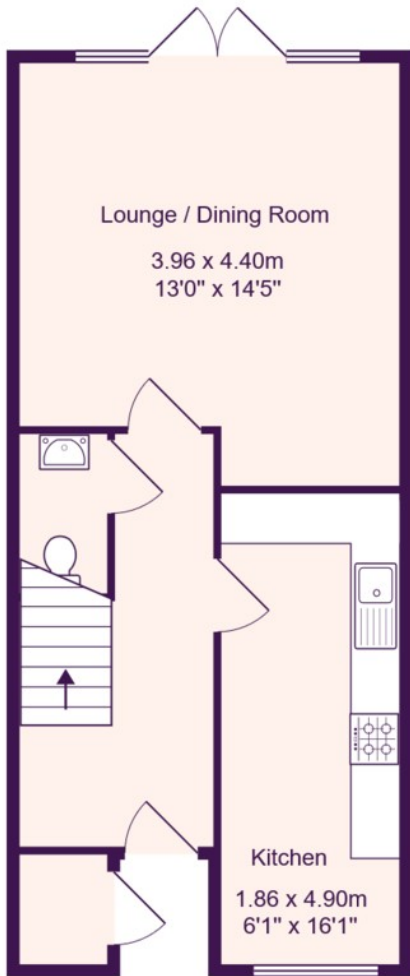

Ground Floor



First Floor

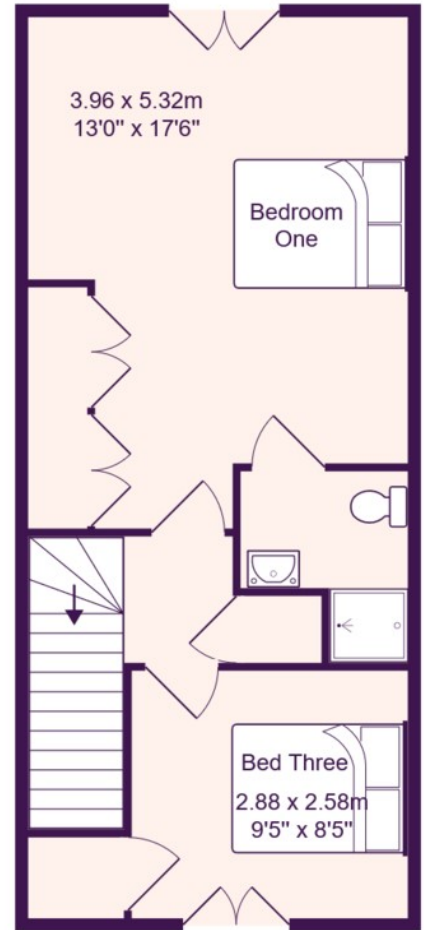

Second Floor

Total Area: 109.9 m² ... 1183 ft²

All measurements are approximate and for display purposes only