



## St. Lukes Court, Hatfield

£270,000 Leasehold

FIRST FLOOR APARTMENT • TWO DOUBLE BEDROOMS • SPACIOUS LIVING ROOM • KITCHEN WITH APPLIANCES • MODERN BATHROOM • ALLOCATED PARKING BAY • CLOSE TO STATION • LEASEHOLD • EPC RATING - C

**KINGS**  
SALES LETTINGS MANAGEMENT

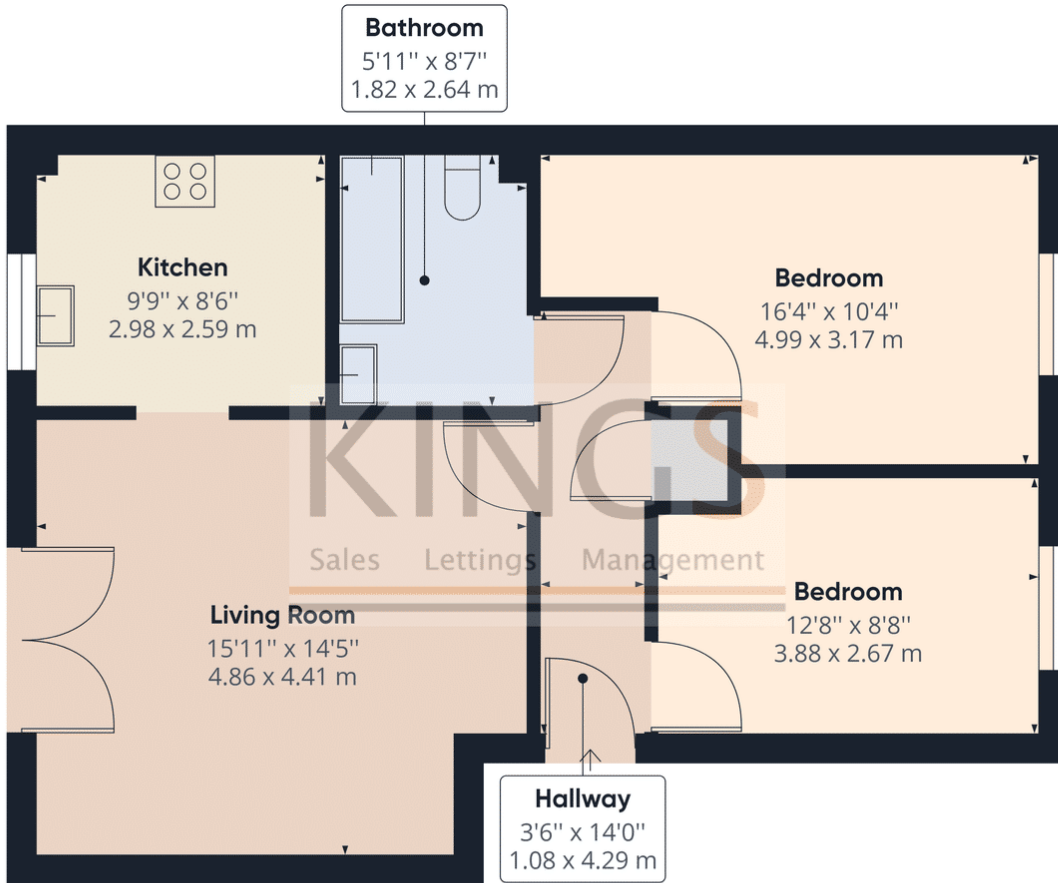

Approximate total area<sup>(1)</sup>  
683.83 ft<sup>2</sup>  
63.53 m<sup>2</sup>

(1) Excluding balconies and terraces

While every attempt has been made to ensure accuracy, all measurements are approximate, not to scale. This floor plan is for illustrative purposes only.

GIRAFFE360

You can include any text here. The text can be modified upon generating your brochure.

