



The Belvedere, Homerton Street

+44 (0) 1223 508050

[lettings@cookecurtis.co.uk](mailto:lettings@cookecurtis.co.uk)

[www.cookecurtis.co.uk](http://www.cookecurtis.co.uk)

A stunning, two-bedroom apartment on the seventh floor of a prestigious development in central Cambridge. With concierge service, on-site gym and a swimming pool along with allocated parking and convenient location for Cambridge train station, city centre, Addenbrookes and the Biomedical Campus.

£2,200 pcm

The Belvedere, Homerton  
Street, CB2 0NT



Spanning the whole seventh floor of the iconic Tower at The Belvedere, this spacious two bedroom apartment offers exceptional accommodation in Cambridge city centre. Built in 2006, the development has landscaped communal gardens with water features and concierge service along with a resident's only leisure suite comprising of an Ozone treated swimming pool, steam room, fully equipped gym and a Resident's Lounge which can be booked for private meetings, parties etc.

The apartment has been well maintained and has double glazing and underfloor heating throughout. There is a spacious entrance hall with marble flooring and to the left a family bathroom with white modern white suite including a bath with shower over and dark wood storage cupboard.



Both bedrooms are generous doubles and both have built-in wardrobes. The master benefits from an attractive en-suite shower room while the second bedroom has a fitted bed that can be folded away.

The main room of the apartment is a spacious, open-plan living space with ample room for relaxing and dining, with the added feature of a balcony and panoramic views of the city. There is a contemporary kitchen with high gloss units and designer block polished granite worktop, there is an integrated fridge freezer, microwave, oven and hob, washer dryer, dishwasher and striking Kuppertsbusch extractor fan over.

Entrance to the development and leisure suite is by residents fob only and there is a manned reception at the Homerton Street entrance making the building very secure and peaceful. There is lift access to the apartment and





102 sqm / 1104 sqft

---

2 bed, 2 bath, 1 recep

---

Council tax band - F

---

EPC - C / 78

---

Underfloor electric heating

---

Secure, allocated parking

---

Balcony

---

Available August 2024

---



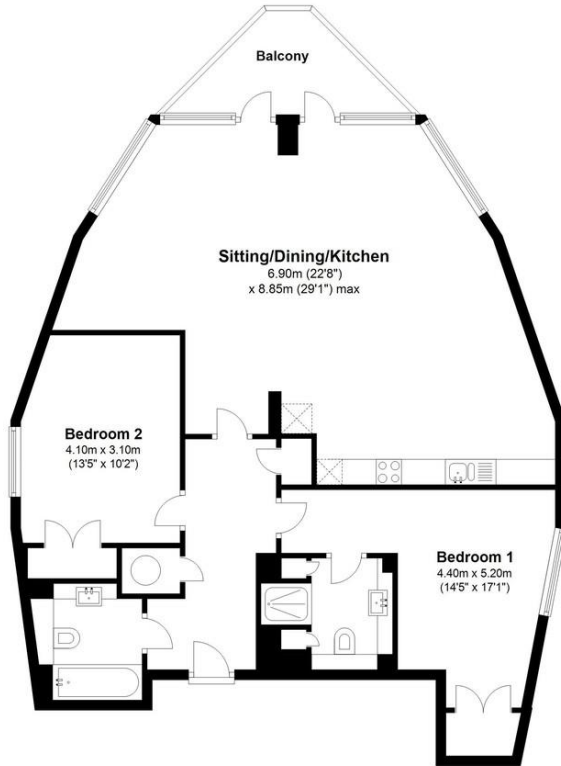

**Seventh Floor**

Approx. 102.7 sq. metres (1104.9 sq. feet)

Total area: approx. 102.7 sq. metres (1104.9 sq. feet)



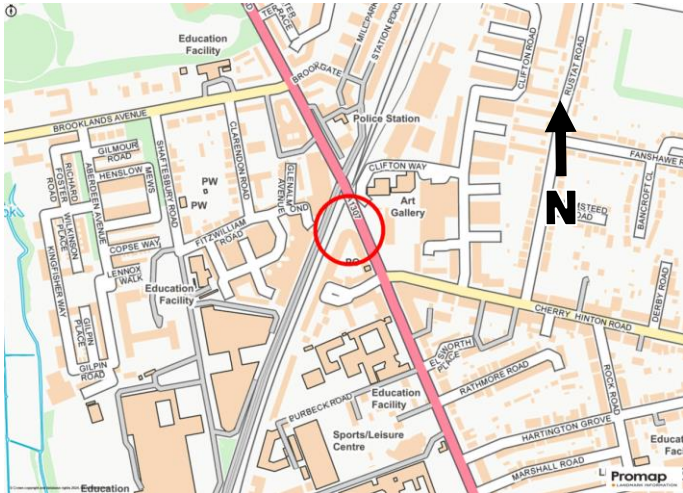

The Belvedere is a prestigious building located on Homerton Street in the southern edge of the city centre. Convenient for commuters as it sits only 0.5 miles from Cambridge Train Station with regular trains to London taking under an hour to reach the capital. Addenbrooke's Hospital and the Biomedical Campus is 1 mile away and there is access out to junction 11 of the M11 approx. 3 miles away. There is an excellent range of facilities in the locality, including banks, lunch time eateries, a post office and small supermarkets along with the cinema and leisure complex adjacent to the building. There are also several public houses and restaurant on the near by Hills Road including the acclaimed three rosette gourmet continental restaurant Alimentum.

COOKE  
CURTIS  
& CO